

DATE REVISED	DATE REVISED	FED. RD. DIST. NO.	STATE	FED. AID PROJ. NO.	SHEET NO.	TOTAL SHEETS
07-24-2024		6	ARK.			
				JOB NO. 101120	19	61

② MAINTENANCE OF TRAFFIC DETAILS

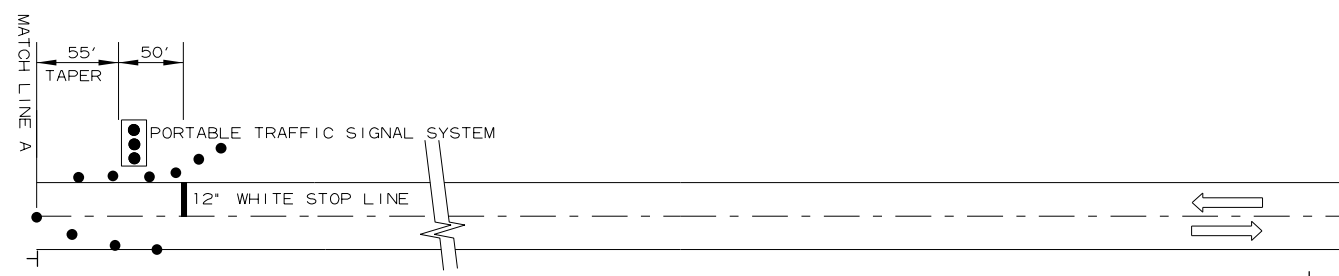

L.L.
(2) G20-2 (2) R2-12
(36" X 18") (24" X 36")
END ROAD WORK
END WORK ZONE SPEED LIMIT

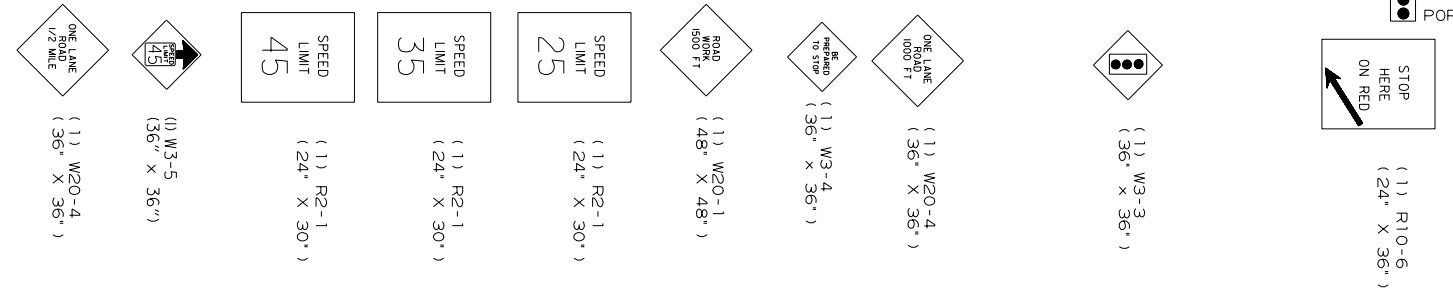
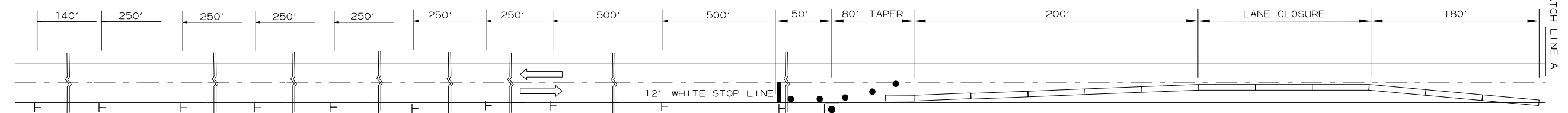

FURNISH AND INSTALL TEMP. PRECAST BARRIER
INCLUDES (1) TEMPORARY IMPACT ATTENUATION BARRIER
LANE CLOSURE WITH PORTABLE TRAFFIC SIGNAL SYSTEM &
PRECAST CONCRETE BARRIER WALL
(STAGES 1 & 2)
(SHOW IN DIRECTION OF TRAFFIC)

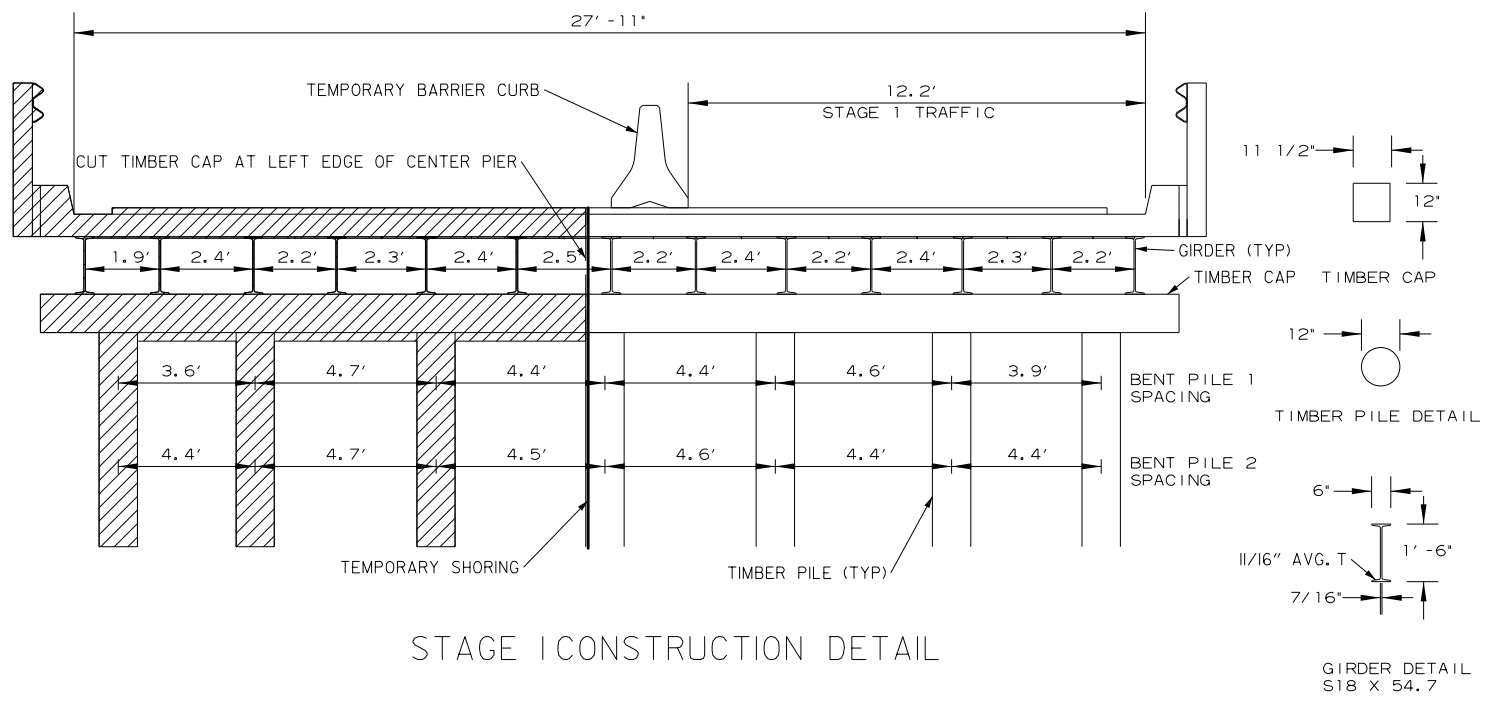

STAGE 1 CONSTRUCTION DETAIL

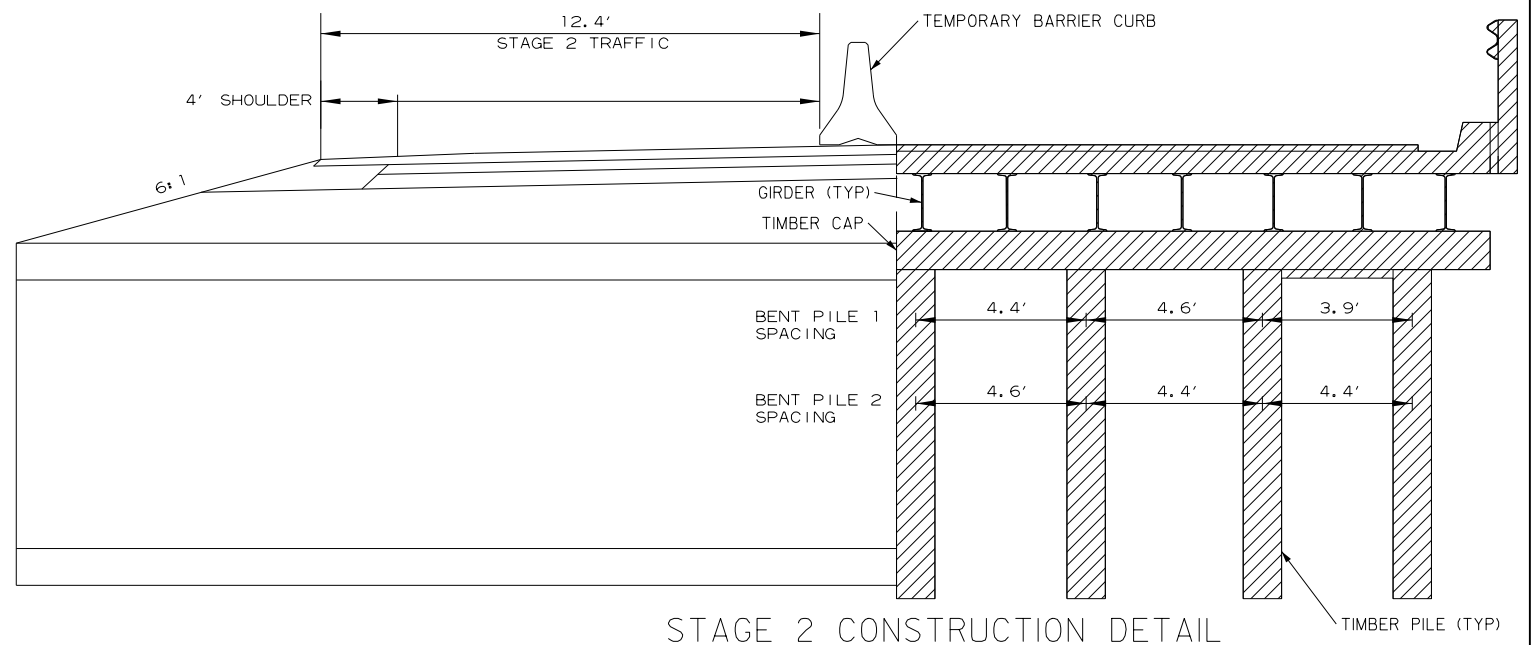

STAGE 2 CONSTRUCTION DETAIL

ADVANCED WARNING
MAINTENANCE OF TRAFFIC DETAILS

DATE REVISED	DATE REVISED	FED. ROAD DIST. NO.	STATE	FED. AID PROJ. NO.	SHEET NO.	TOTAL SHEETS
7/24/24		6	ARK.			
		JOB NO.		101120	28	61
07681 - QUANTITIES - 67334						

SCHEDULE OF BRIDGE QUANTITIES - JOB NO. 101120

BRIDGE NO.	NAME PLATE TITLE	UNIT OF STRUCTURE	ITEM NO.	205	801	SP, SS, & 802	SP, SS, & 802	SP & 803	SS & 804	SS & 804	SS & 805	SS & 805	SS & 805	SS & 805	SP, SS, & 807	SS & 807	812	SS & 816	SS & 816	
			ITEM	REMOVAL OF EXISTING BRIDGE STRUCTURE (SITE NO.)	UNCLASSIFIED EXCAVATION FOR STRUCTURES - BRIDGE	CLASS S CONCRETE - BRIDGE	CLASS S(AE) CONCRETE - BRIDGE	CLASS 2 PROTECTIVE SURFACE TREATMENT	REINFORCING STEEL - BRIDGE (GRADE 60)	EPOXY COATED REINFORCING STEEL (GRADE 60)	STEEL SHELL PILING (16" DIAMETER)	STEEL SHELL PILING (20" DIAMETER)	PILE ENCASEMENT	PREBORING	STRUCTURAL STEEL IN BEAM SPANS (A709, GR. 50W)	PAINTING STRUCTURAL STEEL	BRIDGE NAME PLATE (TYPE D)	DUMPED RIPRAP	FILTER BLANKET	
			UNIT	LUMP SUM	CUBIC YARD	CUBIC YARD	CUBIC YARD	SQUARE YARD	POUND	POUND	LINEAR FOOT	LINEAR FOOT	LINEAR FOOT	LINEAR FOOT	POUND	TON	EACH	CUBIC YARD	SQUARE YARD	
07681	HIGHWAY 141 OVER DITCH NO. 8	END BENT NO. 1		97	13.74				1,940	550	200		40					258	516	
		INTERMEDIATE BENT NO. 2			15.43				2,300	610		375	70							
		INTERMEDIATE BENT NO. 3			15.43				2,300	610		375	70							
		END BENT NO. 4		73	13.74				1,940	550	200		40					211	421	
		105'-0" CONTINUOUS COMP. W-BEAM UNIT SITE NO. 2 (BRIDGE NO. 07681)	1			151.5	457.2			36,310				41,340	4.9	1				
TOTALS FOR BRIDGE NO. 07681				170	58.3	151.5	457.2	8,480	38,630	400	750	140	80	41,340	4.9	1	469	937		
① SITE NO. 1 (STA. 105+45.92)			1																	
TOTALS FOR JOB NO. 101120			1	170	58.3	151.5	457.2	8,480	38,630	400	750	140	80	41,340	4.9	1	469	937		

① Existing Bridge No. M3564 is 29.6' wide (27.9' clear roadway) and 42.0' long and consists of steel I-beam spans (1 span total) supported by timber pile bents.
 This bridge shall be removed in accordance with Section 205. All remaining material from the existing bridge shall become property of the Contractor.

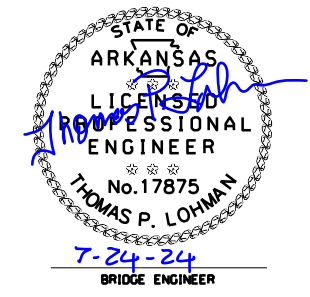

**SCHEDULE OF BRIDGE QUANTITIES
 HWY. 141 STRS. & APPRS. (S)**

**CLAY COUNTY
 ROUTE 141 SEC. 5
 ARKANSAS STATE HIGHWAY COMMISSION
 LITTLE ROCK, ARK.**

DRAWN BY: UVK DATE: OCT 2023 FILENAME: bi01120.qldgn
 CHECKED BY: MAC DATE: FEB 2024 SCALE: NONE
 DESIGNED BY: SR DATE: OCT 2023
 BRIDGE NO. 07681 DRAWING NO. 67334

PRINT DATE: 7/25/2024

SUMMARY OF QUANTITIES

ITEM NUMBER	ITEM	QUANTITY	UNIT
201	CLEARING	20	STATION
201	GRUBBING	20	STATION
202	REMOVAL AND DISPOSAL OF PIPE CULVERTS	2	EACH
SP, SS, & 210	UNCLASSIFIED EXCAVATION	7057	CU. YD.
SP & 210	COMPACTED EMBANKMENT	12243	CU. YD.
SP & 210	SOIL STABILIZATION	50	TON
SP, SS, & 303	AGGREGATE BASE COURSE (CLASS 7)	3980	TON
SS & 401	TACK COAT	1250	GAL.
SP, SS, & 406	MINERAL AGGREGATE IN ACHM BINDER COURSE (1")	1013	TON
SP, SS, & 406	ASPHALT BINDER (PG 70-22) IN ACHM BINDER COURSE (1")	42	TON
SP, SS, & 407	MINERAL AGGREGATE IN ACHM SURFACE COURSE (1/2")	1543	TON
SP, SS, & 407	ASPHALT BINDER (PG 64-22) IN ACHM SURFACE COURSE (1/2")	2	TON
SP, SS, & 407	ASPHALT BINDER (PG 70-22) IN ACHM SURFACE COURSE (1/2")	90	TON
SP & 412	COLD MILLING ASPHALT PAVEMENT	667	SQ. YD.
SP, SS, & 414	ASPHALT CONCRETE PATCHING FOR MAINTENANCE OF TRAFFIC	10	TON
SP, SS, & 504	APPROACH SLABS	102.68	CU. YD.
SP, SS, & 504	APPROACH GUTTERS	16.76	CU. YD.
601	MOBILIZATION	1.00	LUMP SUM
SP & 602	FURNISHING FIELD OFFICE	1	EACH
SS & 603	MAINTENANCE OF TRAFFIC	1.00	LUMP SUM
603	18" TEMPORARY CULVERT	62	LIN. FT.
SS & 604	SIGNS	380	SQ. FT.
SS & 604	BARRICADES	32	LIN. FT.
SS & 604	TRAFFIC DRUMS	58	EACH
SS & 604	FURNISHING AND INSTALLING PRECAST CONCRETE BARRIER	680	LIN. FT.
SS & 604	RELOCATING PRECAST CONCRETE BARRIER	680	LIN. FT.
604	CONSTRUCTION PAVEMENT MARKINGS	8122	LIN. FT.
604	REMOVAL OF PERMANENT PAVEMENT MARKINGS	1555	LIN. FT.
SS & 604	VERTICAL PANELS	11	EACH
SS & 606	36" X 23" REINFORCED CONCRETE ARCH PIPE CULVERTS (CLASS IV)	248	LIN. FT.
SP, SS, & 606	18" SIDE DRAIN	50	LIN. FT.
SS & 606	36" X 23" FLARED END SECTIONS FOR REINFORCED CONCRETE ARCH PIPE CULVERTS	4	EACH
SS & 606	SELECTED PIPE BEDDING	20	CU. YD.
SS & 611	4" PIPE UNDERDRAINS	1000	LIN. FT.
SS & 611	UNDERDRAIN OUTLET PROTECTORS	4	EACH
SS & 615	PAVEMENT REPAIR OVER CULVERTS (ASPHALT)	15	TON
620	LIME	15	TON
620	SEEDING	7.54	TON
SS & 620	MULCH COVER	16.97	ACRE
620	WATER	962.0	M. GAL.
621	TEMPORARY SEEDING	9.43	ACRE
621	SILT FENCE	3149	LIN. FT.
621	SAND BAG DITCH CHECKS	374	BAG
621	SEDIMENT BASIN	133	CU. YD.
621	OBLITERATION OF SEDIMENT BASIN	263	CU. YD.
621	SEDIMENT REMOVAL AND DISPOSAL	49	CU. YD.
SS & 621	ROCK DITCH CHECKS	808	LIN. FT.
623	SECOND SEEDING APPLICATION	7.54	ACRE
624	SOLID SODDING	36	SQ. YD.
626	EROSION CONTROL MATTING (CLASS 3)	444	SQ. YD.
635	ROADWAY CONSTRUCTION CONTROL	1.00	LUMP SUM
SP	PORTABLE TRAFFIC SIGNAL SYSTEM-ACTUATED	10	WEEKS
718	REFLECTORIZED PAINT PAVEMENT MARKING WHITE (6")	5095	LIN. FT.
718	REFLECTORIZED PAINT PAVEMENT MARKING YELLOW (6")	4819	LIN. FT.
721	RAISED PAVEMENT MARKERS (TYPE II)	78	EACH
SS & 731	TEMPORARY IMPACT ATTENUATION BARRIER	1	EACH
SS & 731	TEMPORARY IMPACT ATTENUATION BARRIER (REPAIR)	2	EACH
SS & 731	TEMPORARY IMPACT ATTENUATION BARRIER (RELOCATION)	1	EACH
SS & 734	BRIDGE END TERMINAL	4	EACH
SS & 804	REINFORCING STEEL-ROADWAY (GRADE 60)	12916	POUND
STRUCTURES OVER 20' SPAN			
205	REMOVAL OF EXISTING BRIDGE STRUCTURE (SITE NO. 1)	1.00	LUMP SUM
205	REMOVAL OF EXISTING BRIDGE STRUCTURE (SITE NO. 2)	1.00	LUMP SUM
636	BRIDGE CONSTRUCTION CONTROL	1.00	LUMP SUM
801	UNCLASSIFIED EXCAVATION FOR STRUCTURES-BRIDGE	170	CU. YD.
801	UNCLASSIFIED EXCAVATION FOR STRUCTURES-ROADWAY	96	CU. YD.
SP, SS, & 802	CLASS 3 CONCRETE-ROADWAY	211.1	CU. YD.
SP, SS, & 802	CLASS 3 CONCRETE-BRIDGE	58.3	CU. YD.
SP, SS, & 802	CLASS 3(AE) CONCRETE-BRIDGE	151.5	CU. YD.
SP & 803	CLASS 2 PROTECTIVE SURFACE TREATMENT	457.2	SQ. YD.
SS & 804	REINFORCING STEEL-ROADWAY (GRADE 60)	27966	POUND
SS & 804	REINFORCING STEEL-BRIDGE (GRADE 60)	8480	POUND
SS & 804	EPOXY COATED REINFORCING STEEL (GRADE 60)	38630	POUND
SS & 805	STEEL SHELL PILING (16" DIAMETER)	400	LIN. FT.
SS & 805	STEEL SHELL PILING (20" DIAMETER)	750	LIN. FT.
SS & 805	PREBORING	80	LIN. FT.
SS & 805	PILE ENCASEMENT	140	LIN. FT.
SP, SS, & 807	STRUCTURAL STEEL IN PLATE GIRDER SPANS (A709, GR. 50W)	41340	POUND
SS & 807	PAINTING STRUCTURAL STEEL	4.9	TON
812	BRIDGE NAME PLATE (TYPE D)	1	EACH
SS & 816	FILTER BLANKET	937	SQ. YD.
SS & 816	DUMPED RIPRAP	469	CU. YD.

REVISIONS

DATE	REVISION	SHEET NUMBER
07-24-2024	REVISED MAINTENANCE OF TRAFFIC DETAIL. REVISED SUMMARY OF QUANTITIES. RENUMBERED PLAN SHEETS 48 - 61.	19, 29, 48-61
07-24-2024	REVISED SCHEDULE OF BRIDGE QUANTITIES	28

DATE REVISED	DATE REVISED	FED. RD. DIST. NO.	STATE	FED. AID PROJ. NO.	SHEET NO.	TOTAL SHEETS
07-24-2024		6	ARK.		29	61
JOB NO.				101120	29	61

② SUMMARY OF QUANTITIES AND REVISIONS



DATE REVISED	DATE REVISED	FED. RD. DIST. NO.	STATE	FED. AID PROJ. NO.	SHEET NO.	TOTAL SHEETS
07-24-2024		6	ARK.			
		JOB NO.		101120	48	61

② CROSS SECTIONS

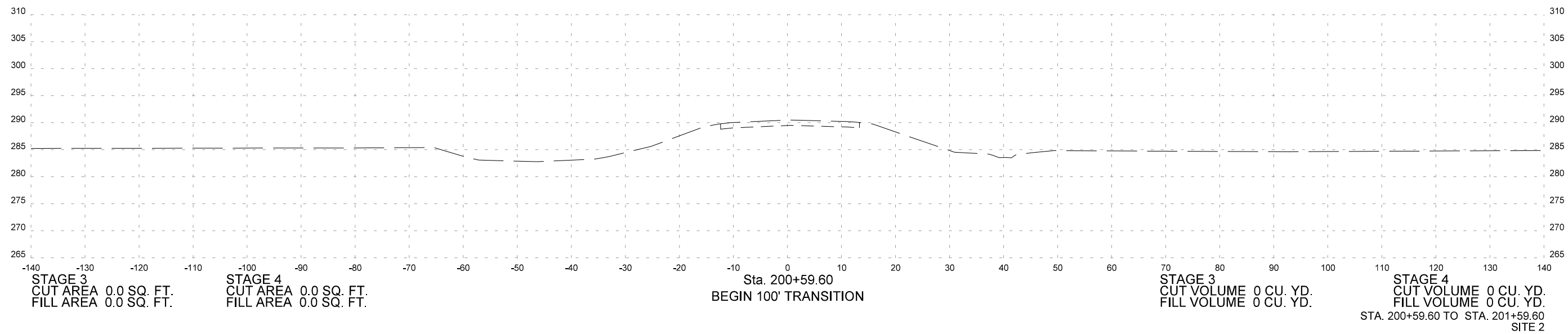
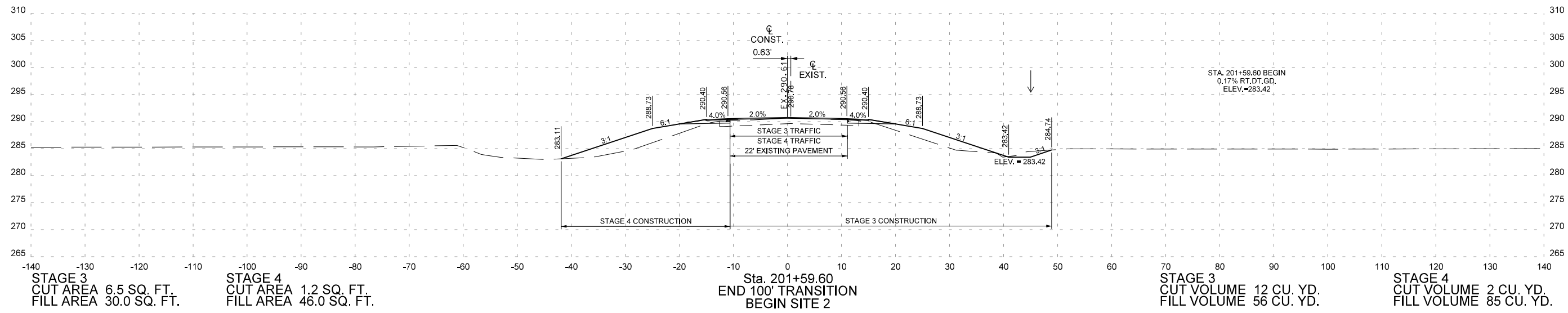

DATE REVISED	DATE REVISED	FED. RD. DIST. NO.	STATE	FED. AID PROJ. NO.	SHEET NO.	TOTAL SHEETS
07-24-2024		6	ARK.			
				JOB NO. 101120	49	61

② CROSS SECTIONS

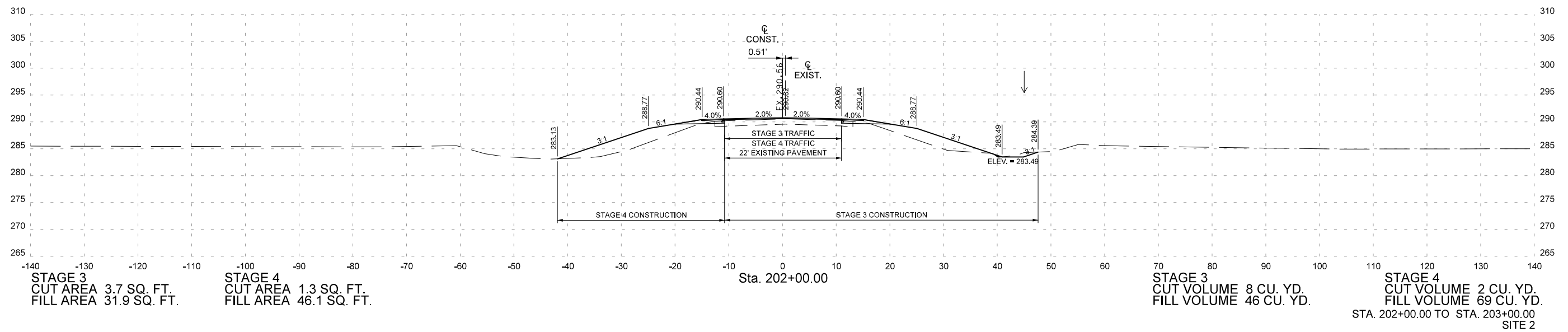
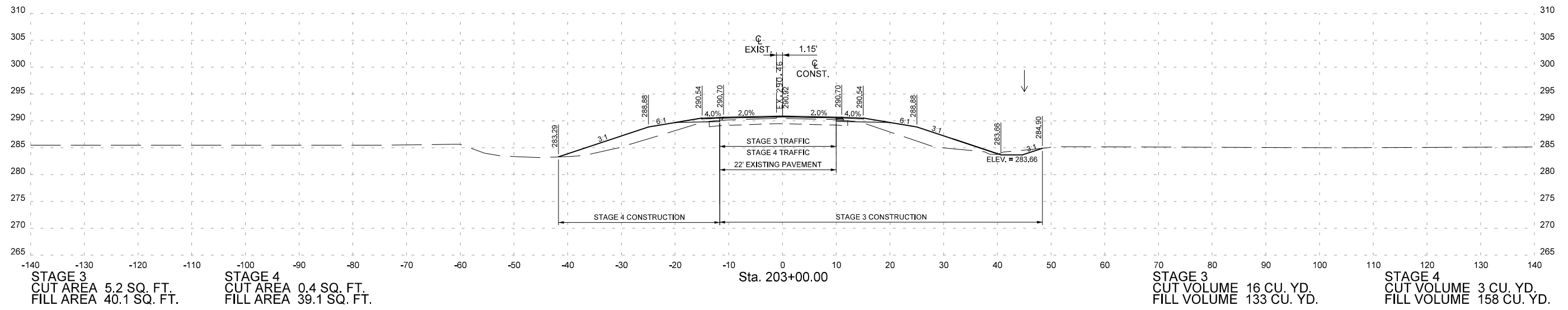

DATE REVISED	DATE REVISED	FED. RD. DIST. NO.	STATE	FED. AID PROJ. NO.	SHEET NO.	TOTAL SHEETS
07-24-2024		6	ARK.			
				JOB NO. 101120	50	61

② CROSS SECTIONS

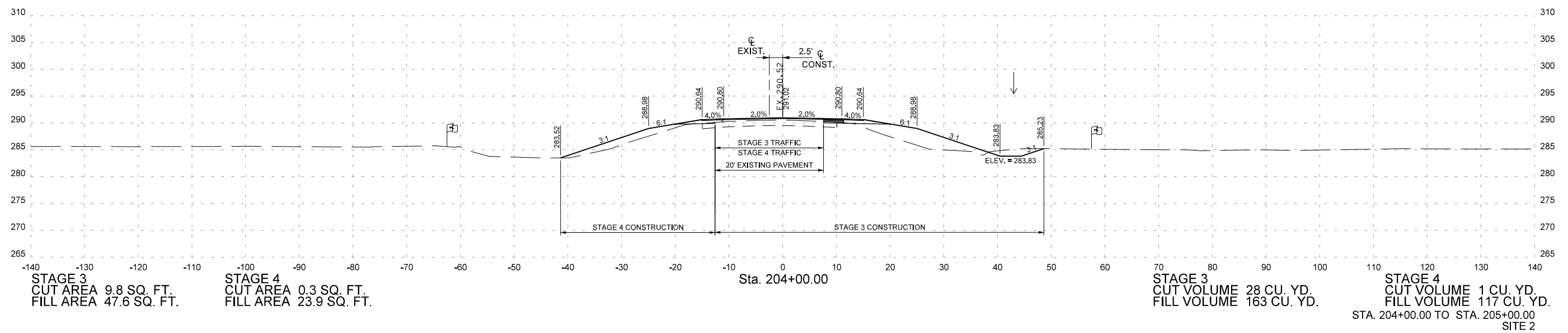
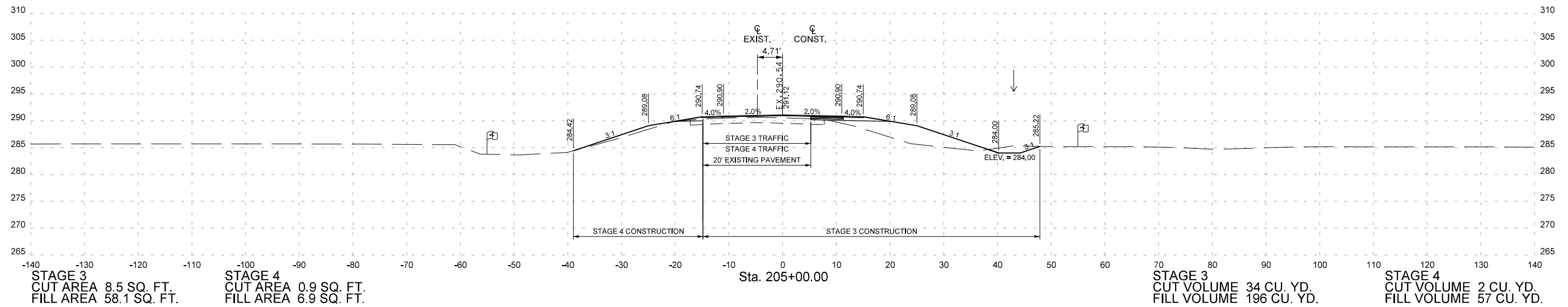

DATE REVISED	DATE REVISED	FED. RD. DIST. NO.	STATE	FED. AID PROJ. NO.	SHEET NO.	TOTAL SHEETS
07-24-2024		6	ARK.			
				JOB NO. 101120	51	61

② CROSS SECTIONS

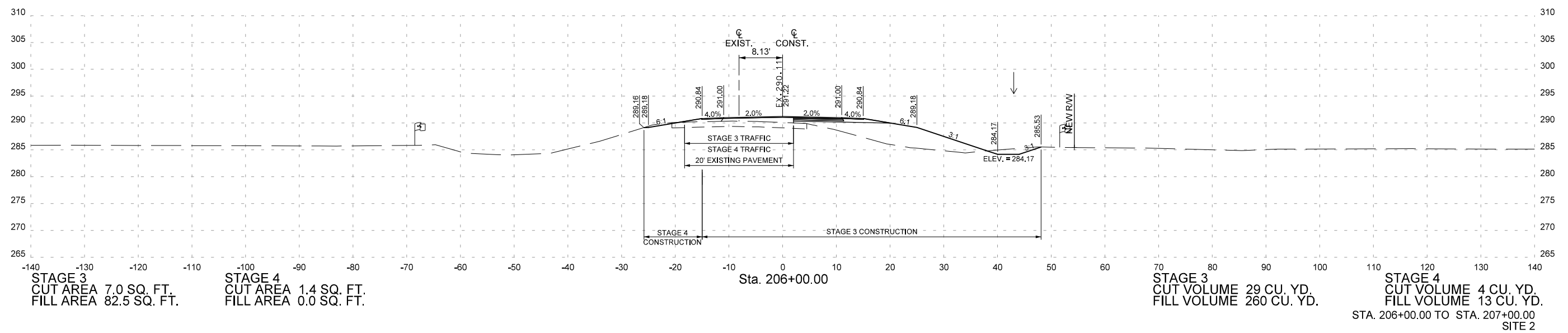
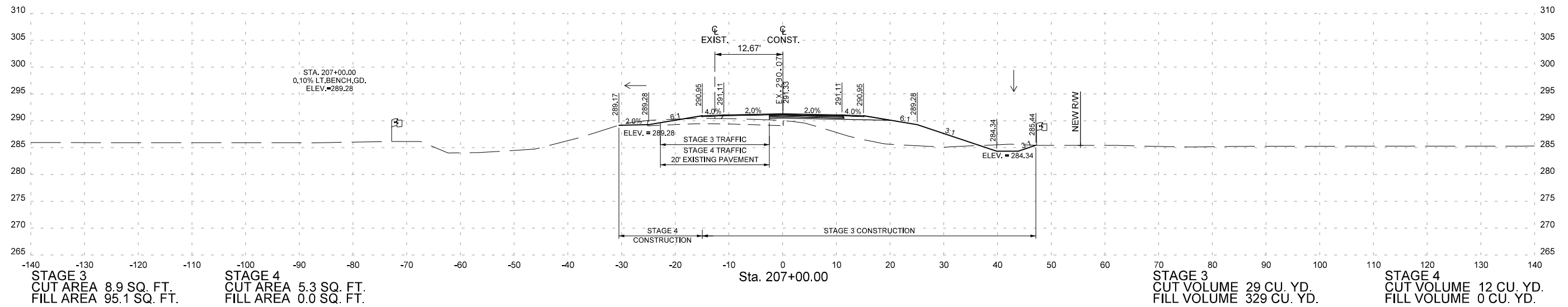

DATE REVISED	DATE REVISED	FED. RD. DIST. NO.	STATE	FED. AID PROJ. NO.	SHEET NO.	TOTAL SHEETS
07-24-2024		6	ARK.			
				JOB NO. 101120	52	61

② CROSS SECTIONS

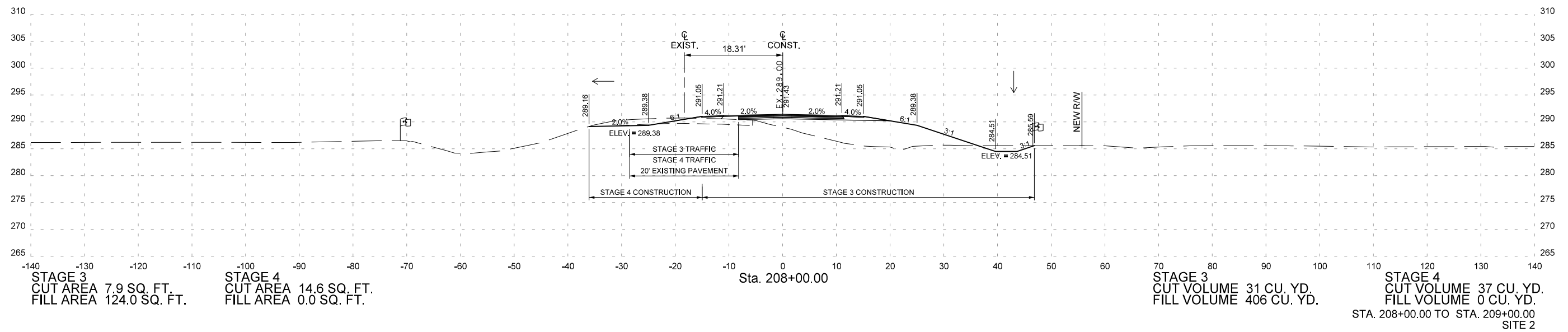
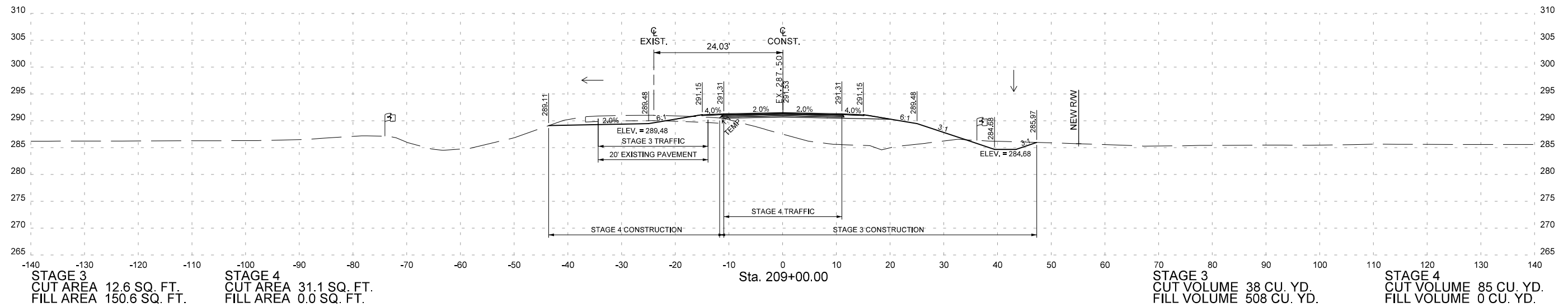

DATE REVISED	DATE REVISED	FED. RD. DIST. NO.	STATE	FED. AID PROJ. NO.	SHEET NO.	TOTAL SHEETS
07-24-2024		6	ARK.			
				JOB NO. 101120	53	61

② CROSS SECTIONS

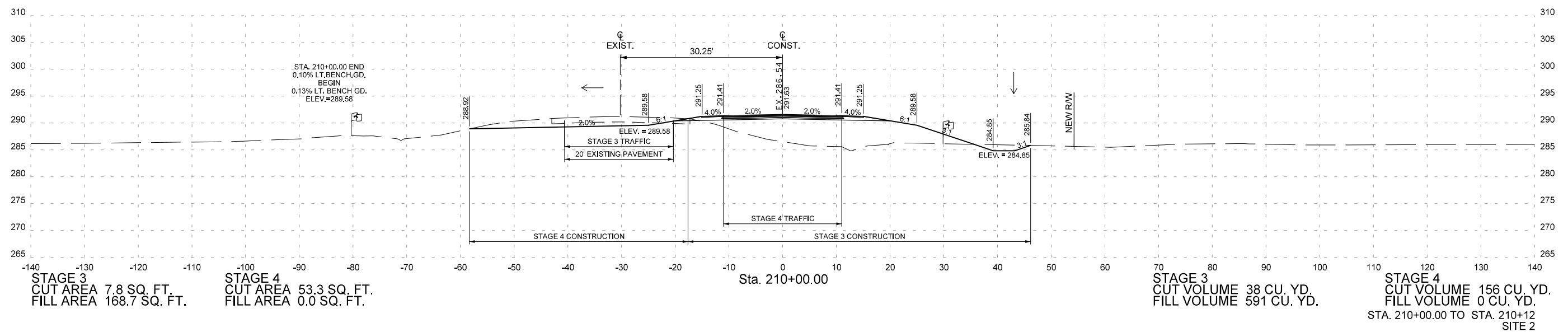
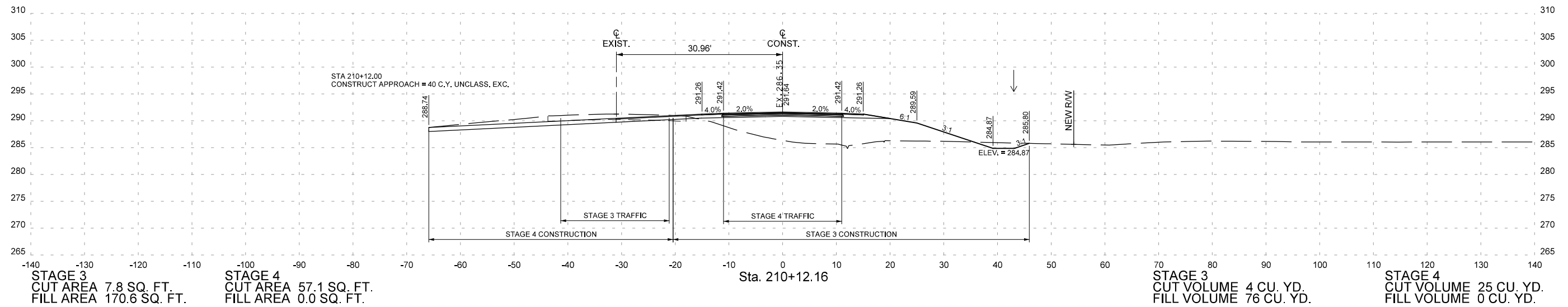

DATE REVISED	DATE REVISED	FED. RD. DIST. NO.	STATE	FED. AID PROJ. NO.	SHEET NO.	TOTAL SHEETS
07-24-2024		6	ARK.			
				JOB NO. 101120	54	61

② CROSS SECTIONS

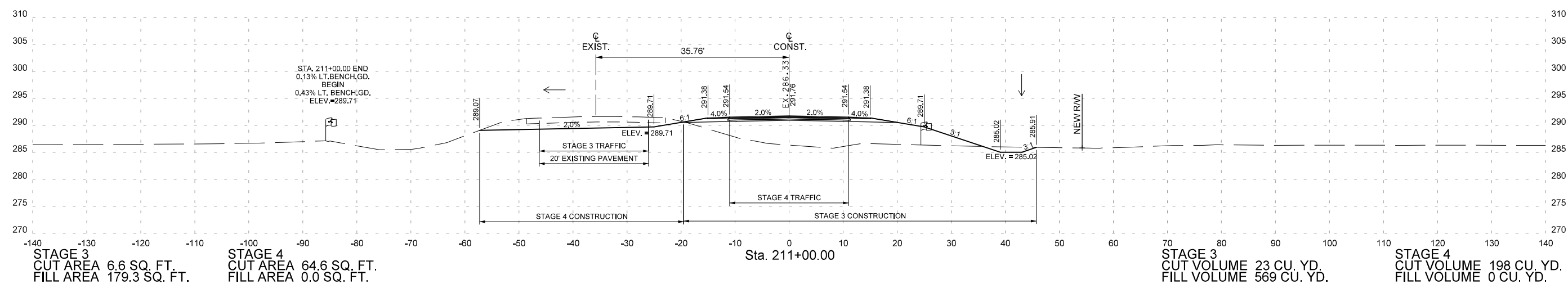
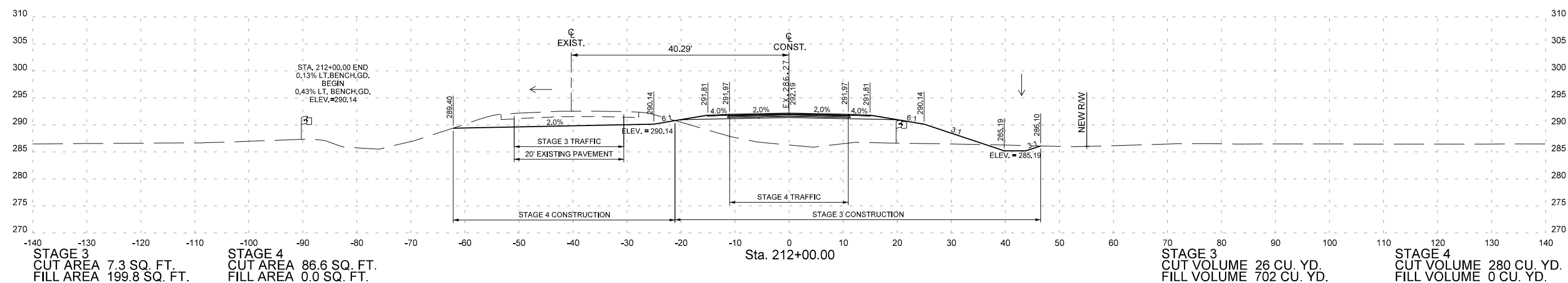
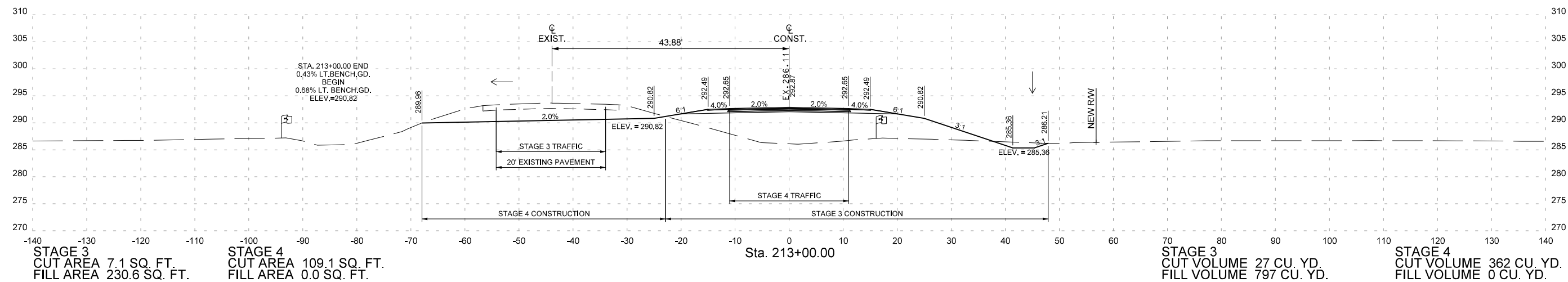

STA. 211+00.00 TO STA. 213+00.00
SITE 2

DATE REVISED	DATE REVISED	FED. RD. DIST. NO.	STATE	FED. AID PROJ. NO.	SHEET NO.	TOTAL SHEETS
07-24-2024		6	ARK.			
				JOB NO. 101120	55	61

② CROSS SECTIONS

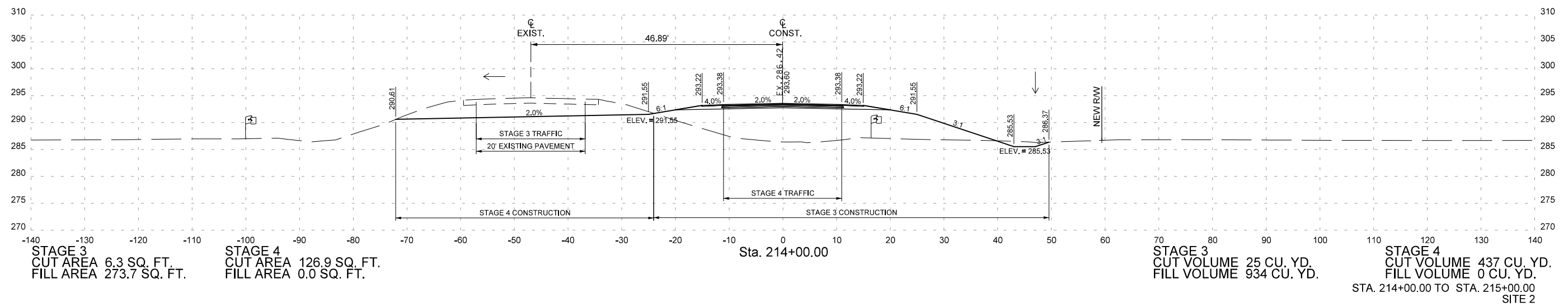
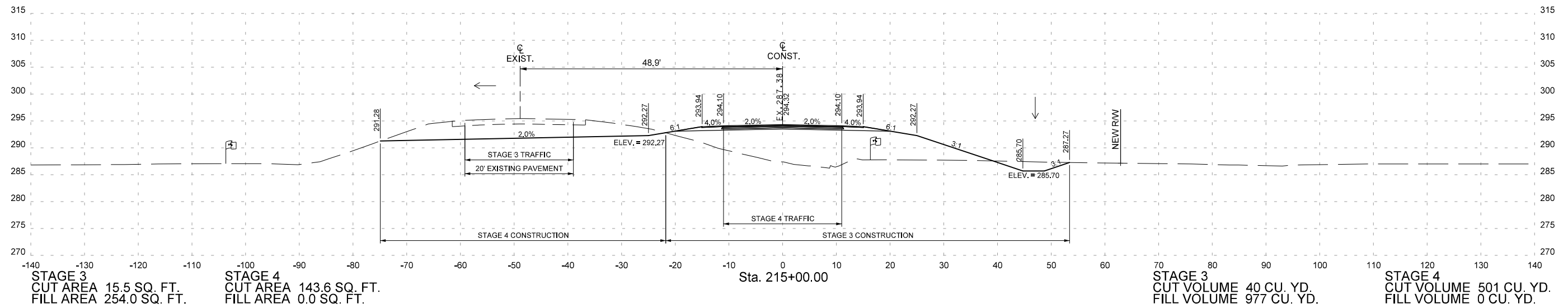

STA. 214+00.00 TO STA. 215+00.00
 SITE 2

DATE REVISED	DATE REVISED	FED. RD. DIST. NO.	STATE	FED. AID PROJ. NO.	SHEET NO.	TOTAL SHEETS
07-24-2024		6	ARK.			
		JOB NO.		101120	56	61

② CROSS SECTIONS

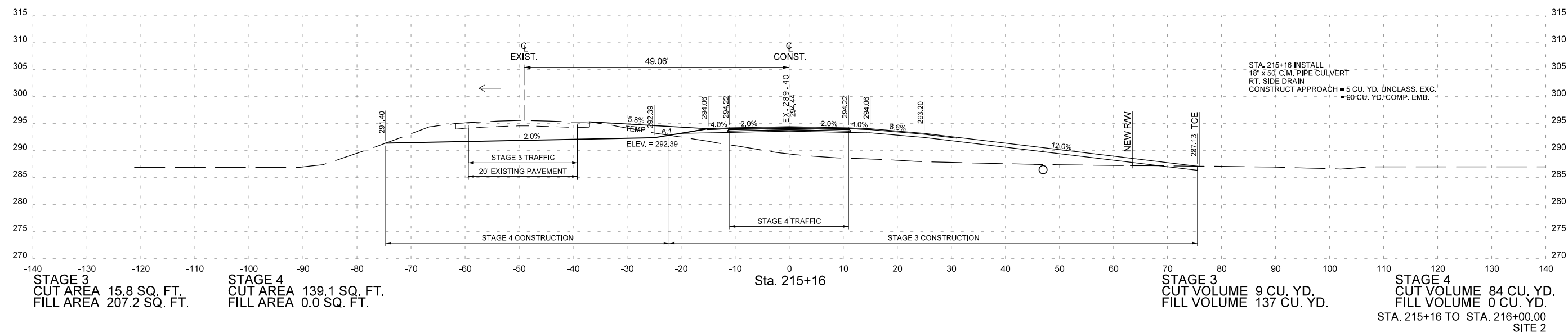
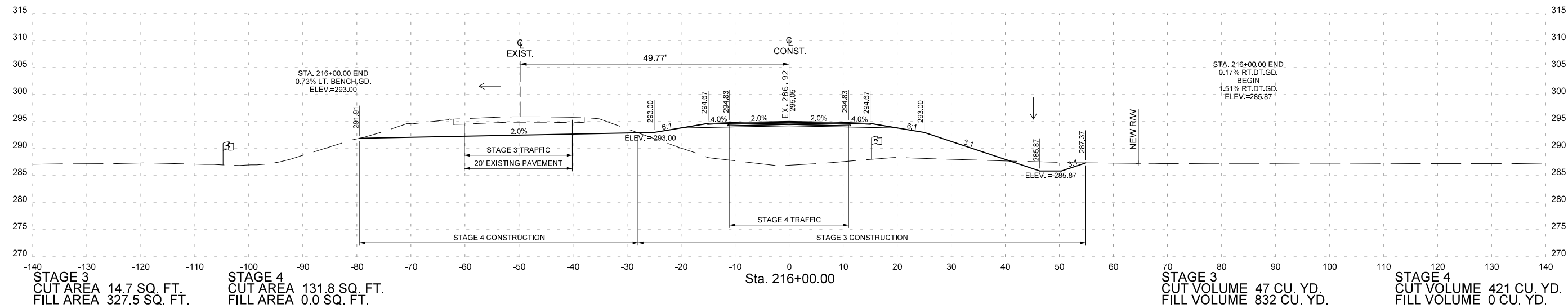

DATE REVISED	DATE REVISED	FED. RD. DIST. NO.	STATE	FED. AID PROJ. NO.	SHEET NO.	TOTAL SHEETS
07-24-2024		6	ARK.			
		JOB NO.		101120	57	61

② CROSS SECTIONS

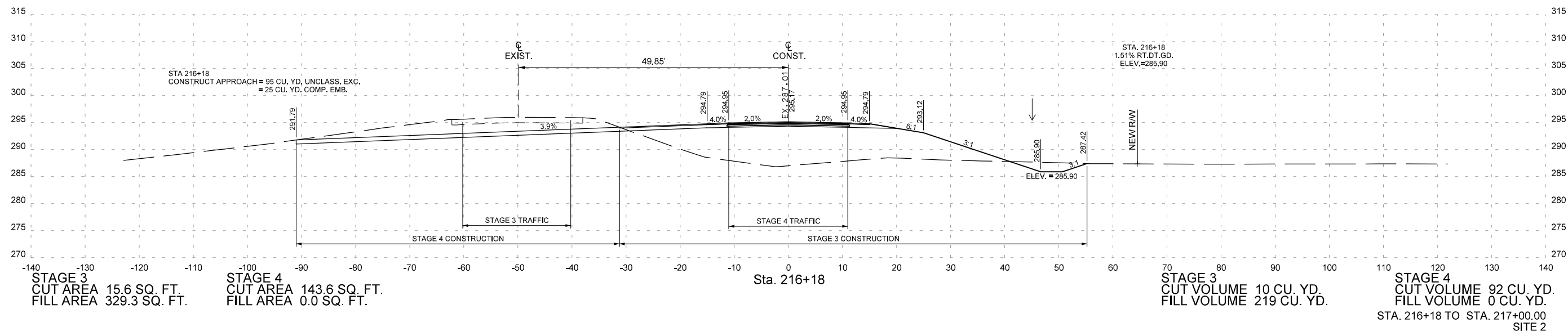
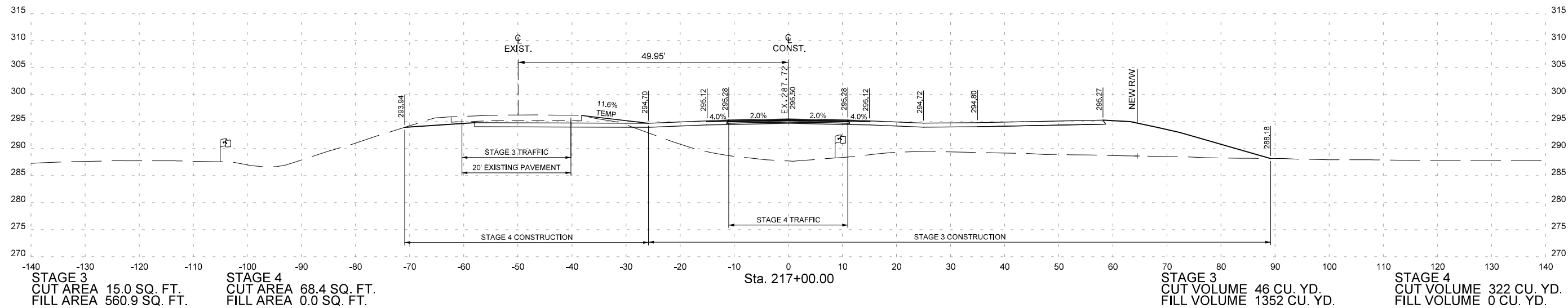

DATE REVISED	DATE REVISED	FED. RD. DIST. NO.	STATE	FED. AID PROJ. NO.	SHEET NO.	TOTAL SHEETS
07-24-2024		6	ARK.			
				JOB NO. 101120	58	61

② CROSS SECTIONS

SLOPE INTERCEPT 217+77.66

STAGE 3
CUT AREA 0.0 SQ. FT.
FILL AREA 0.0 SQ. FT.

STAGE 4
CUT AREA 0.0 SQ. FT.
FILL AREA 0.0 SQ. FT.

STAGE 3
CUT VOLUME 504 CU. YD.
FILL VOLUME 1 CU. YD.

STAGE 4
CUT VOLUME 0 CU. YD.
FILL VOLUME 0 CU. YD.

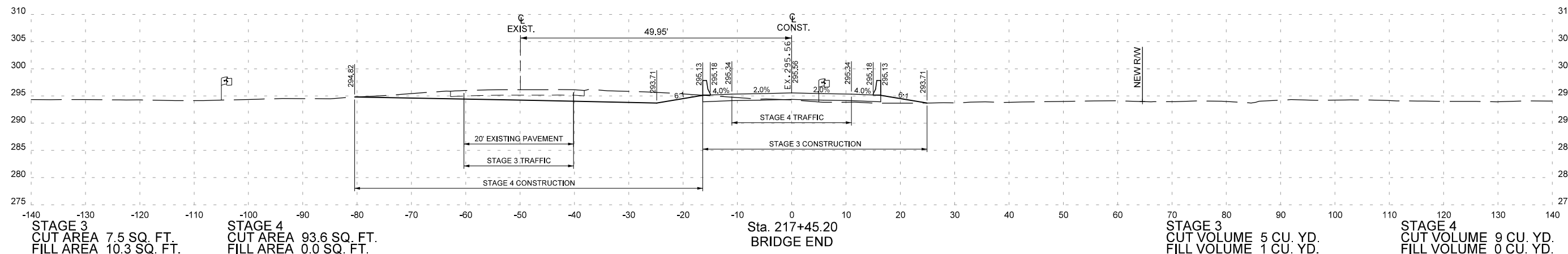

STAGE 3
CUT AREA 7.5 SQ. FT.
FILL AREA 10.3 SQ. FT.

STAGE 4
CUT AREA 93.6 SQ. FT.
FILL AREA 0.0 SQ. FT.

Sta. 217+45.20
BRIDGE END

STAGE 3
CUT VOLUME 5 CU. YD.
FILL VOLUME 1 CU. YD.

STAGE 4
CUT VOLUME 9 CU. YD.
FILL VOLUME 0 CU. YD.

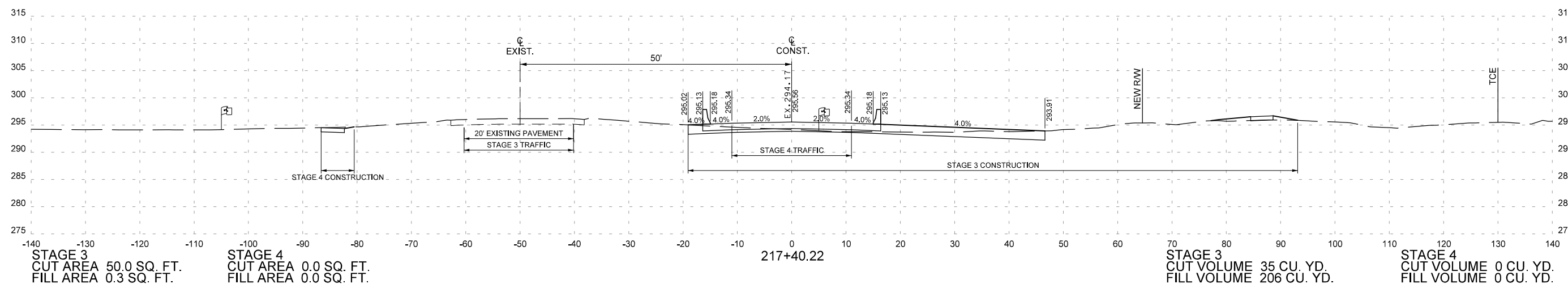

STAGE 3
CUT AREA 50.0 SQ. FT.
FILL AREA 0.3 SQ. FT.

STAGE 4
CUT AREA 0.0 SQ. FT.
FILL AREA 0.0 SQ. FT.

217+40.22

STAGE 3
CUT VOLUME 35 CU. YD.
FILL VOLUME 206 CU. YD.

STAGE 4
CUT VOLUME 0 CU. YD.
FILL VOLUME 0 CU. YD.

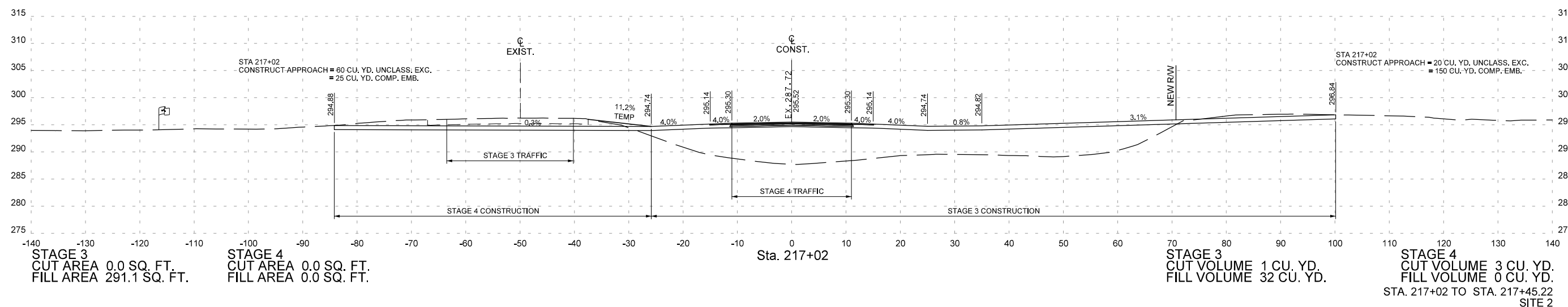

STAGE 3
CUT AREA 0.0 SQ. FT.
FILL AREA 291.1 SQ. FT.

STAGE 4
CUT AREA 0.0 SQ. FT.
FILL AREA 0.0 SQ. FT.

Sta. 217+02

STAGE 3
CUT VOLUME 1 CU. YD.
FILL VOLUME 32 CU. YD.

STAGE 4
CUT VOLUME 3 CU. YD.
FILL VOLUME 0 CU. YD.
STA. 217+02 TO STA. 217+45.22
SITE 2

DATE REVISED	DATE REVISED	FED. RD. DIST. NO.	STATE	FED. AID PROJ. NO.	SHEET NO.	TOTAL SHEETS
07-24-2024		6	ARK.			
		JOB NO.		101120	59	61

② CROSS SECTIONS

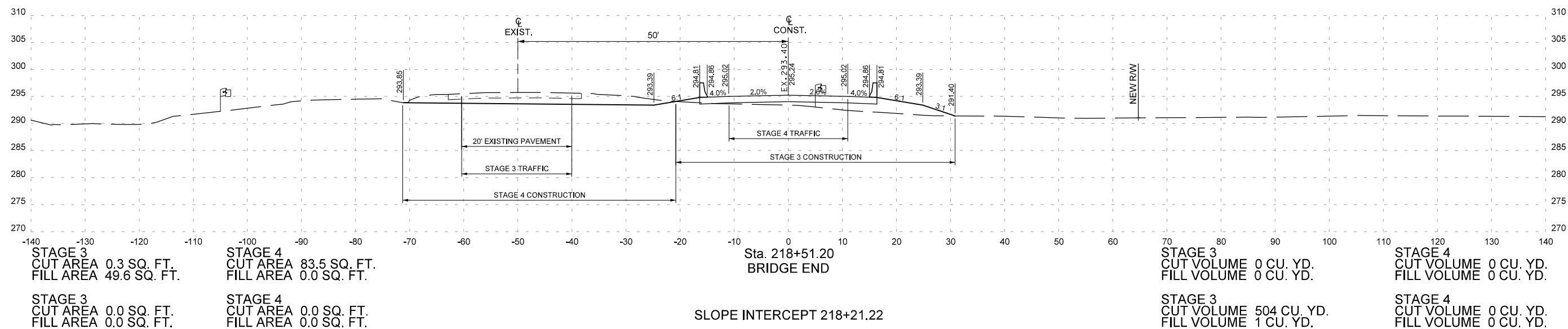
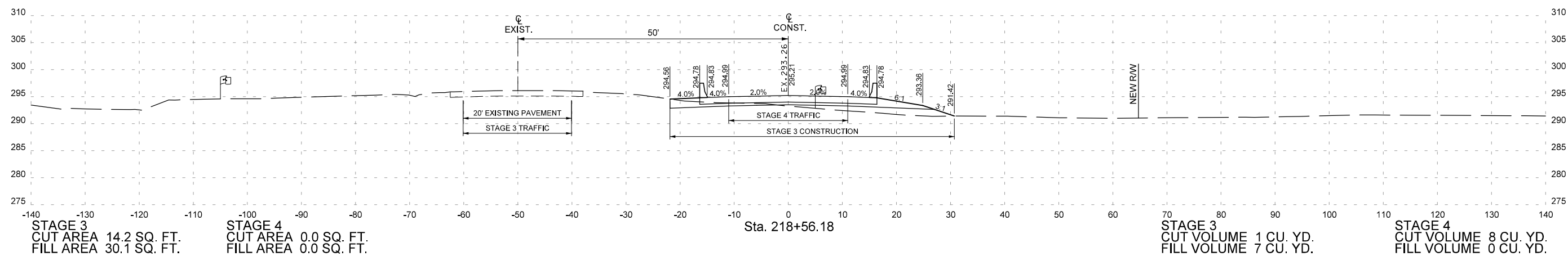
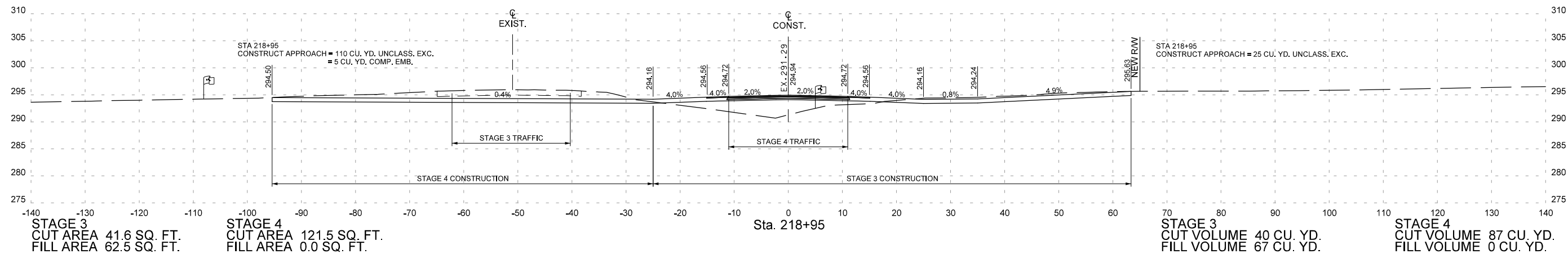

STA. 218+51.20 TO STA. 218+95
SITE 2

DATE REVISED	DATE REVISED	FED. RD. DIST. NO.	STATE	FED. AID PROJ. NO.	SHEET NO.	TOTAL SHEETS
07-24-2024		6	ARK.			
				JOB NO. 101120	60	61

② CROSS SECTIONS

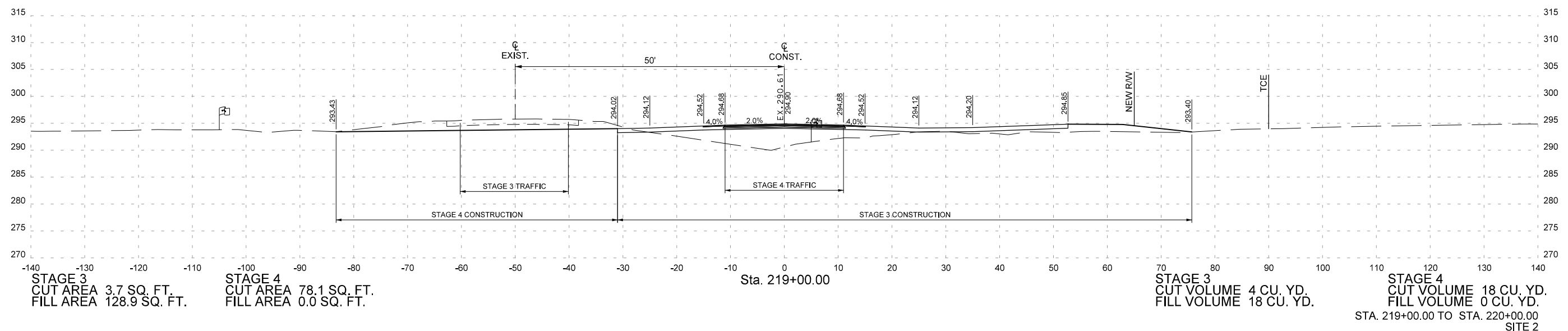
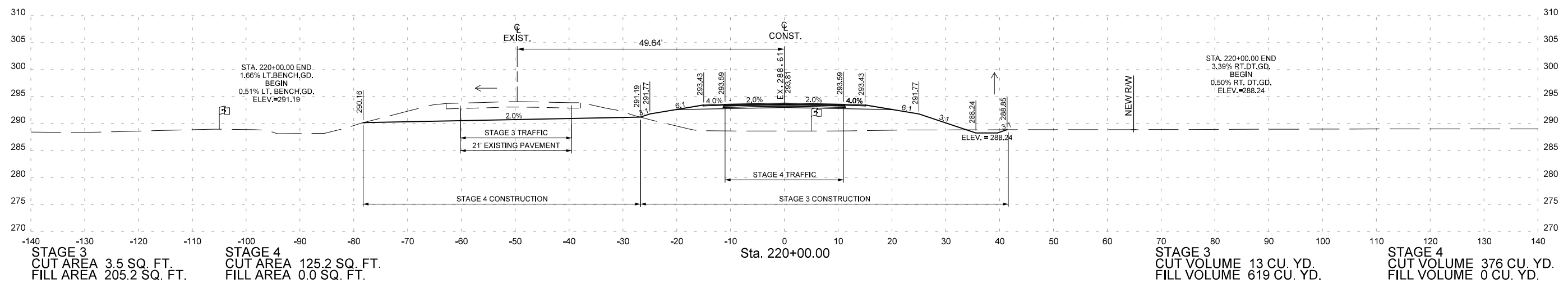

DATE REVISED	DATE REVISED	FED. RD. DIST. NO.	STATE	FED. AID PROJ. NO.	SHEET NO.	TOTAL SHEETS
07-24-2024		6	ARK.			
				JOB NO. 101120	61	61

② CROSS SECTIONS

