

FISCAL YEAR	JOB NO.	SHEET NO.	TO SHEETS
1928	679	1	16

STATE OF ARKANSAS
STATE HIGHWAY DEPARTMENT

PLAN OF PROPOSED BRIDGE
OVER
OUACHITA RIVER
HOT SPRING COUNTY

INDEX OF SHEETS

Sheet No. 1	Drwg. No. 1448	Title Sheet
" 2	" 1449	Layout Ouachita River Bridge, Arch Alternate
" 3	" 1450	" " " " " "
" 4	" 1451	Details of Arch Span No. 1
" 5	" 1452	" " " " " 2
" 6	" 1453	" " " " " 3
" 7	" 1454	Details of Handrail & Approach Substructure for Arch Alt.
" 8	" 1019	" " Standard 35'-0" R.C.D. Girder, Pile Trestle, 20' Railway
" 9	" 1455	Layout of Ouachita River Bridge Steel Alt.
" 10	" 1456	" " " " " " " "
" 11	" 1457	Details of Spans No. 1 & 3
" 12	" 1458	" " " " " " " "
" 13	" 1088	" " " " " " " "
" 14-16		Plan, Profile & Cross Section Sheets

Special Provisions
Revisions to Paragraphs 172 & 173-15 sheet.
Precast Concrete Piling Supplementing
Sect 68-2 Sheets.
Removal of Existing Structure-1 Sheet.

ROUTE 51 SEC. 3
JOB No 679
FEDERAL AID PROJECT No.

Concrete Arch Bridge

Item No. 12	Common Excav.	2463 Cu. Yds.
" 13	Dry Ex. for Strucs.	775 " "
" 13	Wet " " "	180 " "
" 13	Rock " " "	11 " "
" 17	Borrow	13. " "
" 54	Class "A" Conc.	518.22 " "
" 54	" "S" "	1565.86 " "
" 55	Reinf'g Steel	380,756 Lbs.
" 68	Precast Conc. Piling	1,740 Lin. Ft.
" 69	Rip Rap	125 Sq. Yds.
" 74	Conc. Railing	2,368 Lin. Ft.
S.P.	Remove Old Bridge	Lump Sum

Steel Bridge

Item No. 12	Common Excav.	2,463 Cu. Yds.
" 13	Dry Ex. for Strucs.	775 " "
" 13	Wet " " "	180 " "
" 13	Rock " " "	11 " "
" 17	Borrow	13. " "
" 54	Class "A" Conc.	518.22 " "
" 54	" "S" "	1565.86 " "
" 55	Reinf'g Steel	380,756 Lbs.
" 68	Precast Conc. Piling	1,740 Lin. Ft.
" 69	Rip Rap	125 Sq. Yds.
" 74	Conc. Railing	2,368 Lin. Ft.
S.P.	Remove Old Bridge	Lump Sum

Note: Same Type of Handrail to be used on concrete portion of both steel and concrete alternates.

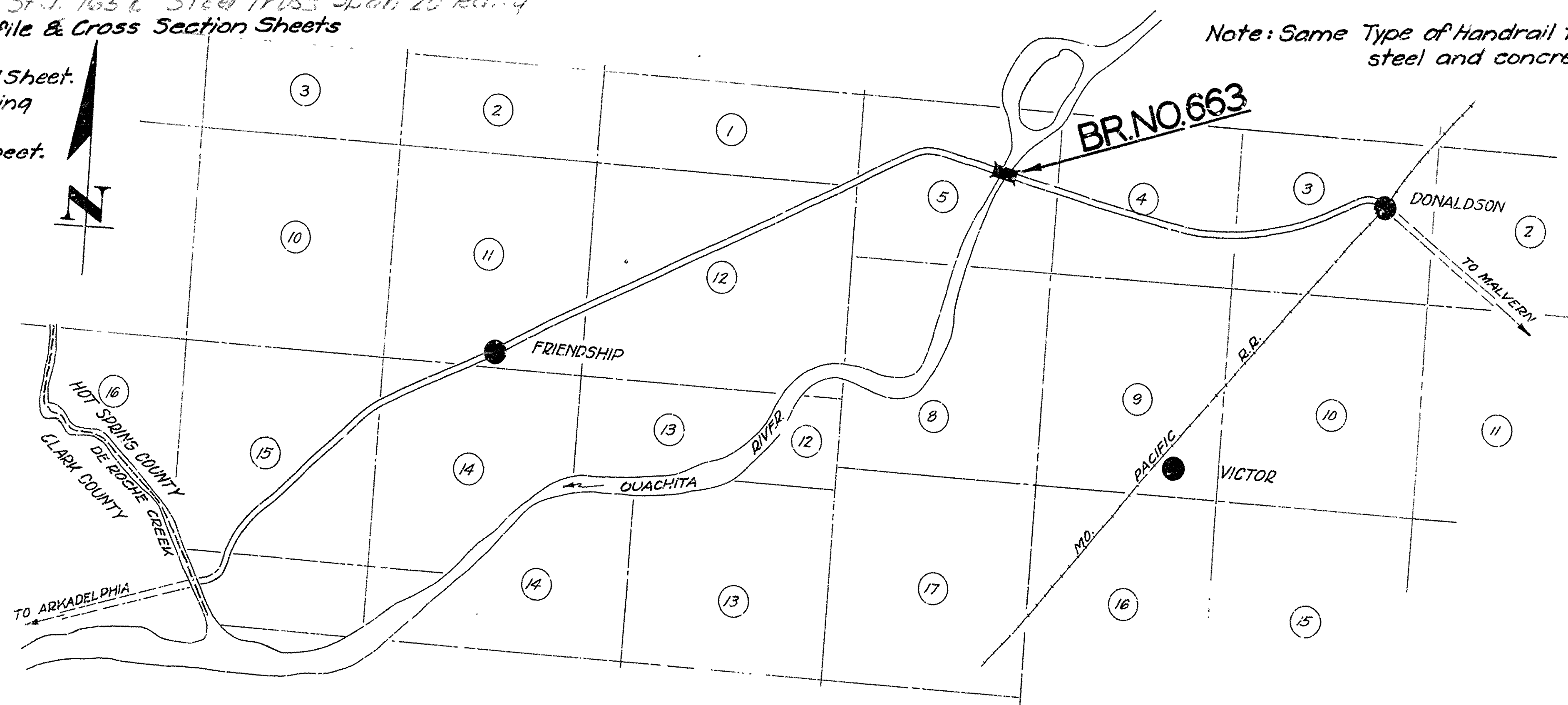

LAYOUT

LENGTH OF PROJECT ARCH 1177'-0" = 0.223 MI.
STEEL 1134'-6" = 0.207 MI.

APPROVED	[Signature]
COMMISSIONER - STATE LANDS, HIGHWAYS AND IMPROVEMENTS	[Signature]
APPROVED	[Signature]
STATE HIGHWAY ENGINEER	[Signature]
RECOMMENDED FOR APPROVAL	[Signature]
DISTRICT ENGINEER - U. S. BUREAU OF PUBLIC ROADS	[Signature]
RECOMMENDED FOR APPROVAL	[Signature]
CHIEF ENGINEER - U. S. BUREAU OF PUBLIC ROADS	[Signature]
APPROVED	[Signature]
DIRECTOR - U. S. BUREAU OF PUBLIC ROADS	[Signature]

N.B. Sawyer
BRIDGE ENGINEER

BRIDGE No. 663 DRAWING No. 1448

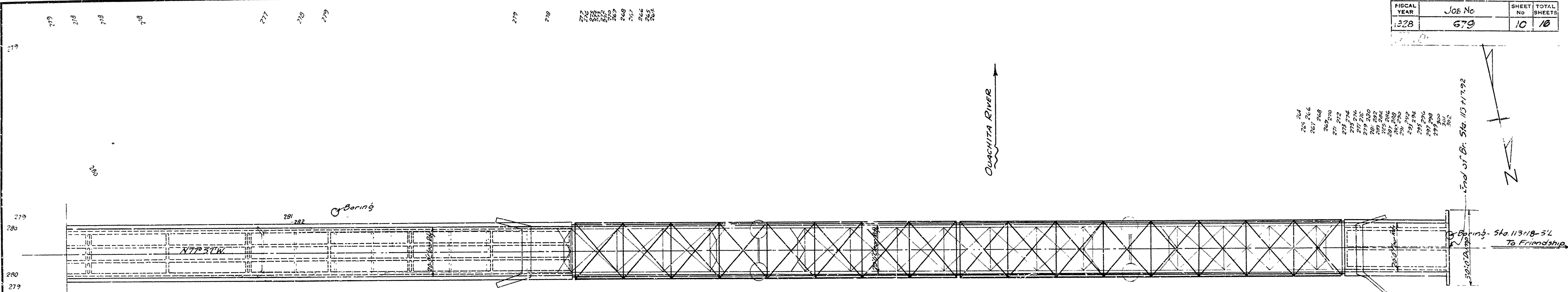

PLAN

QUANTITIES

Item	Description	Quantity	Unit
12	Common Excavation	3875	cu yds
13	Dry Excavation for Structures	493	cu yds.
13	Wet " " "	79	" "
13	Rock " " "	499	" "
17	Borrow	1250	" "
54	Class "S" Concrete	1132.30	" "
54	Class "A" " "	387.01	" "
55	Reinforcing Steel	296,525	lbs
56	Structural Steel (Trusses)	354,110	lbs.
63	recast Concrete Piling	1852	lin.ft.
69	Zip Rep	125	sq.yds
74	Concrete Railing	1699.5	lin. ft
Spc.	Removal of Old Structure	Lump Sum	
		10.75%	

244	245	246	247	248	249	250	251	252	253	254	255	256	257	258	259	260	261	262	263	264	265	266	267	268	269	270	271	272	273	274	275	276	277	278	279	280	281	282	283	284	285	286	287	288	289	290	291	292	293	294	295	296	297	298	299	300
-----	-----	-----	-----	-----	-----	-----	-----	-----	-----	-----	-----	-----	-----	-----	-----	-----	-----	-----	-----	-----	-----	-----	-----	-----	-----	-----	-----	-----	-----	-----	-----	-----	-----	-----	-----	-----	-----	-----	-----	-----	-----	-----	-----	-----	-----	-----	-----	-----	-----	-----	-----	-----	-----	-----	-----	-----

Note: Bridge Contractor to remove existing structure. Timber Approach, 2-100' Steel Truss Spans & 1-165' Steel Truss Span

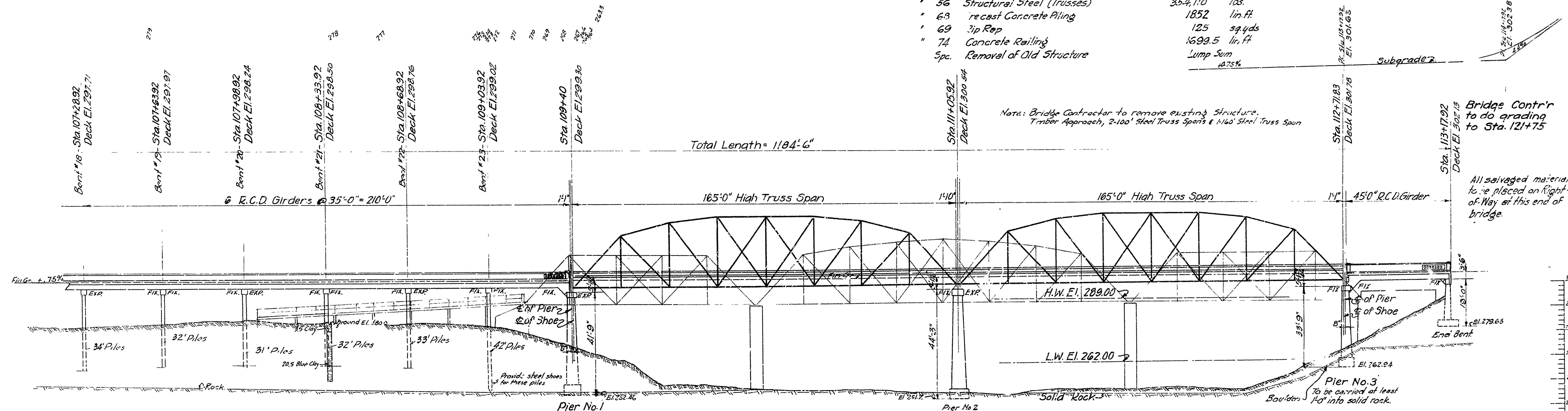

ELEVATION

For Details of 35' R.C.D Girder Spans, See Dwg. No. 1019
 For Details of 45' R.C.D Girder Span, See Dwg. No. 1005
 For Details of 165' High Truss Spans, See Dwg. No. 1088
 For Details of Substructure See Dwg. No. 1019, No. 1457 & No. 1458

Length of Piling shown, are assumed for Estimating Quantities only. Actual lengths to be determined in the field

Sounding - Sta. 113+18 - 5' Left
 Surface El. 295.0
 Depth of Clay - 8.3'
 Total depth to rock - 8.3'
 Rock El. 286.7

DRAINAGE AREA
 1700 Sq. Ft. Hilly
 B.M. El. 287.83
 On Bridge seat west about north side.

LAYOUT OF BRIDGE
 OVER OUACHITA RIVER
 HOT SPRING COUNTY
 ROUTE 51 SEC. 3

ARKANSAS STATE HIGHWAY DEPARTMENT
 LITTLE ROCK, ARK.
 Drawn By: LS Date: 11-13-28
 Traced By: GA Date: 1-8-29
 Checked By: _____ Date: _____
 BRIDGE NO. 663 SCALE: 1 in. = 20 ft.
 DRAWING NO. 1456

N.B. Sawyer
 BRIDGE ENGINEER