

DATE REVISED	DATE FILMED	DATE REVISED	DATE FILMED	FED. DIST. NO.	STATE	FED. AID PROJ. NO.	SHEET NO.	TOTAL SHEETS
				6	ARK.			
						JOB NO. 080506	1	49

2 CROOKED BRANCH STR. & APPRS. (S)

ARKANSAS DEPARTMENT OF TRANSPORTATION
CONSTRUCTION PLANS FOR STATE HIGHWAY

CROOKED BRANCH STR. & APPRS. (S)

POPE COUNTY
ROUTE 7 SECTION 15

FEDERAL AID PROJ. NHPP-0058(47)

JOB 080506

NOT TO SCALE

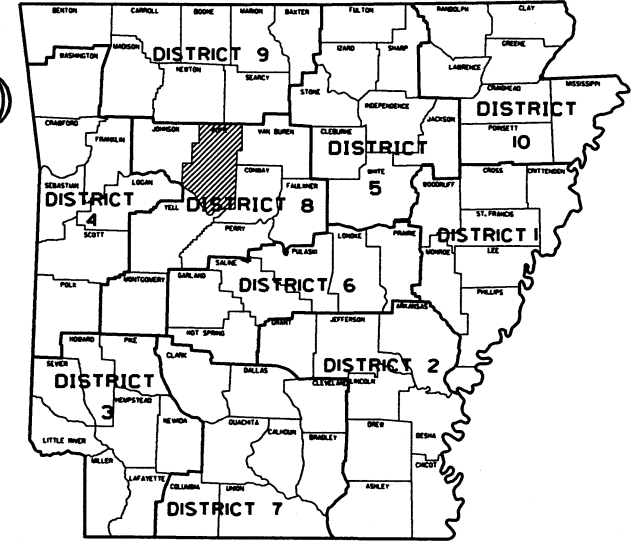

ARK. HWY. DIST. NO. 8

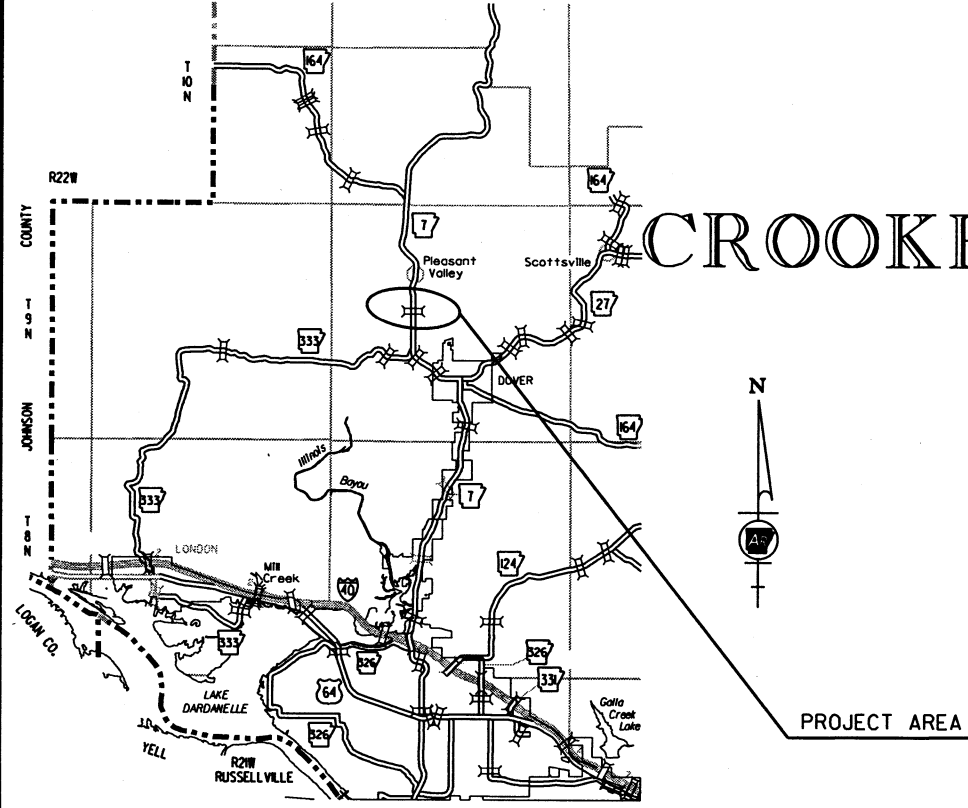

VICINITY MAP

BRIDGE DATA

- 1 STA. 310+32.00 BRIDGE END
- BRIDGE NO. 07428
- 99'-0" INTEGRAL W-BEAM UNIT (32' -35' -32')
- 40'-0" CLEAR ROADWAY
- 100.00' BRIDGE LENGTH
- STA. 311+32.00 BRIDGE END

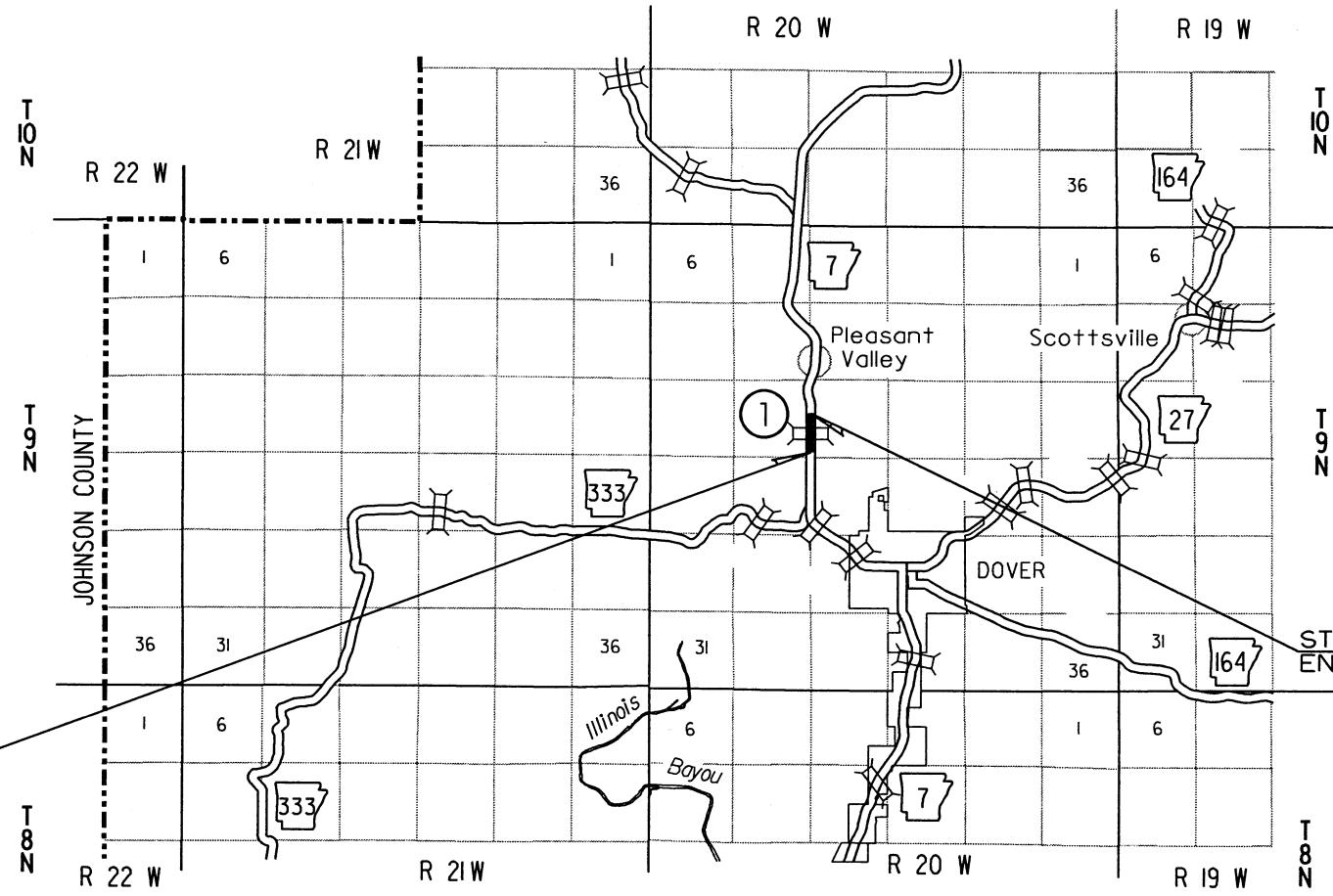

STA. 309+00.00
BEGIN JOB 080506
LOG MILE 11.69

STA. 314+00.00
END JOB 080506

DESIGN TRAFFIC DATA

DESIGN YEAR	2019
2019 ADT	3800
2039 ADT	4400
2039 DHV	0.484
DIRECTIONAL DISTRIBUTION	0.60
TRUCKS	8%
DESIGN SPEED	55 MPH



APPROVED



1-10-19

DEPUTY DIRECTOR
AND CHIEF ENGINEER

	BEGIN PROJECT	MID-POINT OF PROJECT	END PROJECT
LATITUDE	N 35°25' 39"	N 35°25' 42"	N 35°25' 44"
LONGITUDE	W 93°08' 05"	W 93°08' 05"	W 93°08' 05"

LENGTH OF PROJECT CALCULATED ALONG C.L.

GROSS LENGTH OF PROJECT	500.00	FEET	OR	0.095	MILES
NET ROADWAY	400.00			0.076	MILES
NET BRIDGES	100.00			0.019	MILES
NET PROJECT	500.00			0.095	MILES

10/26/2017

R080506.DGN

INDEX OF SHEETS

SHEET NO.	TITLE	BRIDGE NO.	DRWG.NO.
1	TITLE SHEET		
2	INDEX OF SHEETS AND STANDARD DRAWINGS		
3	GOVERNING SPECIFICATIONS AND GENERAL NOTES		
4 - 5	TYPICAL SECTIONS OF IMPROVEMENT		
6	SPECIAL DETAILS		
7 - 10	TEMPORARY EROSION CONTROL DETAILS		
11 - 14	MAINTENANCE OF TRAFFIC DETAILS		
15	PERMANENT PAVEMENT MARKING DETAILS		
16 - 19	QUANTITIES		
20	SCHEDULE OF BRIDGE QUANTITIES	07428	60371
21	SUMMARY OF QUANTITIES AND REVISIONS		
22 - 24	SURVEY CONTROL DETAILS		
25	PLAN AND PROFILE SHEET		
26	DETOUR PLAN AND PROFILE SHEET		
27	LAYOUT OF BRIDGE HIGHWAY 7 OVER CROOKED BRANCH (SHEET 1 OF 2)	07428	60372
28	LAYOUT OF BRIDGE HIGHWAY 7 OVER CROOKED BRANCH (SHEET 2 OF 2)	07428	60373
29	DETAILS OF END BENTS	07428	60374
30	DETAILS OF INTERMEDIATE BENTS (SHEET 1 OF 2)	07428	60375
31	DETAILS OF INTERMEDIATE BENTS (SHEET 2 OF 2)	07428	60376
32	DETAILS OF 99' INTEGRAL W-BEAM UNIT (SHEET 1 OF 7)	07428	60377
33	DETAILS OF 99' INTEGRAL W-BEAM UNIT (SHEET 2 OF 7)	07428	60378
34	DETAILS OF 99' INTEGRAL W-BEAM UNIT (SHEET 3 OF 7)	07428	60379
35	DETAILS OF 99' INTEGRAL W-BEAM UNIT (SHEET 4 OF 7)	07428	60380
36	DETAILS OF 99' INTEGRAL W-BEAM UNIT (SHEET 5 OF 7)	07428	60381
37	DETAILS OF 99' INTEGRAL W-BEAM UNIT (SHEET 6 OF 7)	07428	60382
38	DETAILS OF 99' INTEGRAL W-BEAM UNIT (SHEET 7 OF 7)	07428	60383
39	DETAILS OF DECORATIVE CONCRETE PARAPET RAILING (SHEET 1 OF 4)	07428	60384
40	DETAILS OF DECORATIVE CONCRETE PARAPET RAILING (SHEET 2 OF 4)	07428	60385
41	DETAILS OF DECORATIVE CONCRETE PARAPET RAILING (SHEET 3 OF 4)	07428	60386
42	DETAILS OF DECORATIVE CONCRETE PARAPET RAILING (SHEET 4 OF 4)	07428	60387
43	DETAILS OF TYPE SPECIAL APPROACH GUTTERS	07428	60388
44 - 49	CROSS SECTIONS		

BRIDGE STANDARD DRAWINGS

DRWG.NO.	TITLE	DATE
55000	STANDARD DETAILS FOR EMBANKMENT CONSTRUCTION AND BACKFILL AT BRIDGE ENDS	02-27-14
55001	STANDARD DETAILS FOR DUMPED RIPRAP AND FILTER BLANKET AND COMPUTING EXCAVATION FOR STRUCTURES	02-27-14
55005	STANDARD DETAILS FOR PERMANENT STEEL BRIDGE DECK FORMS FOR STEEL & CONCRETE GIRDER SPANS	03-24-16
55006	STANDARD GENERAL NOTES FOR STEEL BRIDGE STRUCTURES	09-02-15
55007	STANDARD DETAILS FOR STEEL BRIDGE STRUCTURES	02-11-16
55010	STANDARD DETAILS FOR TYPE D BRIDGE NAME PLATE	01-17-17
55020	STANDARD DETAILS FOR STEEL H-PILES AND PILE ENCASEMENTS	03-24-16
55040C1	STANDARD DETAILS FOR TYPE C1 APPROACH SLAB	02-27-14
55054	STANDARD DETAILS FOR TEMPORARY BRIDGE STRUCTURE BRIDGE END PROTECTION SYSTEM	04-17-14
55055	STANDARD DETAILS FOR TEMPORARY BRIDGE STRUCTURE PRECAST CONCRETE SPANS 24' ROADWAY WIDTH (SHEET 1 OF 2)	04-17-14
55056	STANDARD DETAILS FOR TEMPORARY BRIDGE STRUCTURE PRECAST CONCRETE SPANS 24' ROADWAY WIDTH (SHEET 2 OF 2)	04-17-14

ROADWAY STANDARD DRAWINGS

DRWG.NO.	TITLE	DATE
CDP-1	CONCRETE DITCH PAVING	12-08-16
GR-8	GUARD RAIL DETAILS	11-16-17
GR-8A	GUARD RAIL DETAILS	11-16-17
GR-9	GUARD RAIL DETAILS	04-17-08
GR-9A	GUARD RAIL DETAILS	04-17-08
GR-10	GUARD RAIL DETAILS	11-16-17
GR-11	GUARD RAIL DETAILS	11-16-17
GR-12	GUARD RAIL DETAILS	11-16-17
PCC-1	CONCRETE PIPE CULVERT FILL HEIGHTS & BEDDING	02-27-14
PCM-1	METAL PIPE CULVERT FILL HEIGHTS & BEDDING	02-27-14
PCP-1	PLASTIC PIPE CULVERT (HIGH DENSITY POLYETHYLENE)	02-27-14
PCP-2	PLASTIC PIPE CULVERT (PVC F949)	02-27-14
PM-1	PAVEMENT MARKING DETAILS	06-01-17
PU-1	DETAILS OF PIPE UNDERDRAIN	12-08-16
SE-2	TABLES AND METHOD OF SUPERELEVATION FOR TWO-WAY TRAFFIC	10-18-96
TC-1	STANDARD TRAFFIC CONTROLS FOR HIGHWAY CONSTRUCTION	04-13-17
TC-2	STANDARD TRAFFIC CONTROLS FOR HIGHWAY CONSTRUCTION	09-02-15
TC-3	STANDARD TRAFFIC CONTROLS FOR HIGHWAY CONSTRUCTION	09-02-15
TEC-1	TEMPORARY EROSION CONTROL DEVICES	11-16-17
TEC-2	TEMPORARY EROSION CONTROL DEVICES	06-02-94
TEC-3	TEMPORARY EROSION CONTROL DEVICES	11-03-94
WF-2	WIRE FENCE WATER GAPS	04-20-79
WF-4	WIRE FENCE TYPE C AND D	08-22-02

DATE REVISED	DATE FILMED	DATE REVISED	DATE FILMED	FED. RD. DIST. NO.	STATE	FED. AID PROJ. NO.	SHEET NO.	TOTAL SHEETS
				6	ARK.		2	49

② INDEX OF SHEETS AND STANDARD DRAWINGS

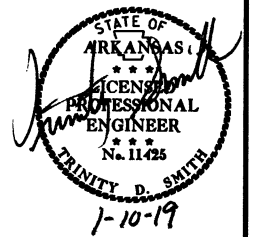

INDEX OF SHEETS AND STANDARD DRAWINGS

12/4/2018

RO80506.DGN

DATE REVISED	DATE FILMED	DATE REVISED	DATE FILMED	FED. DIST. NO.	STATE	FED. AID PROJ. NO.	SHEET NO.	TOTAL SHEETS
				6	ARK.			
						080506	3	49

2 GOVERNING SPECIFICATIONS AND GEN. NOTES

GOVERNING SPECIFICATIONS

ARKANSAS STATE HIGHWAY COMMISSION STANDARD SPECIFICATIONS FOR HIGHWAY CONSTRUCTION, EDITION OF 2014, AND THE FOLLOWING SPECIAL PROVISIONS AND SUPPLEMENTAL SPECIFICATIONS:

NUMBER	TITLE
ERRATA	ERRATA FOR THE BOOK OF STANDARD SPECIFICATIONS
FHWA-1273	REQUIRED CONTRACT PROVISIONS FEDERAL-AID CONSTRUCTION CONTRACTS
FHWA-1273	SUPPLEMENT - EQUAL EMPLOYMENT OPPORTUNITY - NOTICE TO CONTRACTORS
FHWA-1273	SUPPLEMENT - SPECIFIC EQUAL EMPLOYMENT OPPORTUNITY RESPONSIBILITIES (23 U.S.C. 140)
FHWA-1273	SUPPLEMENT - EQUAL EMPLOYMENT OPPORTUNITY - GOALS AND TIMETABLES
FHWA-1273	SUPPLEMENT - EQUAL EMPLOYMENT OPPORTUNITY - FEDERAL STANDARDS
FHWA-1273	SUPPLEMENT - POSTERS AND NOTICES REQUIRED FOR FEDERAL-AID PROJECTS
FHWA-1273	SUPPLEMENT - WAGE RATE DETERMINATION
100-3	CONTRACTOR'S LICENSE
100-4	DEPARTMENT NAME CHANGE
102-2	ISSUANCE OF PROPOSALS
108-1	LIQUIDATED DAMAGES
108-2	WORK ALLOWED PRIOR TO ISSUANCE OF WORK ORDER
110-1	PROTECTION OF WATER QUALITY AND WETLANDS
303-1	AGGREGATE BASE COURSE
306-1	QUALITY CONTROL AND ACCEPTANCE
400-1	TACK COATS
400-4	DESIGN AND QUALITY CONTROL OF ASPHALT MIXTURES
400-5	PERCENT AIR VOIDS FOR ACHM MIX DESIGNS
400-6	LIQUID ANTI-STRIP ADDITIVE
410-1	CONSTRUCTION REQUIREMENTS AND ACCEPTANCE OF ASPHALT CONCRETE PLANT MIX COURSES
410-2	DEVICES FOR MEASURING DENSITY FOR ROLLING PATTERNS
600-2	INCIDENTAL CONSTRUCTION
604-1	RETROREFLECTIVE SHEETING FOR TRAFFIC CONTROL DEVICES IN CONSTRUCTION ZONES
605-1	CONCRETE DITCH PAVING
606-1	PIPE CULVERTS FOR SIDE DRAINS
617-1	GUARDRAIL TERMINAL (TYPE 2)
620-1	MULCH COVER
621-1	FILTER SOCKS
800-1	STRUCTURES
802-3	CONCRETE FOR STRUCTURES
804-2	REINFORCING STEEL FOR STRUCTURES
JOB 080506	ARCHITECTURAL FINISH
JOB 080506	BIDDING REQUIREMENTS AND CONDITIONS
JOB 080506	BROADBAND INTERNET SERVICE FOR ASPHALT CONCRETE PLANT
JOB 080506	BROADBAND INTERNET SERVICE FOR FIELD OFFICE
JOB 080506	CARGO PREFERENCE ACT REQUIREMENTS
JOB 080506	CLASS C FLY ASH IN PORTLAND CEMENT CONCRETE PAVEMENT AND CLASS S(AE) CONCRETE
JOB 080506	CONSTRUCTION IN SPECIAL FLOOD HAZARD AREAS
JOB 080506	DISADVANTAGED BUSINESS ENTERPRISE BIDDER'S RESPONSIBILITIES
JOB 080506	DIRECT TENSION INDICATORS FOR HIGH STRENGTH BOLT ASSEMBLIES
JOB 080506	DRINKING WATER PROTECTION
JOB 080506	GOALS FOR DISADVANTAGED BUSINESS ENTERPRISE PARTICIPATION
JOB 080506	MANDATORY ELECTRONIC CONTRACT
JOB 080506	MANDATORY ELECTRONIC DOCUMENT SUBMITTAL
JOB 080506	NESTING SITES OF MIGRATORY BIRDS
JOB 080506	OFF-SITE RESTRAINING CONDITIONS FOR INDIANA AND NORTHERN LONG-EARED BATS
JOB 080506	PLASTIC PIPE
JOB 080506	PRICE ADJUSTMENT FOR ASPHALT BINDER
JOB 080506	SETTLEMENT AGREEMENTS
JOB 080506	SOIL STABILIZATION
JOB 080506	STAINING CONCRETE SURFACES
JOB 080506	STORM WATER POLLUTION PREVENTION PLAN
JOB 080506	SUBMISSION OF ASPHALT CONCRETE HOT MIX ACCEPTANCE TEST RESULTS
JOB 080506	UTILITY ADJUSTMENTS
JOB 080506	VEGETATED BUFFER ZONE
JOB 080506	WARM MIX ASPHALT

GENERAL NOTES

- GRADE LINE DENOTES FINISHED GRADE WHERE SHOWN ON PLANS.
- ALL PIPE LINES, POWER, TELEPHONE, AND TELEGRAPH LINES TO BE MOVED OR LOWERED BY THE RESPECTIVE OWNERS AS PER AGREEMENT WITH SUCH OWNERS.
- ANY EQUIPMENT OR APPURTENANCE THAT INTERFERES WITH THE PROPOSED CONSTRUCTION AND WHICH MAY BE THE PROPERTY OF UTILITY SERVICE ORGANIZATIONS SHALL BE MOVED BY THE OWNERS UNLESS OTHERWISE PROVIDED.
- THE CONTRACTOR SHALL BE RESPONSIBLE FOR MAINTAINING U. S. MAILBOXES WITHIN THE PROJECT LIMITS IN SUCH A MANNER THAT THE PUBLIC MAY RECEIVE CONTINUED MAIL SERVICE. PAYMENT WILL BE CONSIDERED INCLUDED IN THE PRICE BID FOR THE VARIOUS BID ITEMS.
- ALL LAND MONUMENTS LOCATED WITHIN THE CONSTRUCTION AREA SHALL BE PROTECTED IN ACCORDANCE WITH SECTION 107.12 OF THE STANDARD SPECIFICATIONS.
- ALL TREES THAT DO NOT DIRECTLY INTERFERE WITH THE PROPOSED CONSTRUCTION SHALL BE SPARED AS DIRECTED BY THE ENGINEER. CARE AND DISCRETION SHALL BE USED TO INSURE THAT ALL TREES NOT TO BE REMOVED SHALL BE HARMED AS LITTLE AS POSSIBLE DURING THE CONSTRUCTION OPERATIONS.
- THE CONTRACTOR SHALL BE RESPONSIBLE FOR PROVIDING A FENCE TO CONTROL LIVESTOCK IN AREAS WHERE PASTURES ARE SEVERED. WIRE FENCE MAY BE CONSTRUCTED INITIALLY, OR IN LIEU THEREOF, THE CONTRACTOR AT HIS OWN EXPENSE, MAY ELECT TO PROVIDE TEMPORARY FENCING SUITABLE TO CONTAIN LIVESTOCK.
- THE SEQUENCE AS SHOWN ON THE MAINTENANCE OF TRAFFIC PLANS IS A GENERAL OUTLINE FOR THE CONSTRUCTION OF THIS PROJECT, AND IN NO WAY IS IT INTENDED TO COVER EVERY ITEM IN THE PROJECT. ITEMS NOT CRITICAL TO THE CONSTRUCTION SEQUENCE MAY BE CONSTRUCTED IN ANY STAGE AS APPROVED BY THE RESIDENT ENGINEER.
- ALL FLEXIBLE BASE AND ASPHALTIC PAVEMENTS REMOVED SHALL BE PAID FOR UNDER THE ITEM NO. 210 - UNCLASSIFIED EXCAVATION.
- THE EXISTING ASPHALT PAVEMENT TO BE REMOVED FROM THE REMAINING PAVEMENT SHALL BE SEPARATED BY SAWING ALONG A NEAT LINE. AFTER SAWING, THE PAVEMENT TO BE REMOVED SHALL BE CAREFULLY REMOVED IN A MANNER THAT WILL NOT DAMAGE THE PAVEMENT THAT IS TO REMAIN. ANY DAMAGE OF THE ASPHALT PAVEMENT THAT IS TO REMAIN IN PLACE SHALL BE REPAIRED AT THE CONTRACTOR'S EXPENSE.
- THIS PROJECT IS COVERED UNDER A SECTION 404 NATIONWIDE 14 PERMIT. REFER TO SECTION 110 OF THE STANDARD SPECIFICATIONS, EDITION OF 2014, FOR PERMIT REQUIREMENTS.

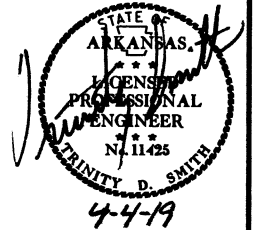

12/4/2018

RO80506.DGN

DATE REVISED	DATE FILMED	DATE REVISED	DATE FILMED	FED. RD. DIST. NO.	STATE	FED. AID PROJ. NO.	SHEET NO.	TOTAL SHEETS
				6	ARK.			
JOB NO. 080506							4	49

2 TYPICAL SECTIONS OF IMPROVEMENT

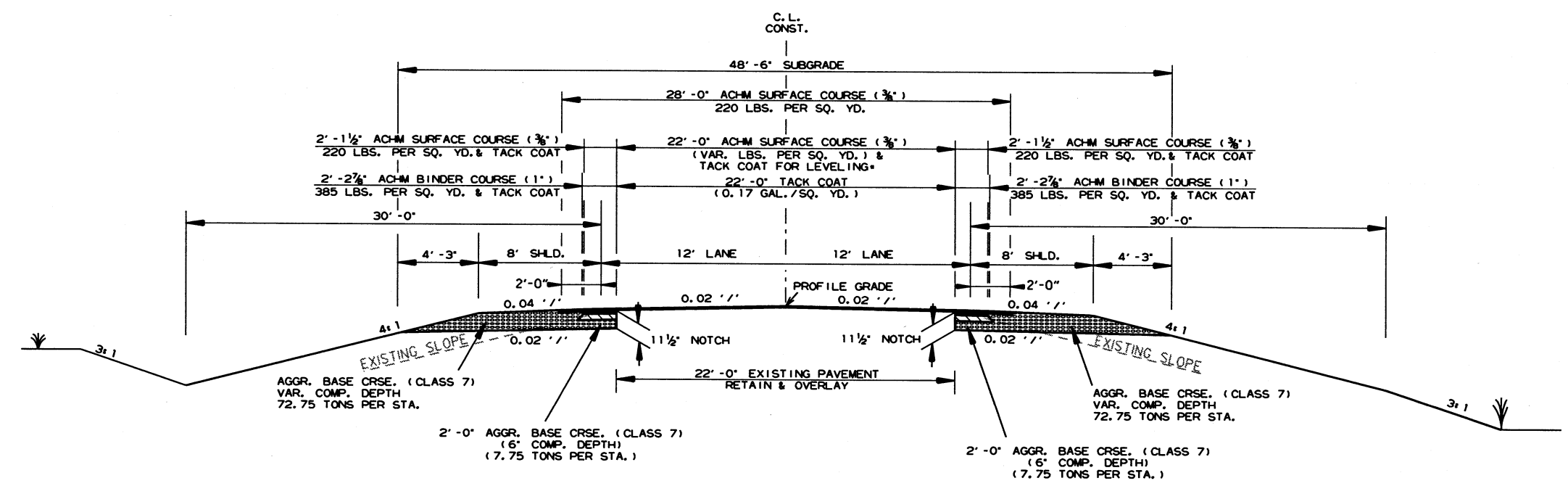
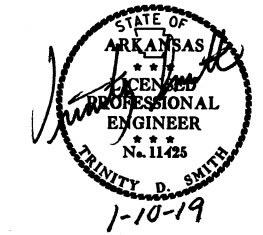

HWY. 7 NOTCH AND WIDEN OPEN SHOULDER

STA. 309+00.00 - STA. 309+95.50
 STA. 311+68.50 - STA. 314+00.00

NOTES:

REFER TO CROSS SECTIONS FOR DEVIATION FROM NORMAL SLOPES. NO CHANGES SHALL BE MADE FROM THE PLANNED SLOPES WITHOUT THE APPROVAL OF THE ENGINEER.

THE THICKNESS OF AGGREGATE BASE COURSE SHALL BE WITHIN PLUS OR MINUS ONE INCH OF THE PLAN THICKNESS SHOWN. THE CONTRACTOR WILL CORRECT ANY DEFICIENT THICKNESS THAT DOES NOT MEET TOLERANCE INDICATED. PAYMENT WILL NOT BE MADE FOR MATERIAL PLACED IN EXCESS OF THE TOLERANCE INDICATED.

THE FINAL 2 INCHES OF SURFACE COURSE IS TO BE PLACED AFTER ALL OTHER COURSES HAVE BEEN LAID. LONGITUDINAL JOINTS SHALL BE AT THE LANE LINES.

WITH THE APPROVAL OF THE ENGINEER, THE CONTRACTOR WILL BE ALLOWED TO SUBSTITUTE, AT NO ADDITIONAL COST TO THE DEPARTMENT, THE FIRST LIFT OF AC-11.5 SURFACE (3/8") IN LIEU OF AGGREGATE BASE COURSE ON THE SHOULDERS.

ASPHALT FOR LEVELING OF EXISTING PAVEMENT SHALL BE PLACED ONLY IF AND WHERE DIRECTED BY THE ENGINEER. CALCULATIONS FOR THE AMOUNT OF LEVELING AND/OR LEVELING OPERATIONS SHALL BE PERFORMED BEFORE CONSTRUCTING NOTCH AND WIDENING. CALCULATIONS WILL NOT BE PAID FOR DIRECTLY, BUT PAYMENT WILL BE CONSIDERED INCLUDED IN THE VARIOUS CONTRACT ITEMS.

12/12/2018
 R080506.DGN

DATE REVISED	DATE FILMED	DATE REVISED	DATE FILMED	FED. PROJ. DIST. NO.	STATE	FED. AID PROJ. NO.	SHEET NO.	TOTAL SHEETS
				6	ARK.			
						JOB NO. 080506	5	49

2 TYPICAL SECTIONS OF IMPROVEMENT

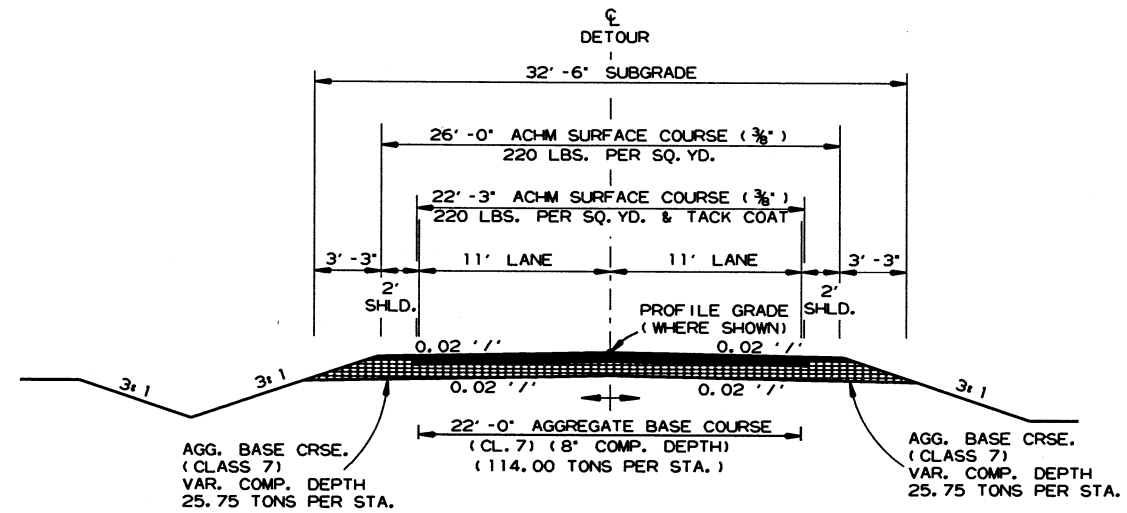
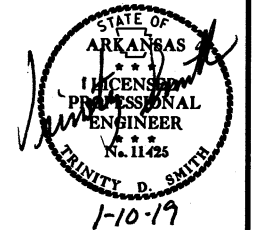

TYPICAL SECTIONS OF IMPROVEMENT DETOUR ROAD

STA. 20+00.00 TO STA. 24+30.00
STA. 25+23.00 TO STA. 29+26.32

NOTES:
REFER TO CROSS SECTIONS FOR DEVIATION FROM THE NORMAL SLOPES. NO CHANGES SHALL BE MADE FROM THE PLANNED SLOPES WITHOUT THE APPROVAL OF THE ENGINEER.

THE THICKNESS OF AGGREGATE BASE COURSE SHALL BE WITHIN PLUS OR MINUS ONE INCH OF THE PLAN THICKNESS SHOWN. THE CONTRACTOR WILL CORRECT ANY DEFICIENT THICKNESS THAT DOES NOT MEET TOLERANCE INDICATED. PAYMENT WILL NOT BE MADE FOR MATERIAL PLACED IN EXCESS OF THE TOLERANCE INDICATED.

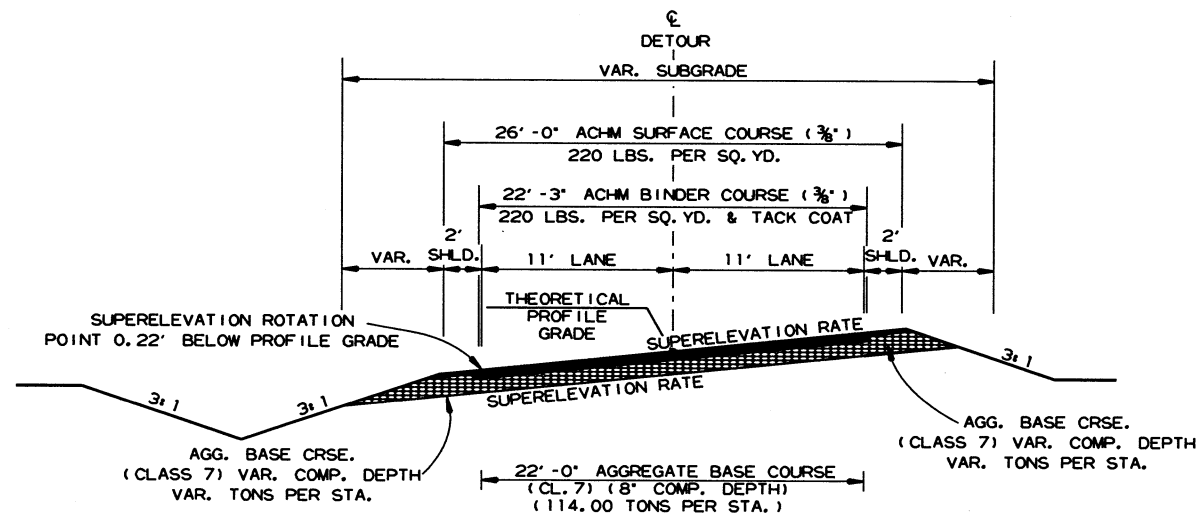

TYPICAL SECTIONS OF IMPROVEMENT DETOUR ROAD - SUPERELEVATION

CURVES ROTATE AROUND INSIDE EDGE
STA. 22+25.00 TO STA. 23+96.30
STA. 25+58.80 TO STA. 27+11.02

TYPICAL SECTIONS OF IMPROVEMENT

DATE REVISED	DATE FILMED	DATE REVISED	DATE FILMED	FED. PROJ. DIST. NO.	STATE	FED. AID PROJ. NO.	SHEET NO.	TOTAL SHEETS
				6	ARK.		6	49

2 SPECIAL DETAILS

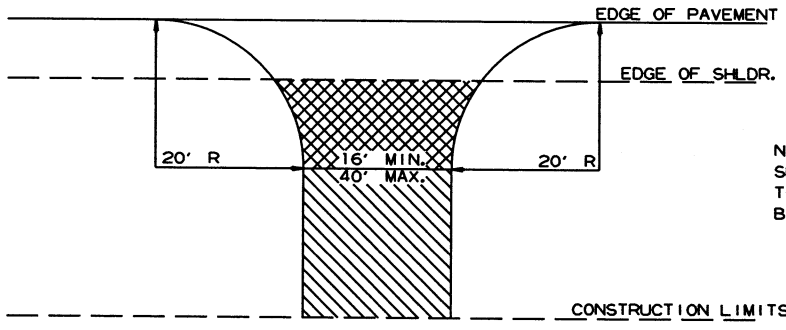
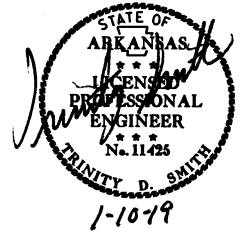

NOTE: TURNOUTS AND PRIVATE DRIVES SHALL BE MODIFIED WHERE NECESSARY TO MEET LOCAL CONDITIONS AS DIRECTED BY THE ENGINEER.

- ASPHALT CONCRETE HOT MIX SURFACE COURSE (220 LBS. PER SQ. YD.)
AGGREGATE BASE COURSE (CLASS 7)
7' COMP. DEPTH IF ASPHALT DRIVE EXIST OR
6' CONCRETE IF CONCRETE DRIVE EXIST.
- AGGREGATE BASE COURSE (CLASS 7)
9' COMP. DEPTH OR CONFORM
TO EXISTING DRIVEWAY

DETAIL FOR DRIVEWAY TURNOUTS
(COLLECTORS)

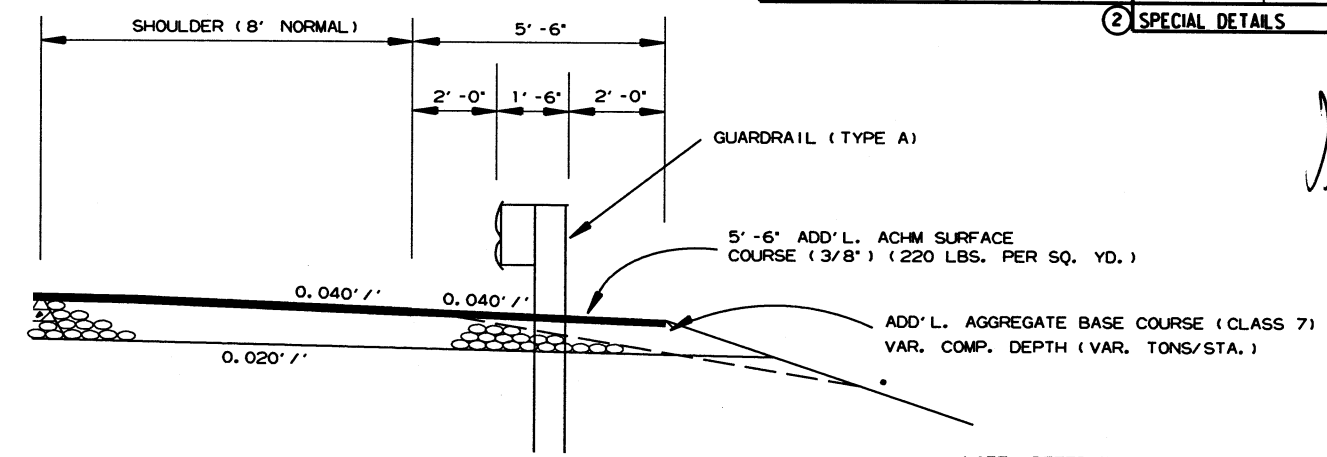

WIDENING FOR GUARDRAIL

NOTE: REFER TO STD. DWG. GR-9A AND CROSS SECTIONS FOR SLOPE REQUIREMENTS BEHIND GUARDRAIL.

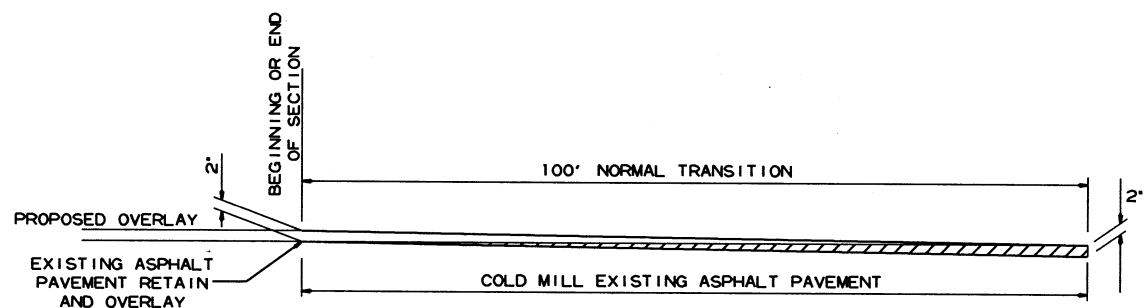

DETAIL FOR TRANSITIONS

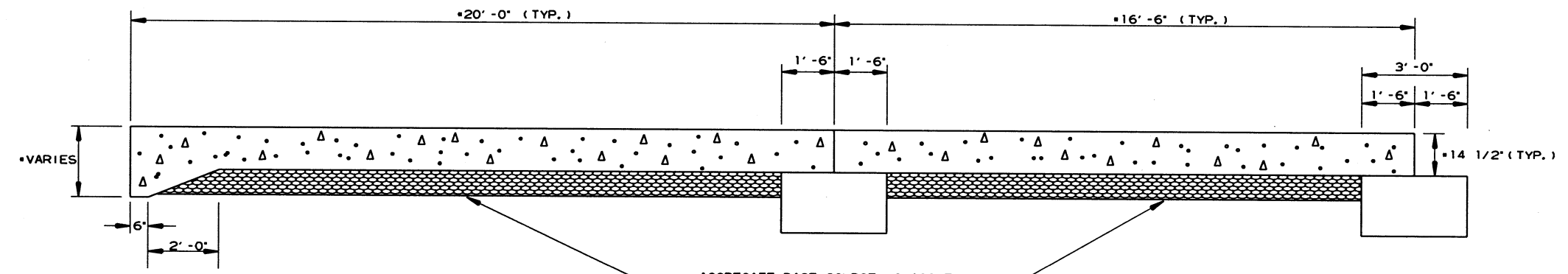

AGGREGATE BASE COURSE (CLASS 7)
VARIABLE - 6' MIN. COMPACTED DEPTH
SEE APPROACH SLAB DETAILS IN BRIDGE DRAWINGS

SECTION OF APPROACH SLAB

12/4/2018
R080506.DGN

REVISIONS

DATE OF REVISION	REVISION

LEGEND

- (E-3) FILTER SOCK
- (E-5) SAND BAG DITCH CHECKS
- (E-6) ROCK DITCH CHECKS
- (E-11) SILT FENCE

CLEARING AND GRUBBING
 FILTER SOCK (E-3)
 (2 LOCATIONS = 470 LIN. FT.)
 SAND BAG DITCH CHECKS (E-5)
 (4 LOCATIONS = 88 BAGS)
 ROCK DITCH CHECKS (E-6)
 (4 LOCATIONS = 12 CU. YDS.)
 SILT FENCE (E-11)
 (2 LOCATIONS = 2029 LIN. FT.)

DATE REVISED	DATE FILMED	DATE REVISED	DATE FILMED	FED. RD. DIST. NO.	STATE	FED. AID PROJ. NO.	SHEET NO.	TOTAL SHEETS
				6	ARK.		7	49

2 TEMPORARY EROSION CONTROL DETAILS

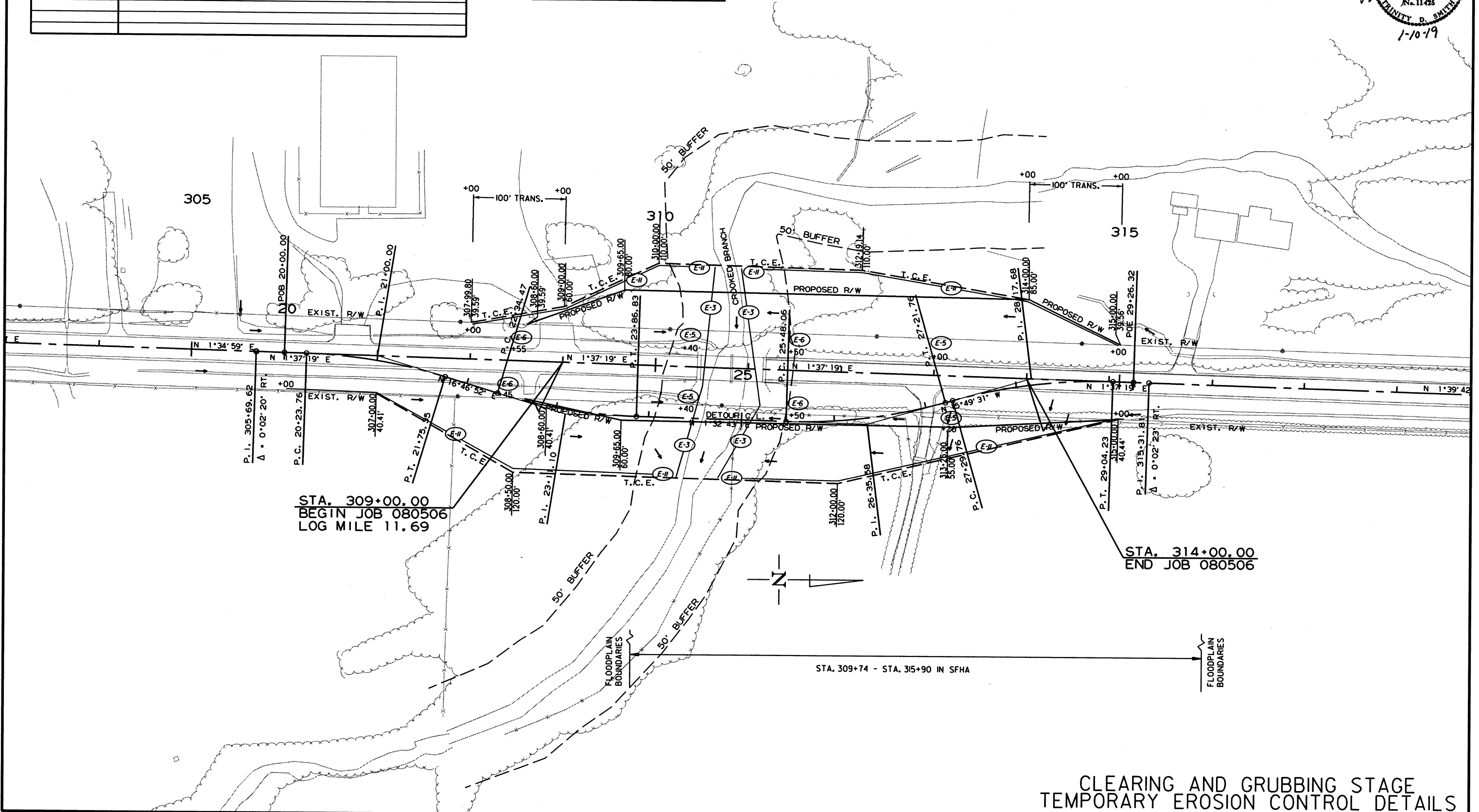
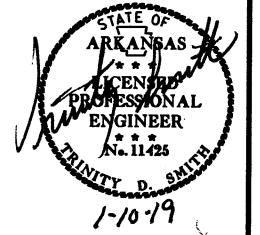

2/15/2018

R080506.DGN

CLEARING AND GRUBBING STAGE
 TEMPORARY EROSION CONTROL DETAILS

REVISIONS

DATE OF REVISION	REVISION

LEGEND

- (E-3) FILTER SOCK
- (E-5) SAND BAG DITCH CHECKS
- (E-6) ROCK DITCH CHECKS
- (E-H) SILT FENCE

DATE REVISED	DATE FILMED	DATE REVISED	DATE FILMED	FED. DIST. NO.	STATE	FED. AID PROJ. NO.	SHEET NO.	TOTAL SHEETS
				6	ARK.			
				JOB NO.	080506		8	49

② TEMPORARY EROSION CONTROL DETAILS

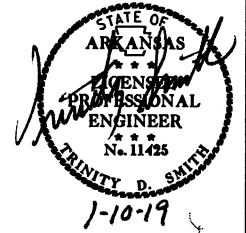

STAGE 1
 SAND BAG DITCH CHECKS (E-5)
 (3 LOCATIONS = 66 BAGS)
 ROCK DITCH CHECKS (E-6)
 (3 LOCATIONS = 9 CU. YDS.)

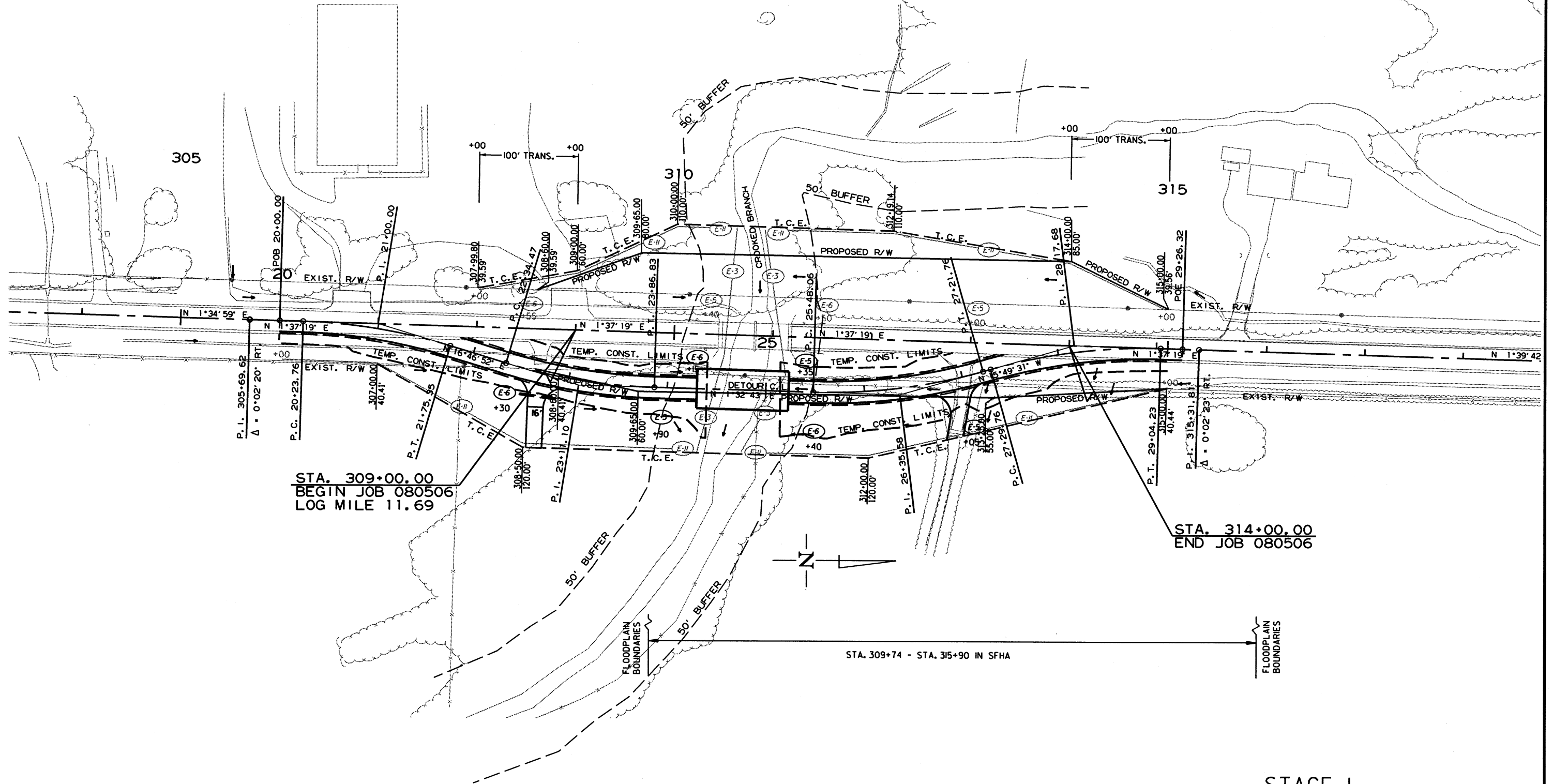

STA. 309+00.00
 BEGIN JOB 080506
 LOG MILE 11.69

STA. 314+00.00
 END JOB 080506

STA. 309+74 - STA. 315+90 IN SFHA

STAGE 1
 TEMPORARY EROSION CONTROL DETAILS

REVISIONS

DATE OF REVISION	REVISION

LEGEND

- (E-3) FILTER SOCK
- (E-5) SAND BAG DITCH CHECKS
- (E-6) ROCK DITCH CHECKS
- (E-4) SILT FENCE

DATE REVISED	DATE FILMED	DATE REVISED	DATE FILMED	FED. RD. DIST. NO.	STATE	FED. AID PROJ. NO.	SHEET NO.	TOTAL SHEETS
				6	ARK.		9	49

② TEMPORARY EROSION CONTROL DETAILS

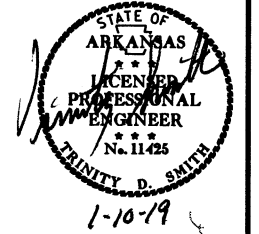

STAGE 2
 SAND BAG DITCH CHECKS (E-5)
 (2 LOCATIONS = 44 BAGS)
 ROCK DITCH CHECKS (E-6)
 (2 LOCATIONS = 6 CU. YDS.)

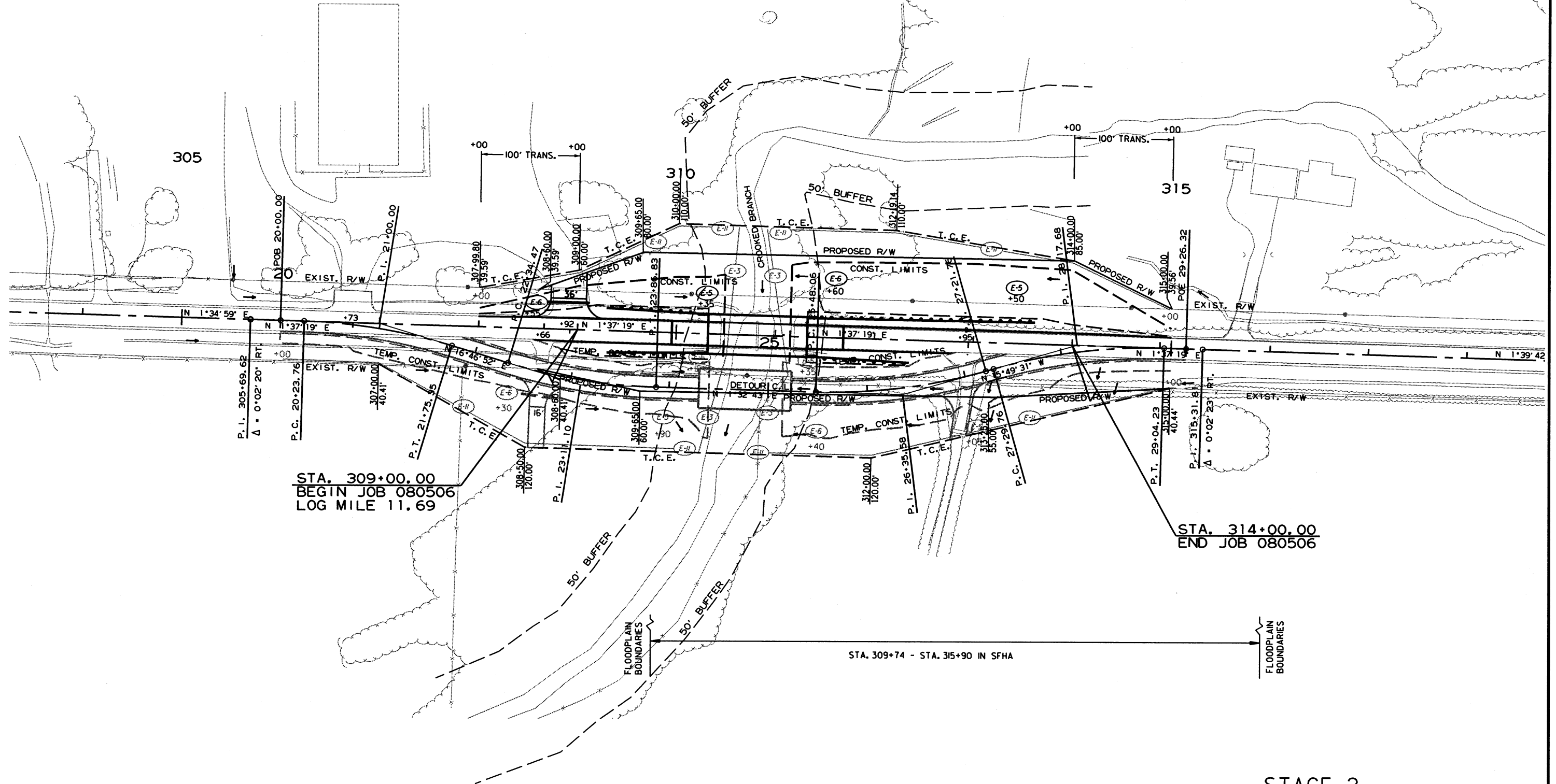

STA. 309+00.00
 BEGIN JOB 080506
 LOG MILE 11.69

STA. 314+00.00
 END JOB 080506

STA. 309+74 - STA. 315+90 IN SFHA

STAGE 2
 TEMPORARY EROSION CONTROL DETAILS

REVISIONS

DATE OF REVISION	REVISION

LEGEND

- (E-3) FILTER SOCK
- (E-5) SAND BAG DITCH CHECKS
- (E-6) ROCK DITCH CHECKS
- (E-H) SILT FENCE

DATE REVISED	DATE FILMED	DATE REVISED	DATE FILMED	FED. RD. DIST. NO.	STATE	FED. AID PROJ. NO.	SHEET NO.	TOTAL SHEETS
				6	ARK.			
				JOB NO.	080506		10	49

TEMPORARY EROSION CONTROL DETAILS

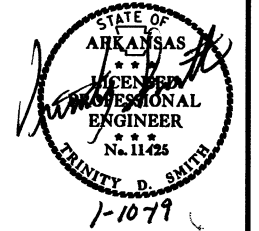

STAGE 3
 SAND BAG DITCH CHECKS (E-5)
 (2 LOCATIONS = 44 BAGS)
 ROCK DITCH CHECKS (E-6)
 (2 LOCATIONS = 6 CU. YDS.)

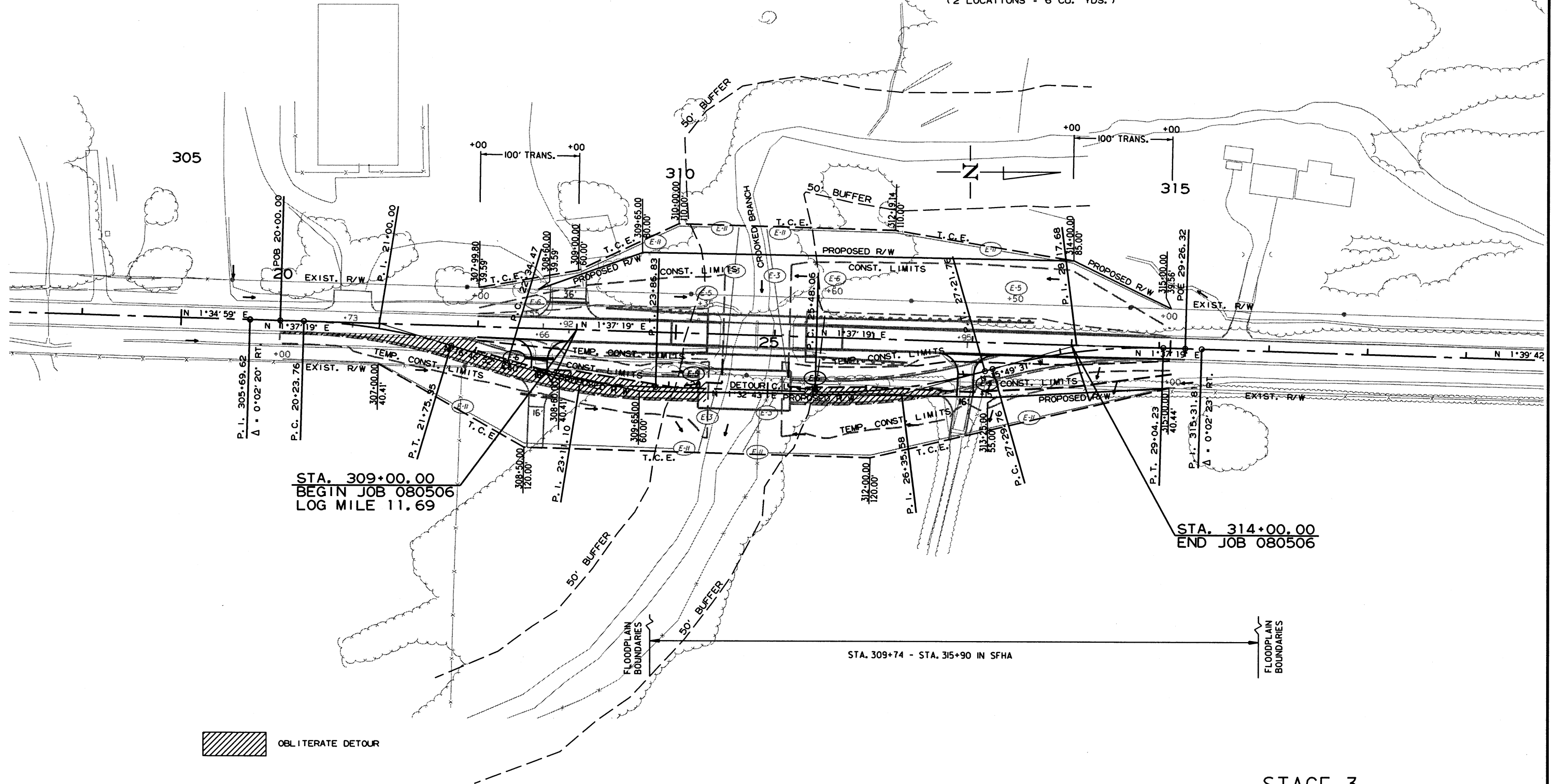

STA. 309+00.00
 BEGIN JOB 080506
 LOG MILE 11.69

STA. 314+00.00
 END JOB 080506

STA. 309+74 - STA. 315+90 IN SFHA

OBLITERATE DETOUR

STAGE 3
 TEMPORARY EROSION CONTROL DETAILS

DATE REVISED	DATE FILMED	DATE REVISED	DATE FILMED	FED. DIST. NO.	STATE	FED. AID PROJ. NO.	SHEET NO.	TOTAL SHEETS
				6	ARK.			
						JOB NO. 080506	11	49

② MAINTENANCE OF TRAFFIC DETAILS

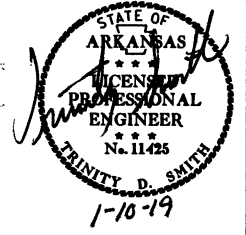

- DO NOT PASS (2) R4-1 (24" X 30")
- RIGHT SHOULDER CLOSED (2) W21-5a (36" X 36")

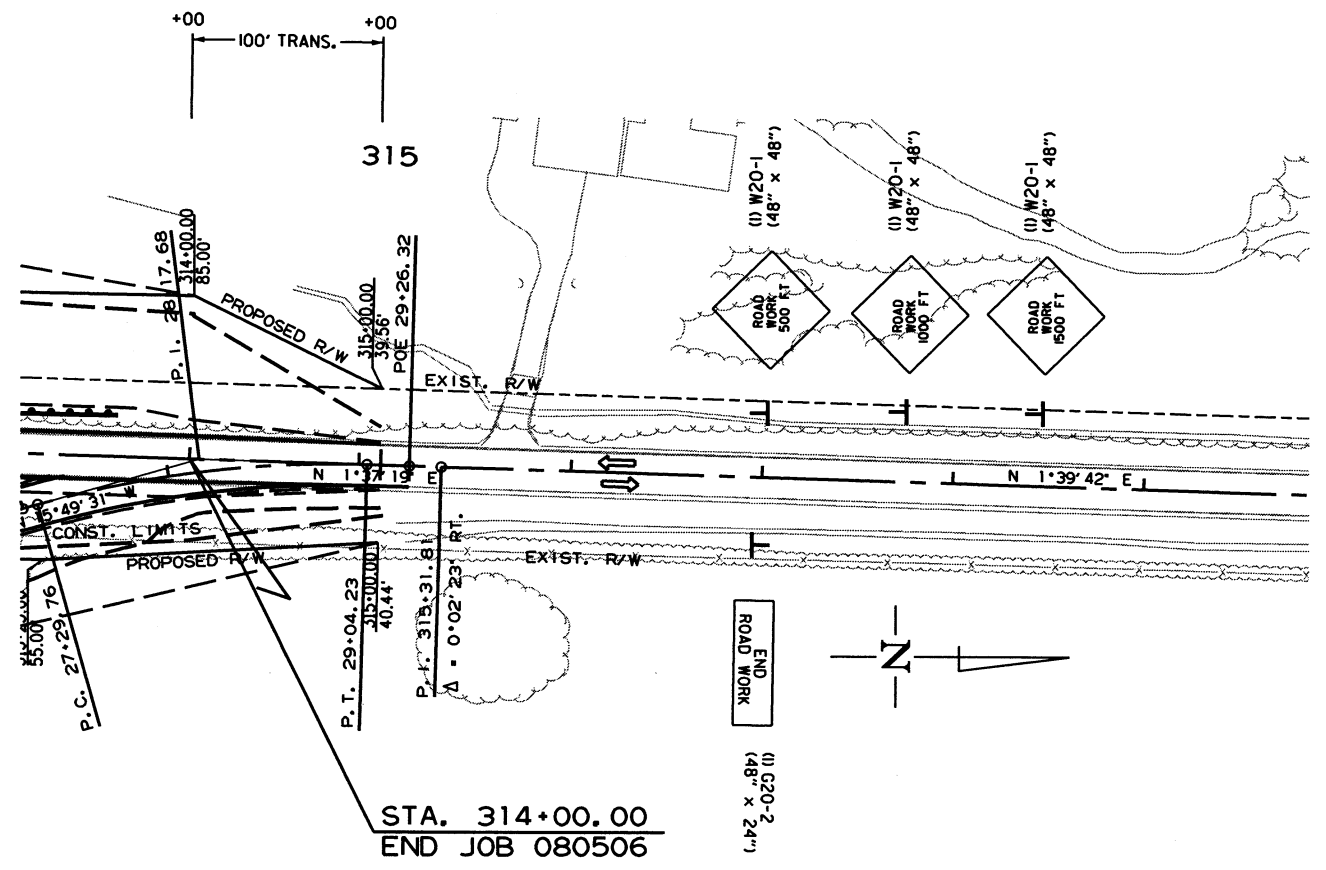
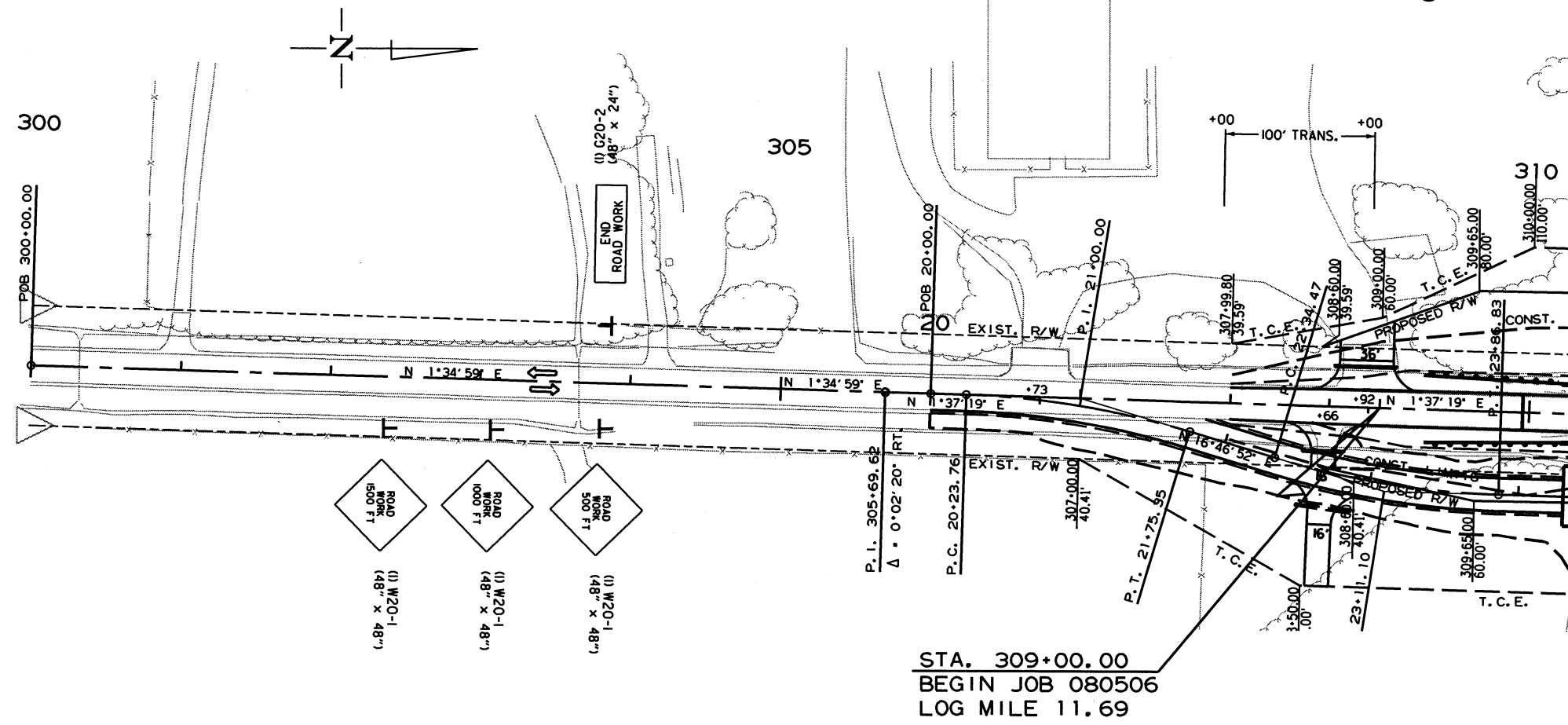

- SEQUENCE OF CONSTRUCTION
- STAGE 1:
MAINTAIN TRAFFIC ON EXISTING LANES.
CONSTRUCT DETOUR ON RT.
 - STAGE 2:
SHIFT TRAFFIC TO DETOUR CENTERLINE.
NOTCH AND WIDEN LT. SIDE FROM DETOUR.
CONSTRUCT DRIVES AND INSTALL SIDE DRAINS ON LT.
REMOVE EXISTING BRIDGE.
CONSTRUCT NEW BRIDGE.
 - STAGE 3:
SHIFT TRAFFIC TO CONSTRUCTION CENTERLINE.
OBLITERATE DETOUR.
NOTCH AND WIDEN ON RT.
BUILD DRIVES AND INSTALL SIDE DRAINS ON RT.
COLD MILL TRANSITION AREAS.
PLACE FINAL LAYER OF ACHM SURFACE COURSE.
INSTALL PERMANENT PAVEMENT MARKINGS.

MAIN LANES ALL STAGES
MAINTENANCE OF TRAFFIC DETAILS

DATE REVISED	DATE FILMED	DATE REVISED	DATE FILMED	FED. DIST. NO.	STATE	FED. PROJ. NO.	SHEET NO.	TOTAL SHEETS
				6	ARK.		12	49
				JOB NO.		080506		

② MAINTENANCE OF TRAFFIC DETAILS

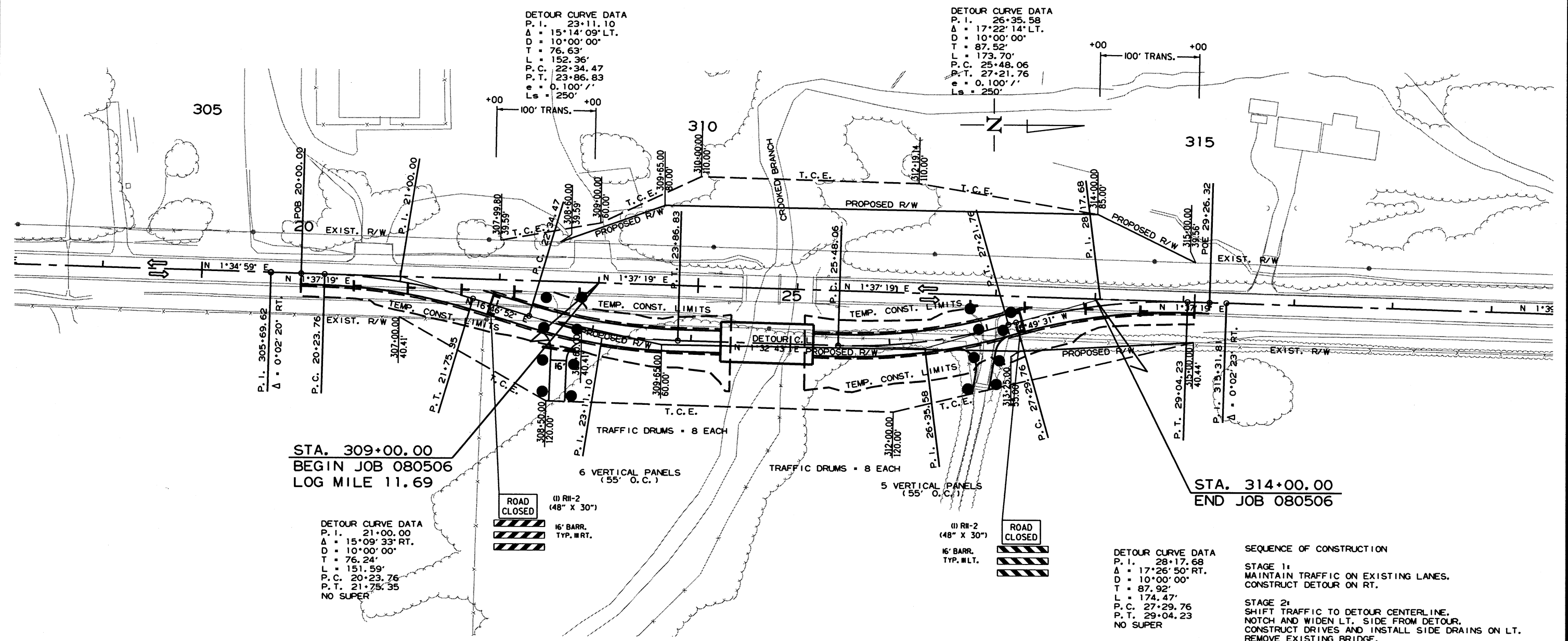
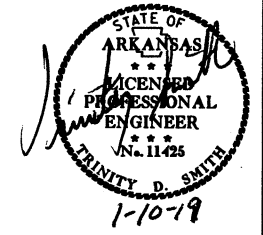

STA. 309+00.00
BEGIN JOB 080506
LOG MILE 11.69

STA. 314+00.00
END JOB 080506

DETOUR CURVE DATA
P. I. = 21+00.00
Δ = 15°09'33" RT.
D = 10'00'00"
T = 76.24'
L = 151.59'
P. C. = 20+23.76
P. T. = 21+75.35
NO SUPER

ROAD CLOSED
(1) RR-2 (48" X 30")
16' BARR. TYP. 1/2 RT.

ROAD CLOSED
(1) RR-2 (48" X 30")
16' BARR. TYP. 1/2 LT.

DETOUR CURVE DATA
P. I. = 28+17.68
Δ = 17°26'50" RT.
D = 10'00'00"
T = 87.92'
L = 174.47'
P. C. = 27+29.76
P. T. = 29+04.23
NO SUPER

SEQUENCE OF CONSTRUCTION

STAGE 1:
MAINTAIN TRAFFIC ON EXISTING LANES.
CONSTRUCT DETOUR ON RT.

STAGE 2:
SHIFT TRAFFIC TO DETOUR CENTERLINE.
NOTCH AND WIDEN LT. SIDE FROM DETOUR.
CONSTRUCT DRIVES AND INSTALL SIDE DRAINS ON LT.
REMOVE EXISTING BRIDGE.
CONSTRUCT NEW BRIDGE.

STAGE 3:
SHIFT TRAFFIC TO CONSTRUCTION CENTERLINE.
OBLITERATE DETOUR.
NOTCH AND WIDEN ON RT.
BUILD DRIVES AND INSTALL SIDE DRAINS ON RT.
COLD MILL TRANSITION AREAS.
PLACE FINAL LAYER OF AC+M SURFACE COURSE.
INSTALL PERMANENT PAVEMENT MARKINGS.

STAGE 1
MAINTENANCE OF TRAFFIC DETAILS

DATE REVISED	DATE FILMED	DATE REVISED	DATE FILMED	FED. RD. DIST. NO.	STATE	FED. AID PROJ. NO.	SHEET NO.	TOTAL SHEETS
				6	ARK.		13	49
JOB NO. 080506								

2 MAINTENANCE OF TRAFFIC DETAILS

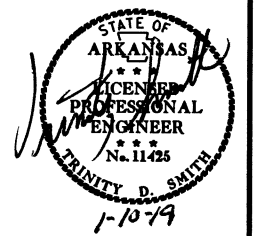

REMOVABLE CONSTRUCTION PAVEMENT MARKINGS
800 LIN. FT.
CONSTRUCTION PAVEMENT MARKINGS
2905 LIN. FT.
REMOVAL OF PERMANENT PAVEMENT MARKINGS
800 LIN. FT.

DETOUR CURVE DATA
P. I. 23+11.10
Δ = 15°14'09" LT.
D = 10°00'00"
T = 76.63'
L = 152.36'
P. C. 22+34.47
P. T. 23+86.83
e = 0.100' /'
Ls = 250'

DETOUR CURVE DATA
P. I. 26+35.58
Δ = 17°22'14" LT.
D = 10°00'00"
T = 87.52'
L = 173.70'
P. C. 25+48.06
P. T. 27+21.76
e = 0.100' /'
Ls = 250'

4 TRAFFIC DRUMS
(55' O.C.)

4 TRAFFIC DRUMS
(55' O.C.)

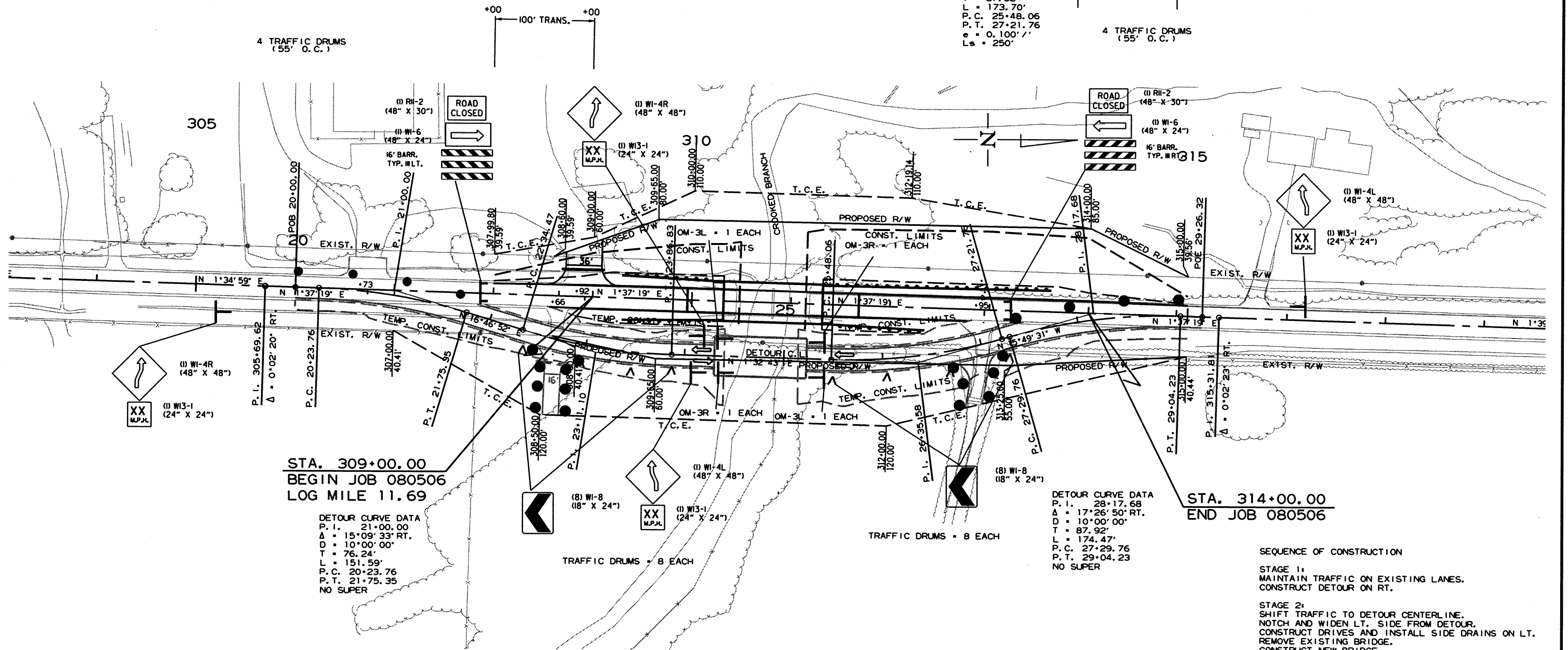

STA. 309+00.00
BEGIN JOB 080506
LOG MILE 11.69

STA. 314+00.00
END JOB 080506

DETOUR CURVE DATA
P. I. 21+00.00
Δ = 15°09'33" RT.
D = 10°00'00"
T = 76.24'
L = 151.59'
P. C. 20+23.76
P. T. 21+75.35
NO SUPER

DETOUR CURVE DATA
P. I. 28+17.68
Δ = 17°26'50" RT.
D = 10°00'00"
T = 87.92'
L = 174.47'
P. C. 27+29.76
P. T. 29+04.23
NO SUPER

SEQUENCE OF CONSTRUCTION

- STAGE 1:
MAINTAIN TRAFFIC ON EXISTING LANES.
CONSTRUCT DETOUR ON RT.
- STAGE 2:
SHIFT TRAFFIC TO DETOUR CENTERLINE.
NOTCH AND WIDEN LT. SIDE FROM DETOUR.
CONSTRUCT DRIVES AND INSTALL SIDE DRAINS ON LT.
REMOVE EXISTING BRIDGE.
CONSTRUCT NEW BRIDGE.
- STAGE 3:
SHIFT TRAFFIC TO CONSTRUCTION CENTERLINE.
OBLITERATE DETOUR.
NOTCH AND WIDEN ON RT.
BUILD DRIVES AND INSTALL SIDE DRAINS ON RT.
COLD MILL TRANSITION AREAS.
PLACE FINAL LAYER OF ACHM SURFACE COURSE.
INSTALL PERMANENT PAVEMENT MARKINGS.

STAGE 2
MAINTENANCE OF TRAFFIC DETAILS

DATE REVISED	DATE FILMED	DATE REVISED	DATE FILMED	FED. DIST. NO.	STATE	FED. AID PROJ. NO.	SHEET NO.	TOTAL SHEETS
				6	ARK.			
						JOB NO. 080506	14	49

REMOVAL OF CONSTRUCTION PAVEMENT MARKINGS
800 LIN. FT.
CONSTRUCTION PAVEMENT MARKINGS
3600 LIN. FT.

② MAINTENANCE OF TRAFFIC DETAILS

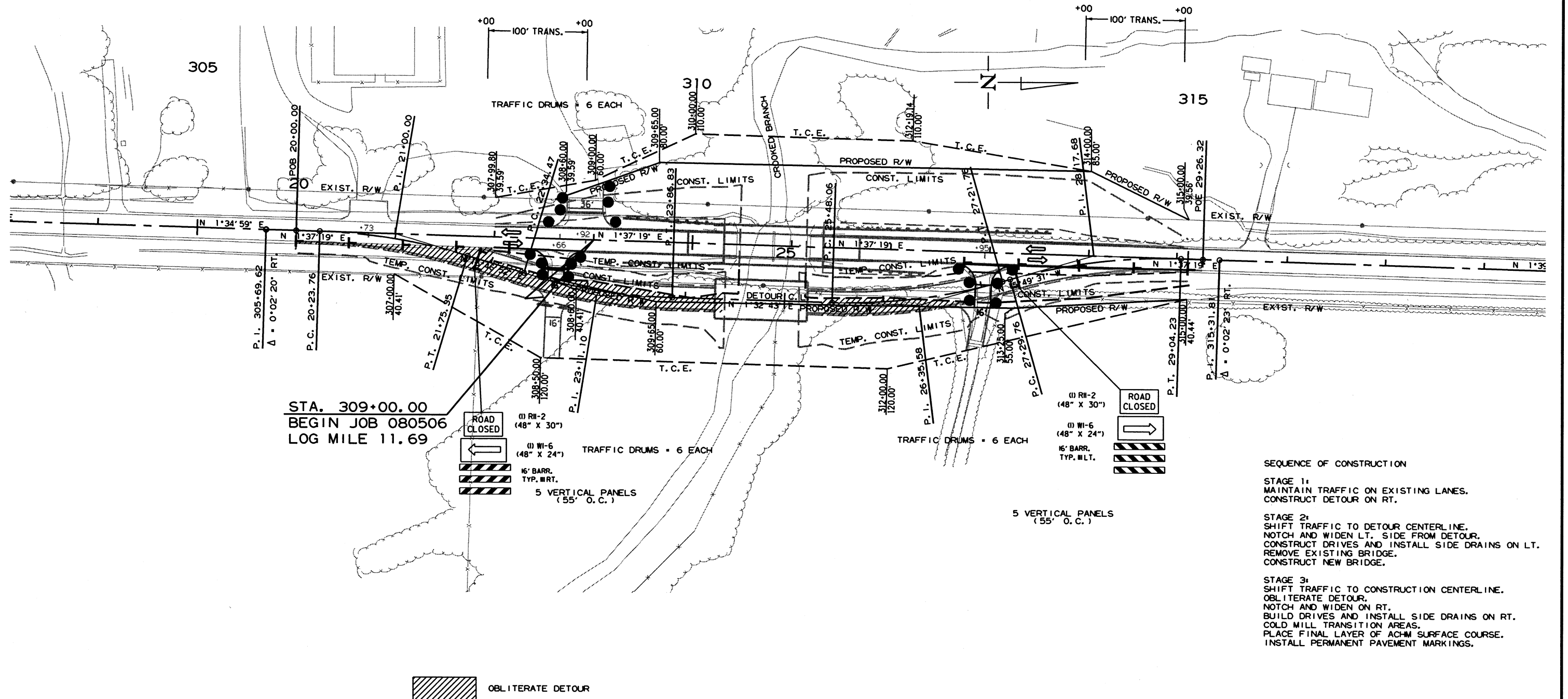
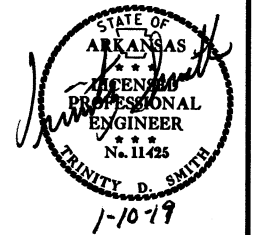

STA. 309+00.00
BEGIN JOB 080506
LOG MILE 11.69

- (1) RH-2 (48" X 30")
- (1) WI-6 (48" X 24")
- 16' BARR. TYP. WLT.
- 5 VERTICAL PANELS (55' O.C.)
- TRAFFIC DRUMS - 6 EACH

- (1) RH-2 (48" X 30")
- (1) WI-6 (48" X 24")
- 16' BARR. TYP. WLT.
- ROAD CLOSED

SEQUENCE OF CONSTRUCTION

STAGE 1:
MAINTAIN TRAFFIC ON EXISTING LANES.
CONSTRUCT DETOUR ON RT.

STAGE 2:
SHIFT TRAFFIC TO DETOUR CENTERLINE.
NOTCH AND WIDEN LT. SIDE FROM DETOUR.
CONSTRUCT DRIVES AND INSTALL SIDE DRAINS ON LT.
REMOVE EXISTING BRIDGE.
CONSTRUCT NEW BRIDGE.

STAGE 3:
SHIFT TRAFFIC TO CONSTRUCTION CENTERLINE.
OBLITERATE DETOUR.
NOTCH AND WIDEN ON RT.
BUILD DRIVES AND INSTALL SIDE DRAINS ON RT.
COLD MILL TRANSITION AREAS.
PLACE FINAL LAYER OF ACHM SURFACE COURSE.
INSTALL PERMANENT PAVEMENT MARKINGS.

OBLITERATE DETOUR

STAGE 3
MAINTENANCE OF TRAFFIC DETAILS

DATE REVISED	DATE FILMED	DATE REVISED	DATE FILMED	FED. RD. DIST. NO.	STATE	FED. AID PROJ. NO.	SHEET NO.	TOTAL SHEETS
				6	ARK.			
				JOB NO.	080506		15	49

② PERMANENT PAVEMENT MARKING DETAILS

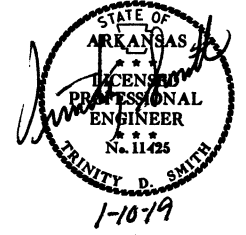

THE 6" YELLOW STRIPING QUANTITY HAS BEEN ESTIMATED BASED ON A DOUBLE YELLOW CENTERLINE STRIPE FOR THE ENTIRE PROJECT. THE PROJECT MUST BE MARKED FOR PASSING/NO PASSING ZONES PRIOR TO THE PLACEMENT OF ANY FINAL STRIPING. CONTACT THE MAINTENANCE DIVISION AFTER THE FINAL LIFT OF SURFACE COURSE HAS BEEN PLACED TO SCHEDULE THE ZONING OF THE PROJECT.

QUANTITIES:

THERMOPLASTIC PAVEMENT MARKINGS
 6" YELLOW DBL. = 1800 LIN. FT.
 6" WHITE SOLID = 1800 LIN. FT.

RAISED PAVEMENT MARKERS (TYPE II) (80' O.C.)
 YELLOW/YELLOW = 11 EACH

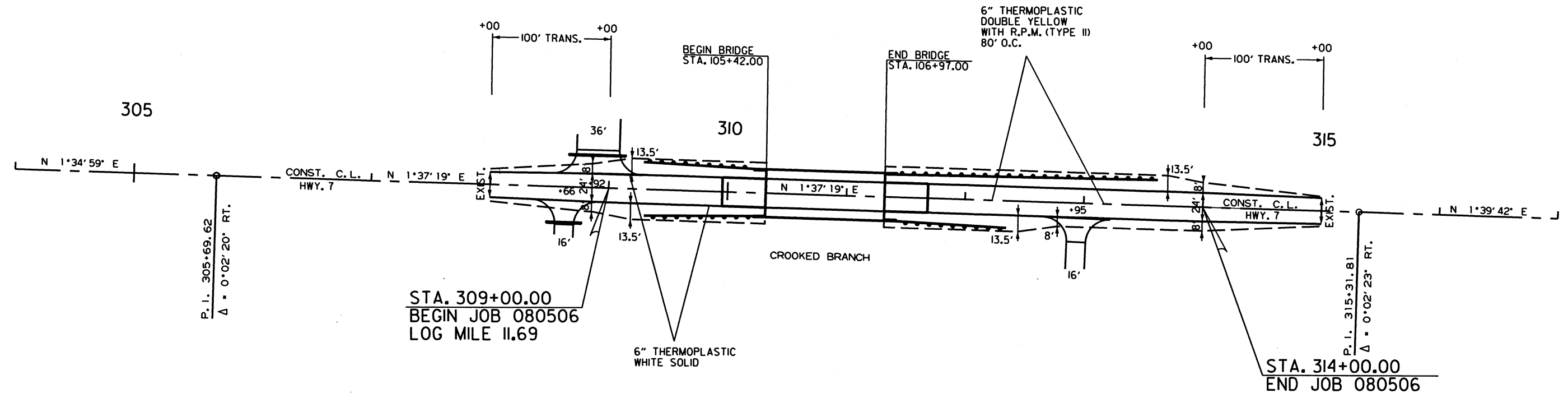
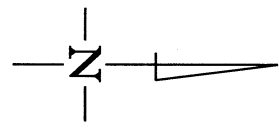

12/4/2018
 R080506.DGN

DATE REVISED	DATE FILMED	DATE REVISED	DATE FILMED	FED. RD. DIST. NO.	STATE	FED. AID PROJ. NO.	SHEET NO.	TOTAL SHEETS
				6	ARK.			
				JOB NO.	080506		16	49

② QUANTITIES



ADVANCE WARNING SIGNS AND DEVICES

SIGN NUMBER	DESCRIPTION	SIGN SIZE	STAGE 1	STAGE 2	STAGE 3	END OF JOB	MAXIMUM NUMBER REQUIRED	TOTAL SIGNS REQUIRED		VERTICAL PANELS	TRAFFIC DRUMS	BARRICADES (TYPE III)		
								NO.	SQ. FT.			EACH	RIGHT	LEFT
W20-1	ROAD WORK 1500 FT.	48"x48"	2	2	2	2	2	2	32.0					
W20-1	ROAD WORK 1000 FT.	48"x48"	2	2	2	2	2	2	32.0					
W20-1	ROAD WORK 500 FT.	48"x48"	2	2	2	2	2	2	32.0					
G20-2	END ROAD WORK	48"x24"	2	2	2	2	2	2	16.0					
W1-4AR	REVERSE CURVE RT.	48"x48"		2			2	2	32.0					
W1-4AL	REVERSE CURVE LT.	48"x48"		2			2	2	32.0					
W13-1	SPEED LIMIT (ADVISORY)	24"x24"		4			4	4	16.0					
R11-2	ROAD CLOSED	48"x30"	2	2	2		2	2	20.0					
OM-3L	OBJECT MARKER	12"x36"		2			2	2	6.0					
OM-3R	OBJECT MARKER	12"x36"		2			2	2	6.0					
W1-6	LARGE ARROW	48"x24"		2	2		2	2	16.0					
W1-8	CHEVRONS	18"x24"		16			16	16	48.0					
R4-1	DO NOT PASS	24"x30"	2	2	2	2	2	2	10.0					
W21-5a	RIGHT SHOULDER CLOSED	36"x36"	2	2	2	2	2	2	18.0					
	VERTICAL PANELS		11		10		11			11				
	TRAFFIC DRUMS		16	24	18		24			24				
	TYPE III BARRICADE-RT. (16')		1	1	1		1				16			
	TYPE III BARRICADE-LT. (16')		1	1	1		1					16		
TOTALS:								316.0	11	24	16	16		

NOTE: THIS IS A HIGH TRAFFIC VOLUME ROAD AS DEFINED IN SECTION 604.03, STANDARD SPECIFICATIONS FOR HIGHWAY CONSTRUCTION.

THE QUANTITY OF VERTICAL PANELS PROVIDED IN THE CONTRACT IS FOR ONE SIDE OF THE ROADWAY FOR THE FULL LENGTH OF THE JOB. THIS IS THE MAXIMUM QUANTITY REQUIRED TO ALLOW THE CONTRACTOR TO NOTCH ONE MILE, BACKFILL TO A POINT WHERE THE VERTICAL DIFFERENTIAL IS 4" OR LESS, AND THEN NOTCH ANOTHER ONE-MILE SECTION. THIS IS THE MAXIMUM NUMBER OF VERTICAL PANELS THAT WILL BE PAID FOR. REFER TO SECTION 603.02 OF THE STANDARD SPECIFICATIONS FOR CONSTRUCTION REQUIREMENTS.

CONSTRUCTION PAVEMENT MARKINGS AND PERMANENT PAVEMENT MARKINGS

DESCRIPTION	STAGE 1	STAGE 2	STAGE 3	END OF JOB	REMOVAL OF PERMANENT PAVEMENT MARKINGS	CONSTRUCTION PAVEMENT MARKINGS	REMOVAL OF CONSTRUCTION PAVEMENT MARKINGS	REMOVABLE CONSTRUCTION PAVEMENT MARKINGS	RAISED PAVEMENT MARKERS		THERMOPLASTIC PAVEMENT MARKING	
									TYPE II		6"	
									(YELLOW/YELLOW)	EACH	WHITE	YELLOW
					LIN. FT.			LIN. FT.		LIN. FT.		
REMOVAL OF PERMANENT PAVEMENT MARKINGS		800			800							
CONSTRUCTION PAVEMENT MARKINGS		2905	3600			6505						
REMOVAL OF CONSTRUCTION PAVEMENT MARKINGS			800				800					
REMOVABLE CONSTRUCTION PAVEMENT MARKINGS		800						800				
RAISED PAVEMENT MARKERS TYPE II (YELLOW/YELLOW)				11					11			
THERMOPLASTIC PAVEMENT MARKING WHITE (6")				1800						1800		
THERMOPLASTIC PAVEMENT MARKING YELLOW (6")				1800							1800	
TOTALS:					800	6505	800	800	11	1800	1800	

NOTE: THIS IS A HIGH TRAFFIC VOLUME ROAD AS DEFINED IN SECTION 604.03, STANDARD SPECIFICATIONS FOR HIGHWAY CONSTRUCTION.

NOTE: THE 6" YELLOW STRIPING QUANTITY HAS BEEN ESTIMATED BASED ON A DOUBLE YELLOW CENTERLINE STRIPE FOR THE ENTIRE PROJECT. THE PROJECT MUST BE MARKED FOR PASSING/NO PASSING ZONES PRIOR TO THE PLACEMENT OF ANY FINAL STRIPING. CONTACT THE MAINTENANCE DIVISION AFTER THE FINAL LIFT OF SURFACE COURSE HAS BEEN PLACED TO SCHEDULE THE ZONING OF THE PROJECT.

12/18/2018

R080506.DGN

QUANTITIES

DATE REVISED	DATE FILMED	DATE REVISED	DATE FILMED	FED. RD. DIST. NO.	STATE	FED. AID PROJ. NO.	SHEET NO.	TOTAL SHEETS
				6	ARK.		17	49
				JOB NO.	080506			

SOIL LOG

STATION	LATITUDE			LONGITUDE			LOCATION	DEPTH FEET	LIQUID LIMIT	PLASTICITY INDEX	AASHTO CLASSIFICATION	COLOR
	DEG	MIN	SEC	DEG	MIN	SEC						
308+00	35	25	38.10	93	8	4.90	6' RT.	0-5	28	10	A-4(3)	BROWN
308+00	35	25	38.10	93	8	4.80	18' RT.	0-5	ND	NP	A-4(0)	BROWN
308+00	35	25	38.10	93	8	4.80	18' RT.	0-5	26	7	A-4(2)	BROWN
314+00	35	25	43.80	93	8	5.00	6' LT.	0-5	ND	NP	A-4(0)	BROWN
314+00	35	25	43.80	93	8	5.10	18' LT.	0-5	24	8	A-4(1)	BROWN

SOIL CHARACTERISTICS TABULATED ABOVE ARE REPRESENTATIVE AT THE LOCATION OF THE SAMPLE, AND FROM SURFACE INDICATIONS ARE TYPICAL FOR THE LIMITS SHOWN. THESE DATA ARE SHOWN FOR INFORMATION ONLY. THE STATE WILL NOT BE RESPONSIBLE FOR VARIATIONS IN THE SOIL CHARACTERISTICS AND/OR EXTENT OF SAME DIFFERING FROM THE ABOVE TABULATIONS.
 Z- AUGER REFUSAL
 NP - NON-PLASTIC
 ND - NOT DETERMINABLE

BENCH MARKS

STATION	LOCATION	BENCH MARKS
		EACH
310+32.00	BRIDGE END	1
TOTAL:		1

NOTE: SHOWN FOR INFORMATION ONLY. BENCH MARKS SHALL BE FURNISHED AND PLACED BY STATE FORCES.

CLEARING AND GRUBBING

STATION	STATION	LOCATION	CLEARING	GRUBBING
			STATION	STATION
308+00	315+00	HWY. 7	7	7
TOTALS:			7	7

REMOVAL AND DISPOSAL OF CULVERTS

STATION	DESCRIPTION	PIPE CULVERTS
		EACH
308+66	18" X 21' C.M. PIPE CULVERT ON RT.	1
308+92	18" X 49' B.P. PIPE CULVERT ON LT.	1
TOTAL:		2

NOTE: QUANTITIES SHOWN ABOVE SHALL INCLUDE REMOVAL & DISPOSAL OF ALL HEADWALLS AND FLARED END SECTIONS IF APPLICABLE.

REMOVAL AND DISPOSAL OF FENCE

STATION	STATION	LOCATION	FENCE
			LIN. FT.
307+03	307+85	HWY. 7 RT.	126
310+83	314+88	HWY. 7 RT.	537
TOTAL:			663

REMOVAL AND DISPOSAL OF ITEMS

STATION	STATION	LOCATION	SIGN FOUNDATIONS	GUARDRAIL	SIGNS
			EACH	LIN. FT.	EACH
308+17		HWY. 7 LT.	2		1
309+25		HWY. 7 LT.	1		1
310+08	311+53	HWY. 7 RT.		145	
310+10	311+53	HWY. 7 LT.		143	
TOTALS:			3	288	2

NOTE: THE QUANTITY SHOWN ABOVE FOR THE REMOVAL AND DISPOSAL OF GUARDRAIL SHALL INCLUDE THE REMOVAL AND DISPOSAL OF ALL GUARDRAIL TERMINALS AND TERMINAL ANCHOR POSTS.

CONCRETE DITCH PAVING

STATION	STATION	LOCATION	LENGTH		CONC. DITCH PAVING (TYPE B)	SOLID SODDING	WATER
			LIN. FT.	FEET			
309+50.00	310+32.00	RT. DITCH GRADE	82.00	9.00	82.00	36.44	0.46
310+00.00	310+32.00	LT. DITCH GRADE	32.00	9.00	32.00	14.22	0.18
TOTALS:					114.00	50.66	0.64

BASIS OF ESTIMATE:
 WATER.....12.6 GAL. / SQ. YD. OF SOLID SODDING.

ASPHALT CONCRETE PATCHING FOR MAINTENANCE OF TRAFFIC

LOCATION	TON	TACK COAT
		GALLON
ENTIRE PROJECT - TO BE USED IF AND WHERE DIRECTED BY THE ENGINEER	3	6
TOTALS:		3 6

NOTE: QUANTITIES ESTIMATED. SEE SECTION 104.03 OF THE STD. SPECS.
 BASIS OF ESTIMATE:
 ASPHALT CONCRETE PATCHING FOR MAINTENANCE OF TRAFFIC...25 TON/MILE
 TACK COAT FOR MAINTENANCE OF TRAFFIC.....50 GAL./MILE

ACHM PATCHING OF EXISTING ROADWAY

DESCRIPTION	TON
ENTIRE PROJECT - TO BE USED IF AND WHERE DIRECTED BY THE ENGINEER	50
TOTAL:	50

NOTE: QUANTITY ESTIMATED. SEE SECTION 104.03 OF THE STD. SPECS.

4" PIPE UNDERDRAIN

STATION	STATION	LOCATIONS	4" PIPE UNDERDRAINS	UNDERDRAIN OUTLET PROTECTORS
			LIN. FT.	EACH
ENTIRE PROJECT TO BE USED IF AND WHERE DIRECTED BY THE ENGINEER			600	6
TOTALS:			600	6

NOTE: QUANTITIES ESTIMATED. SEE SECTION 104.03 OF THE STD. SPECS.

FENCING

STATION	STATION	LOCATION	WIRE FENCE (TYPE D-1)	* 16'-0" GATES
			LIN. FT.	EACH
307+03	307+85	HWY. 7 RT.	126	
310+83	314+88	HWY. 7 RT.	521	1
TOTALS:			647	1

* DENOTES ALTERNATE BID ITEM.

COLD MILLING ASPHALT PAVEMENT

STATION	STATION	LOCATION	AVG. WIDTH	COLD MILLING ASPHALT PAVEMENT
			FEET	SQ. YD.
308+00.00	309+00.00	MAIN LANES	22.00	244.44
314+00.00	315+00.00	MAIN LANES	22.00	244.44
TOTAL:				488.88

NOTE: AVERAGE MILLING DEPTH 1".

QUANTITIES

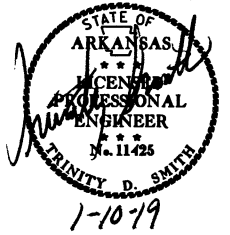

DATE REVISED	DATE FILMED	DATE REVISED	DATE FILMED	FED. DIST. NO.	STATE	FED. AID PROJ. NO.	SHEET NO.	TOTAL SHEETS
				6	ARK.			
				JOB NO.	080506		18	49

② QUANTITIES

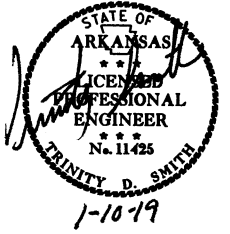

EROSION CONTROL

STATION	STATION	LOCATION	PERMANENT EROSION CONTROL					TEMPORARY EROSION CONTROL										
			SEEDING	LIME	MULCH COVER	WATER	SECOND SEEDING APPLICATION	TEMPORARY SEEDING	MULCH COVER	WATER	FILTER SOCK (12") DITCH CHECKS	SAND BAG DITCH CHECKS	ROCK DITCH CHECKS	SILT FENCE	SEDIMENT BASIN	OBLITERATION OF SEDIMENT BASIN	*SEDIMENT REMOVAL & DISPOSAL	
			ACRE	TON	ACRE	M.GAL.	ACRE	ACRE	ACRE	M.GAL.	(E-3) LIN. FT.	(E-5) BAG	(E-6) CU. YD.	(E-11) LIN. FT.	(E-14) CU. YD.	CU. YD.	CU. YD.	
ENTIRE PROJECT		CLEARING AND GRUBBING																
ENTIRE PROJECT		STAGE 1							3.03	3.03	61.8	470	88	12	2029		83	
ENTIRE PROJECT		STAGE 2							0.93	0.93	19.0		66	9			6	
ENTIRE PROJECT		STAGE 3							0.84	0.84	17.1		44	6			4	
ENTIRE PROJECT		STAGE 3	0.89	1.78	0.89	90.8	0.89		0.93	0.93	19.0		44	6			4	
*ENTIRE PROJECT TO BE USED IF AND WHERE DIRECTED BY THE ENGINEER.			0.11	0.22	0.11	11.2	0.11					230	66	9	500	200	200	225
TOTALS:			1.00	2.00	1.00	102.0	1.00		5.73	5.73	116.9	700	308	42	2529	200	200	322

BASIS OF ESTIMATE:
 LIME 2 TONS / ACRE OF SEEDING
 WATER 102.0 M.G. / ACRE OF SEEDING
 WATER 20.4 M.G. / ACRE OF TEMPORARY SEEDING
 SAND BAG DITCH CHECKS 22 BAGS / LOCATION
 ROCK DITCH CHECKS 3 CU.YD./LOCATION

NOTE: THE TEMPORARY EROSION CONTROL DEVICES SHOWN ABOVE AND ON THE PLANS SHALL BE INSTALLED IN SUCH A SEQUENCE AS TO DETER EROSION AND SEDIMENTATION ON U.S. WATERWAYS AS EXPLAINED BY THE NATIONAL POLLUTANT DISCHARGE ELIMINATION SYSTEM PERMIT.

*QUANTITIES ESTIMATED.
 SEE SECTION 104.03 OF THE STD. SPECS.

APPROACH GUTTERS AND SLABS

STATION	STATION	LOCATION	APPROACH GUTTER (TYPE SPECIAL)	APPROACH SLABS (TYPE C1)	REINFORCING STEEL-RDWY. (GR. 60)	AGGREGATE BASE CRS. (CLASS 7)
			CU.YD.	CU.YD.	POUND	TON
309+95.50	310+32.00	LT. SIDE	14.20		770	
309+95.50	310+32.00	MAIN LANE		49.15	5775	34.1
309+95.50	310+32.00	RT. SIDE	14.20		770	
311+32.00	311+68.50	LT. SIDE	14.20		770	
311+32.00	311+68.50	MAIN LANE		49.15	5775	34.1
311+32.00	311+68.50	RT. SIDE	14.20		770	
TOTALS:			56.80	98.30	14630	68.2

NOTE: USE T=13.5" FOR 8' SHOULDER.

GUARDRAIL

STATION	STATION	LOCATION	GUARDRAIL (TYPE A)	THREE BEAM GUARDRAIL TERMINAL	GUARDRAIL TERMINAL (TYPE 2)
			LIN. FT.	EACH	
309+28.85	310+22.60	LT. SIDE	25	1	1
309+28.85	310+22.60	RT. SIDE	25	1	1
311+41.40	313+60.15	LT. SIDE	150	1	1
311+41.40	312+35.15	RT. SIDE	25	1	1
TOTALS:			225	4	4

EARTHWORK

STATION	STATION	LOCATION / DESCRIPTION	UNCLASSIFIED EXCAVATION	COMPACTED EMBANKMENT	* SOIL STABILIZATION
			CU. YD.	CU. YD.	TON
ENTIRE PROJECT		STAGE 1-MAIN LANES	194	2725	
ENTIRE PROJECT		STAGE 2-MAIN LANES	1028	1008	
ENTIRE PROJECT		STAGE 3-MAIN LANES	3381	159	
ENTIRE PROJECT		APPROACHES	5	40	
ENTIRE PROJECT		TEMPORARY APPROACHES		220	
ENTIRE PROJECT		BRIDGE EXCAVATION	190		
ENTIRE PROJECT		TO BE USED IF AND WHERE DIRECTED BY THE ENGINEER			100
TOTALS:			4798	4152	100

* QUANTITY ESTIMATED.
 SEE SECTION 104.03 OF THE STD. SPECS.

NOTE: EARTHWORK QUANTITIES SHOWN ABOVE SHALL BE PAID AS PLAN QUANTITY.

STRUCTURES

STATION	DESCRIPTION	TEMPORARY CULVERTS	STD. DWG. NOS.
		18" LIN. FT.	
22+75	INSTALL TEMPORARY PIPE CULVERT ON RT.	38	PCC-1 AND PCM-1
TOTAL:		38	

NOTE: FOR R.C. PIPE CULVERT INSTALLATIONS USE TYPE 3 BEDDING UNLESS OTHERWISE SPECIFIED.

NOTE: FOR C.M. PIPE CULVERT INSTALLATIONS USE TYPE 2 BEDDING UNLESS OTHERWISE SPECIFIED.

12/18/2018

RO80506.DGN

DATE REVISED	DATE FILMED	DATE REVISED	DATE FILMED	FED. DIST. NO.	STATE	FED. AID PROJ. NO.	SHEET NO.	TOTAL SHEETS
				6	ARK.		19	49
				JOB NO.	080506			

② QUANTITIES

STATION	SIDE	LOCATION	WIDTH FEET	ACHM SURFACE COURSE (1/2") 220 LBS. PER SQ. YD. (PG 64-22)		AGGREGATE BASE COURSE (CLASS 7) TON	SIDE DRAINS		STANDARD DRAWINGS
				SQ. YD.	TON		18"	21"X15"	
308+66	RT.	HWY. 7 DRIVEWAY	16	44.80	4.93	27.53	28		PCC-1, PCM-1, PCP-1, PCP-2
308+92	LT.	HWY. 7 DRIVEWAY	36	84.80	9.33	76.21		42	PCC-1, PCM-1, PCP-1, PCP-2
312+95	RT.	HWY. 7 DRIVEWAY	16	44.80	4.93	39.57			
ENTIRE PROJECT TEMPORARY DRIVES						110.00			
TOTALS:				174.40	19.19	253.31	28	42	

BASIS OF ESTIMATE:
 ACHM SURFACE COURSE (1/2").....94.5% MIN. AGGR.....5.5% ASPHALT BINDER
 MAXIMUM NUMBER OF GYRATIONS = 115 FOR PG 64-22

* QUANTITY ESTIMATED
 SEE SECTION 104.03 OF THE STD. SPECS.
 TO BE USED IF AND WHERE DIRECTED BY THE ENGINEER.

NOTE: FOR R.C. PIPE CULVERT INSTALLATIONS USE TYPE 3 BEDDING UNLESS OTHERWISE SPECIFIED.
 NOTE: FOR C.M. PIPE CULVERT INSTALLATIONS USE TYPE 2 BEDDING UNLESS OTHERWISE SPECIFIED.

LOCATION	SELECTED PIPE BEDDING CU.YD.
ENTIRE PROJECT TO BE USED IF AND WHERE DIRECTED BY THE ENGINEER	10
TOTAL:	10

NOTE: QUANTITY ESTIMATED.
 SEE SECTION 104.03 OF THE STD. SPECS.

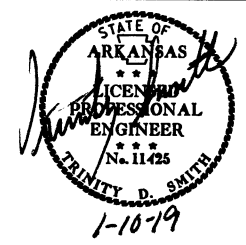

BASE AND SURFACING

STATION	STATION	LOCATION	LENGTH FEET	AGGREGATE BASE COURSE (CLASS 7)		TACK COAT					ACHM BINDER COURSE (1")				ACHM SURFACE COURSE (3/8")										
				TON / STATION	TON	(0.05 GAL. PER SQ. YD.)			(0.17 GAL. PER SQ. YD.)		TOTAL GALLONS	AVG. WID. FEET	SQ.YD.	POUND / SQ.YD.	PG 64-22 TON	AVG. WID. FEET	SQ.YD.	POUND / SQ.YD.	PG 64-22 TON	AVG. WID. FEET	SQ.YD.	POUND / SQ.YD.	PG 64-22 TON	TOTAL PG 64-22 TON	
						TOTAL WID. FEET	SQ.YD.	GALLON	TOTAL WID. FEET	SQ.YD.															GALLON
MAIN LANES																									
308+00.00	309+00.00	TRANSITION	100.00	80.50	80.50				22.00	244.44	41.55	41.55	2.24	24.89	385.00	4.79	2.13	23.67	220.00	2.60	25.00	277.78	220.00	30.56	33.16
309+00.00	309+95.50	NOTCH AND WIDEN	95.50	161.00	153.76	52.73	559.52	27.98				27.98	26.48	280.98	VAR.	31.85	26.25	278.54	220.00	30.64	28.00	297.11	220.00	32.68	63.32
311+68.50	314+00.00	NOTCH AND WIDEN	231.50	161.00	372.72	52.73	1356.33	67.82				67.82	26.48	681.12	VAR.	158.18	26.25	675.21	220.00	74.27	28.00	720.22	220.00	79.22	153.49
314+00.00	315+00.00	TRANSITION	100.00	80.50	80.50				22.00	244.44	41.55	41.55	2.24	24.89	385.00	4.79	2.13	23.67	220.00	2.60	25.00	277.78	220.00	30.56	33.16
ADDITIONAL FOR LEVELING																									
309+00.00	309+95.50	HWY. 7	95.50						22.00	233.44	39.68	39.68													
311+68.50	314+00.00	HWY. 7	231.50						22.00	565.89	96.20	96.20													
WIDENING FOR GUARDRAIL																									
308+49.85	308+85.85	GUARDRAIL WIDENING ON LT.	36.00																						
308+85.85	309+18.85	GUARDRAIL WIDENING ON LT.	33.00	21.13	6.97																				
309+18.85	310+32.00	GUARDRAIL WIDENING ON LT.	113.15	42.25	47.81																				
308+49.85	308+85.85	GUARDRAIL WIDENING ON RT.	36.00																						
308+85.85	309+18.85	GUARDRAIL WIDENING ON RT.	33.00	21.13	6.97																				
309+18.85	310+32.00	GUARDRAIL WIDENING ON RT.	113.15	42.25	47.81																				
311+32.00	313+70.15	GUARDRAIL WIDENING ON LT.	238.15	42.25	100.62																				
313+70.15	314+03.15	GUARDRAIL WIDENING ON LT.	33.00	21.13	6.97																				
314+03.15	314+39.15	GUARDRAIL WIDENING ON LT.	36.00																						
311+32.00	312+45.15	GUARDRAIL WIDENING ON RT.	113.15	42.25	47.81																				
312+45.15	312+78.15	GUARDRAIL WIDENING ON RT.	33.00	21.13	6.97																				
312+78.15	313+14.15	GUARDRAIL WIDENING ON RT.	36.00																						
DETOUR																									
20+00.00	21+90.00	NOTCH AND WIDEN	190.00	82.75	157.23	VAR.	152.22	7.61				7.61													
21+90.00	24+30.00	FULL DEPTH	240.00	165.50	397.20	22.25	593.33	29.67				29.67													
25+23.00	27+40.00	FULL DEPTH	217.00	165.50	359.14	22.25	536.47	26.82				26.82													
27+40.00	29+26.32	NOTCH AND WIDEN	186.32	82.75	154.18	VAR.	152.47	7.62				7.62													
TOTALS:				2027.16		3350.34	167.52		1288.21	218.98	386.50		1011.88		199.61		2435.58		267.90		5025.43		552.80	820.70	

BASIS OF ESTIMATE:
 ACHM SURFACE COURSE (3/8").....94.5% MIN. AGGR.....5.5% ASPHALT BINDER
 ACHM BINDER COURSE (1").....95.6% MIN. AGGR.....4.4% ASPHALT BINDER
 MAXIMUM NUMBER OF GYRATIONS = 115 FOR PG 64-22
 TACK COAT QUANTITIES WERE CALCULATED USING THE EMULSIFIED ASPHALT RATES. REFER TO SS-400-1 FOR THE RESIDUAL ASPHALT APPLICATION RATES.

12/18/2018 RO80506.DGN

DATE REVISED	DATE FILMED	DATE REVISED	DATE FILMED	FED. ROAD DIST. NO.	STATE	FED. AID PROJ. NO.	SHEET NO.	TOTAL SHEETS
				8	ARK.			
				JOB NO.	080506		20	49
① 07428 - QUANTITIES - 60371								

SCHEDULE OF BRIDGE QUANTITIES - JOB NO. 080506

BRIDGE NO. NAME TITLE	UNIT OF STRUCTURE	ITEM NO.	205	801	SS & 802	SP, SS, & 802	803	SS & 804	SS & 804	SS & 805	SS & 805	SP, SS, & 807	812	816	816	SP JOB 080506	SP JOB 080506	
		ITEM	REMOVAL OF EXISTING BRIDGE STRUCTURE (SITE NO. 1)	UNCLASSIFIED EXCAVATION FOR STRUCTURES-BRIDGE	CLASS S CONCRETE-BRIDGE	CLASS S(AE) CONCRETE-BRIDGE	CLASS 1 PROTECTIVE SURFACE TREATMENT	REINFORCING STEEL-BRIDGE (GRADE 60)	EPOXY COATED REINFORCING STEEL (GRADE 60)	③ STEEL PILING (HP 12X53)	PREBORING	STRUCTURAL STEEL IN BEAM SPANS (M 270, GRADE 50W)	BRIDGE NAME PLATE (TYPE D)	FILTER BLANKET	DUMPED RIPRAP	ARCHITECTURAL FINISH	STAINING CONCRETE SURFACES	
		UNIT	LUMP SUM	CU. YD.	CU. YD.	CU. YD.	GAL.	LB.	LB.	LIN. FT.	LIN. FT.	LB.	EACH	SQ. YD.	CU. YD.	SQ. FT.	SQ. FT.	
07428 HIGHWAY 7 OVER CROOKED BRANCH	BENT NO. 1			69	18.40			1,480	265	85	75			115	95		20	
	BENT NOS. 2 & 3			205	91.00			11,910										
	BENT NO. 4			69	18.40			1,480	265	85	75			265	175		20	
	99'-0" INTEGRAL W-BEAM UNIT					② 174.00	8.9		52,715			56,430	1			1,795	2,775	
	EXISTING BRIDGE NO. M0197 (SITE NO.1)		1															
TOTALS FOR JOB NO. 080506				90	① 343	127.80	174.00	8.9	14,870	53,245	170	150	56,430	1	380	270	1,795	2,815

- ① Includes approx. 87 cubic yards of rock excavation.
- ② Based upon neat lines of Decorative Concrete Parapet Railing, and the dimension of deck edge being 9 3/4". Payment will be based upon plan quantities shown.
- ③ Steel piling is required to be Grade 50 and have special pile tips which will not be paid for directly, but will be considered subsidiary to the Item "Steel Piling (HP 12X53)".

LUKE BAILEY
DESIGN SECTION SUPERVISOR

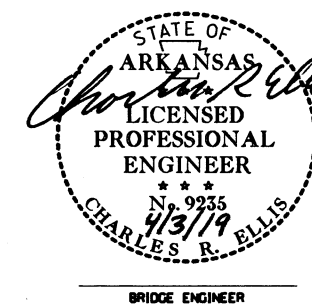

**SCHEDULE OF BRIDGE QUANTITIES
CROOKED BRANCH STR. & APPRS. (S)
POPE COUNTY**

ROUTE 7 SEC. 15
ARKANSAS STATE HIGHWAY COMMISSION
LITTLE ROCK, ARK.

DRAWN BY: DBS DATE: 6-18-18 FILENAME: b080506.qi.dgn
 CHECKED BY: WAC DATE: 4/3/19 SCALE: NONE
 DESIGNED BY: -- DATE: --
 BRIDGE NO. 07428 DRAWING NO. 60371

SUMMARY OF QUANTITIES

DATE REVISED	DATE FILMED	DATE REVISED	DATE FILMED	FED. RD. DIST. NO.	STATE	FED. AID PROJ. NO.	SHEET NO.	TOTAL SHEETS
				6	ARK.			
				JOB NO.	080506		21	49

② SUMMARY OF QUANTITIES AND REVISIONS

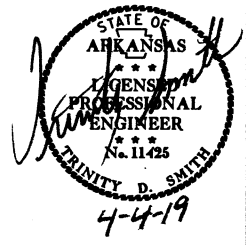

REVISIONS

DATE	REVISION	SHEET NUMBER

ITEM NUMBER	ITEM	QUANTITY	UNIT
201	CLEARING	7	STATION
201	GRUBBING	7	STATION
202	REMOVAL AND DISPOSAL OF FENCE	663	LIN. FT.
202	REMOVAL AND DISPOSAL OF SIGN FOUNDATIONS	3	EACH
202	REMOVAL AND DISPOSAL OF PIPE CULVERTS	2	EACH
202	REMOVAL AND DISPOSAL OF GUARDRAIL	288	LIN. FT.
202	REMOVAL AND DISPOSAL OF SIGNS	2	EACH
210	UNCLASSIFIED EXCAVATION	4798	CU. YD.
210	COMPACTED EMBANKMENT	4152	CU. YD.
SP & 210	SOIL STABILIZATION	100	TON
SS & 303	AGGREGATE BASE COURSE (CLASS 7)	2349	TON
SS & 401	TACK COAT	393	GAL.
SP, SS, & 406	MINERAL AGGREGATE IN ACHM BINDER COURSE (1")	191	TON
SP, SS, & 406	ASPHALT BINDER (PG 64-22) IN ACHM BINDER COURSE (1")	9	TON
SP, SS, & 407	MINERAL AGGREGATE IN ACHM SURFACE COURSE (3/8")	776	TON
SP, SS, & 407	ASPHALT BINDER (PG 64-22) IN ACHM SURFACE COURSE (3/8")	45	TON
SP, SS, & 407	MINERAL AGGREGATE IN ACHM SURFACE COURSE (1/2")	18	TON
SP, SS, & 407	ASPHALT BINDER (PG 64-22) IN ACHM SURFACE COURSE (1/2")	1	TON
412	COLD MILLING ASPHALT PAVEMENT	489	SQ. YD.
SP, SS, & 414	ASPHALT CONCRETE PATCHING FOR MAINTENANCE OF TRAFFIC	3	TON
SP, SS, & 415	ACHM PATCHING OF EXISTING ROADWAY	50	TON
504	APPROACH SLABS	98.30	CU. YD.
504	APPROACH GUTTERS	56.80	CU. YD.
601	MOBILIZATION	1.00	LUMP SUM
SP & 602	FURNISHING FIELD OFFICE	1	EACH
603	MAINTENANCE OF TRAFFIC	1.00	LUMP SUM
603	18" TEMPORARY CULVERT	38	LIN. FT.
SS & 604	SIGNS	316	SQ. FT.
SS & 604	BARRICADES	32	LIN. FT.
SS & 604	TRAFFIC DRUMS	24	EACH
604	CONSTRUCTION PAVEMENT MARKINGS	6505	LIN. FT.
604	REMOVABLE CONSTRUCTION PAVEMENT MARKINGS	800	LIN. FT.
604	REMOVAL OF CONSTRUCTION PAVEMENT MARKINGS	800	LIN. FT.
604	REMOVAL OF PERMANENT PAVEMENT MARKINGS	800	LIN. FT.
SS & 604	VERTICAL PANELS	11	EACH
SS & 605	CONCRETE DITCH PAVING (TYPE B)	114	SQ. YD.
SP, SS, & 606	18" SIDE DRAIN	28	LIN. FT.
SS & 606	21" X 15" SIDE DRAIN	42	LIN. FT.
606	SELECTED PIPE BEDDING	10	CU. YD.
SS & 611	4" PIPE UNDERDRAINS	600	LIN. FT.
SS & 611	UNDERDRAIN OUTLET PROTECTORS	6	EACH
SS & 617	GUARDRAIL (TYPE A)	225	LIN. FT.
SS & 617	GUARDRAIL TERMINAL (TYPE 2)	4	EACH
SS & 617	THREE BEAM GUARDRAIL TERMINAL	4	EACH
619	WIRE FENCE (TYPE D-1)	647	LIN. FT.
619	16' STEEL GATES (ALTERNATE NO. 1)	1	EACH
619	16' ALUMINUM GATES (ALTERNATE NO. 2)	1	EACH
620	LIME	2	TON
620	SEEDING	1.00	ACRE
SS & 620	MULCH COVER	6.73	ACRE
620	WATER	219.5	M. GAL.
621	TEMPORARY SEEDING	5.73	ACRE
621	SILT FENCE	2529	LIN. FT.
621	SAND BAG DITCH CHECKS	308	BAG
621	SEDIMENT BASIN	200	CU. YD.
621	OBLITERATION OF SEDIMENT BASIN	200	CU. YD.
621	SEDIMENT REMOVAL AND DISPOSAL	322	CU. YD.
621	ROCK DITCH CHECKS	42	CU. YD.
SS & 621	FILTER SOCK (12")	700	LIN. FT.
623	SECOND SEEDING APPLICATION	1.00	ACRE
624	SOLID SODDING	51	SQ. YD.
635	ROADWAY CONSTRUCTION CONTROL	1.00	LUMP SUM
719	THERMOPLASTIC PAVEMENT MARKING WHITE (6")	1800	LIN. FT.
719	THERMOPLASTIC PAVEMENT MARKING YELLOW (6")	1800	LIN. FT.
721	RAISED PAVEMENT MARKERS (TYPE II)	11	EACH
SS & 804	REINFORCING STEEL-ROADWAY (GRADE 60)	14630	POUND
STRUCTURES OVER 20' SPAN			
205	REMOVAL OF EXISTING BRIDGE STRUCTURE (SITE NO. 1)	1.00	LUMP SUM
603	TEMPORARY BRIDGE STRUCTURE (24' ROADWAY WIDTH)	90	LIN. FT.
636	BRIDGE CONSTRUCTION CONTROL	1.00	LUMP SUM
801	UNCLASSIFIED EXCAVATION FOR STRUCTURES-BRIDGE	343	CU. YD.
SS & 802	CLASS S CONCRETE-BRIDGE	127.80	CU. YD.
SP, SS, & 802	CLASS S(AE) CONCRETE-BRIDGE	174.00	CU. YD.
SP	ARCHITECTURAL FINISH	1795	SQ. FT.
SP	STAINING CONCRETE SURFACES	2815	SQ. FT.
803	CLASS 1 PROTECTIVE SURFACE TREATMENT	8.9	GAL.
SS & 804	REINFORCING STEEL-BRIDGE (GRADE 60)	14870	POUND
SS & 804	EPOXY COATED REINFORCING STEEL (GRADE 60)	53245	POUND
SS & 805	STEEL PILING (HP 12X53)	170	LIN. FT.
SS & 805	PREBORING	150	LIN. FT.
SP, SS, & 807	STRUCTURAL STEEL IN BEAM SPANS (M270-GR50W)	56430	POUND
812	BRIDGE NAME PLATE (TYPE D)	1	EACH
816	FILTER BLANKET	380	SQ. YD.
816	DUMPED RIPRAP	270	CU. YD.

* DENOTES ALTERNATE BID ITEMS.

SUMMARY OF QUANTITIES AND REVISIONS

12/18/2018 R080506.DGN

SURVEY CONTROL COORDINATES

Project Name: s080506
 Date: 11/18/2016
 Coordinate System: ARKANSAS STATE PLANE - NORTH ZONE BASED ON GPS CONTROL, 580031 - 580031A
 PROJECTED TO GROUND.
 Units: U.S. SURVEY FOOT

Point Name	Northing	Easting	Elev	Feature	Description
1	398108.4067	974316.3666	432.347	CTL	AHTD STD. MON. STAMPED PN: 1
2	398830.3183	974351.5369	426.049	CTL	AHTD STD. MON. STAMPED PN: 2
3	399427.3364	974376.4198	427.582	CTL	AHTD STD. MON. STAMPED PN: 3
4	400601.6600	974395.3582	428.429	CTL	AHTD STD. MON. STAMPED PN: 4
5	401329.7653	974413.7204	437.631	CTL	AHTD STD. MON. STAMPED PN: 5
100	400204.0664	974393.6419	429.319	GPS	AHTD GPS #580031
101	401737.6651	974427.8019	441.862	GPS	AHTD GPS #580031A

*Note - Rebar and Cap - Standard - 5/8" Rebar with 2" Aluminum Cap stamped
 *(standard markings common to all caps), or as indicated
 (other markings indicated in the point description of the individual point).
 ALL DISTANCES ARE GROUND.
 USE CAF = 1.0 FOR STAKEOUT FOR THIS PROJECT.
 A PROJECT CAF OF 0.999923598729 HAS BEEN USED TO COMPUTE THE ABOVE GROUND COORDINATES.
 THIS CAF IS INTENDED FOR USE WITHIN THE PROJECT LIMITS.
 GRID DISTANCE = GROUND DISTANCE X CAF.
 GRID COORDINATES ARE STORED UNDER FILE NAME s080506gi.CTL
 HORIZONTAL DATUM: NAD 83 (2011)
 VERTICAL DATUM: NAVD 88 POSITIONAL ACCURACY THIRD ORDER, UNLESS SPECIFIED OTHERWISE
 AT A SPECIFIC POINT.

REFERENCE POINTS (1500 SERIES) ARE TO BE USED TO ESTABLISH CONTROL
 IF THE PRIMARY CONTROL POINTS LISTED ABOVE HAVE BEEN DESTROYED.
 REFERENCE POINTS ARE NOT TO BE USED FOR VERTICAL CONTROL

BASIS OF BEARING:
 ARKANSAS STATE PLANE GRID BEARINGS - 0301-NORTH ZONE
 DETERMINED FROM GPS CONTROL POINTS: 580031 - 580031A
 CONVERGENCE ANGLE: 00 39 36.83 LEFT AT LT: N 35-25-38.72 LG: W093-08-04.61
 GRID AZIMUTH = ASTRONOMICAL AZIMUTH - CONVERGENCE ANGLE.

ELEV. BASED ON STATIC GPS DERIVED
 ELEV. TO AHTD GPS #580031 CONSTRAINING
 AHTD CORS ARFY, ARHR & ARLR AND NGS
 1ST ORDER BM B 326

HWY. 7

POINT NO.	TYPE	STATION	NORTHING	EASTING
8000	POB	300+00.00	399333.1776	974338.6987
8001	PI	305+69.62	399902.5849	974354.4354
8002	PI	315+31.81	400864.3833	974381.6704
8003	POE	321+92.12	401524.4150	974400.8185

DETOUR

POINT NO.	TYPE	STATION	NORTHING	EASTING
8004	POB	20+00.00	399932.9480	974355.2952
8005	PC	20+23.76	399956.6979	974355.9677
8007	PT	21+75.35	400105.9018	974380.1375
8008	PC	22+34.47	400162.5039	974397.2063
8010	PT	23+86.83	400312.4747	974421.3974
8011	PC	25+48.06	400473.6468	974425.7453
8013	PT	27+21.76	400645.3453	974404.2375
8014	PC	27+29.76	400653.0413	974402.0561
8016	PT	29+04.23	400825.5066	974380.5695
8017	POE	29+26.32	400847.5814	974381.1946

DATE REVISED	DATE FILED	DATE REVISED	DATE FILED	FED. DIST. NO.	STATE	FED. AID PROJ. NO.	SHEET NO.	TOTAL SHEETS
				6	ARK.			
							JOB NO.	080506
							SHEET NO.	22
							TOTAL SHEETS	49

2 SURVEY CONTROL DETAILS

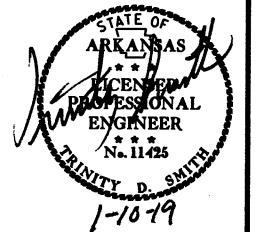

SURVEY CONTROL DETAILS

7/19/2018

R080506.DGN

DATE REVISED	DATE FILED	DATE REVISED	DATE FILED	FED. RD. DIST. NO.	STATE	FED. AID PROJ. NO.	SHEET NO.	TOTAL SHEETS
				6	ARK.			
JOB NO. 080506							23	49

2 SURVEY CONTROL DETAILS

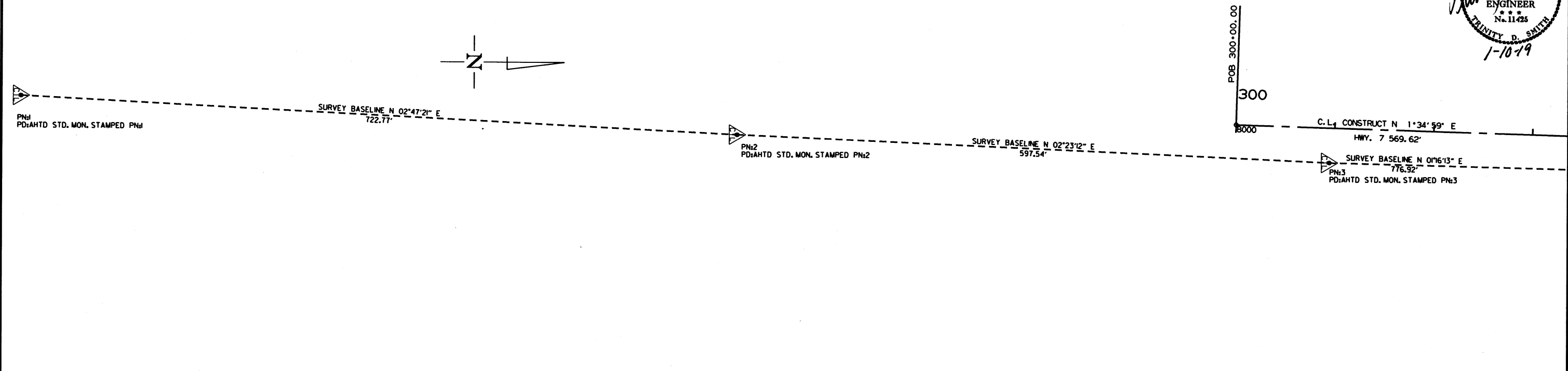
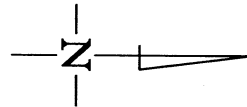
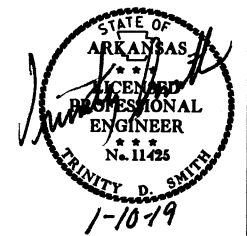

DETOUR CURVE DATA
 P. I. = 23+11.10
 Δ = 15°14'09\"/>

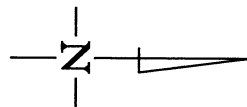

DETOUR CURVE DATA
 P. I. = 26+35.58
 Δ = 17°22'14\"/>

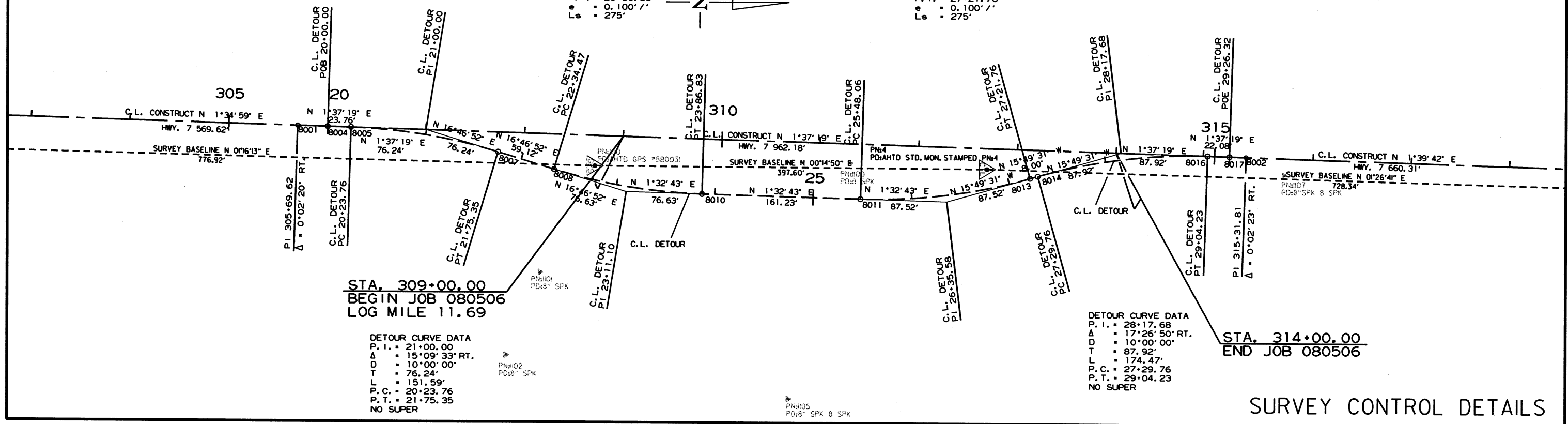

DETOUR CURVE DATA
 P. I. = 21+00.00
 Δ = 15°09'33\"/>

DETOUR CURVE DATA
 P. I. = 28+17.68
 Δ = 17°26'50\"/>

STA. 314+00.00
 END JOB 080506

SURVEY CONTROL DETAILS

7/19/2018

R080506.DGN

DATE REVISED	DATE FILMED	DATE REVISED	DATE FILMED	FED. RD. DIST. NO.	STATE	FED. AID PROJ. NO.	SHEET NO.	TOTAL SHEETS
				6	ARK.			
				JOB NO.	080506		24	49

2 SURVEY CONTROL DETAILS

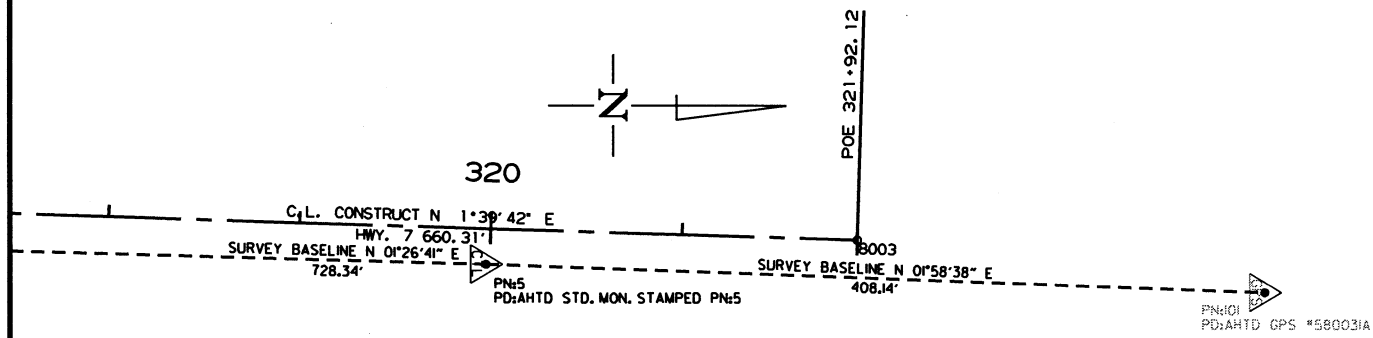
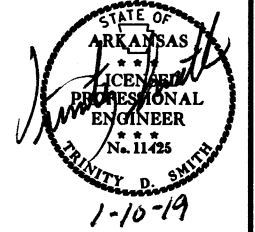

7/19/2018

R080506.DGN

SURVEY CONTROL DETAILS