

FED. ROAD DIST. NO.	STATE	Fed Aid PROJECT NO.	FISCAL YEAR	SHEET NO.	TOTAL SHEETS
6	ARK.	102 (3)		25	29
STATE JOB NO. 15231					

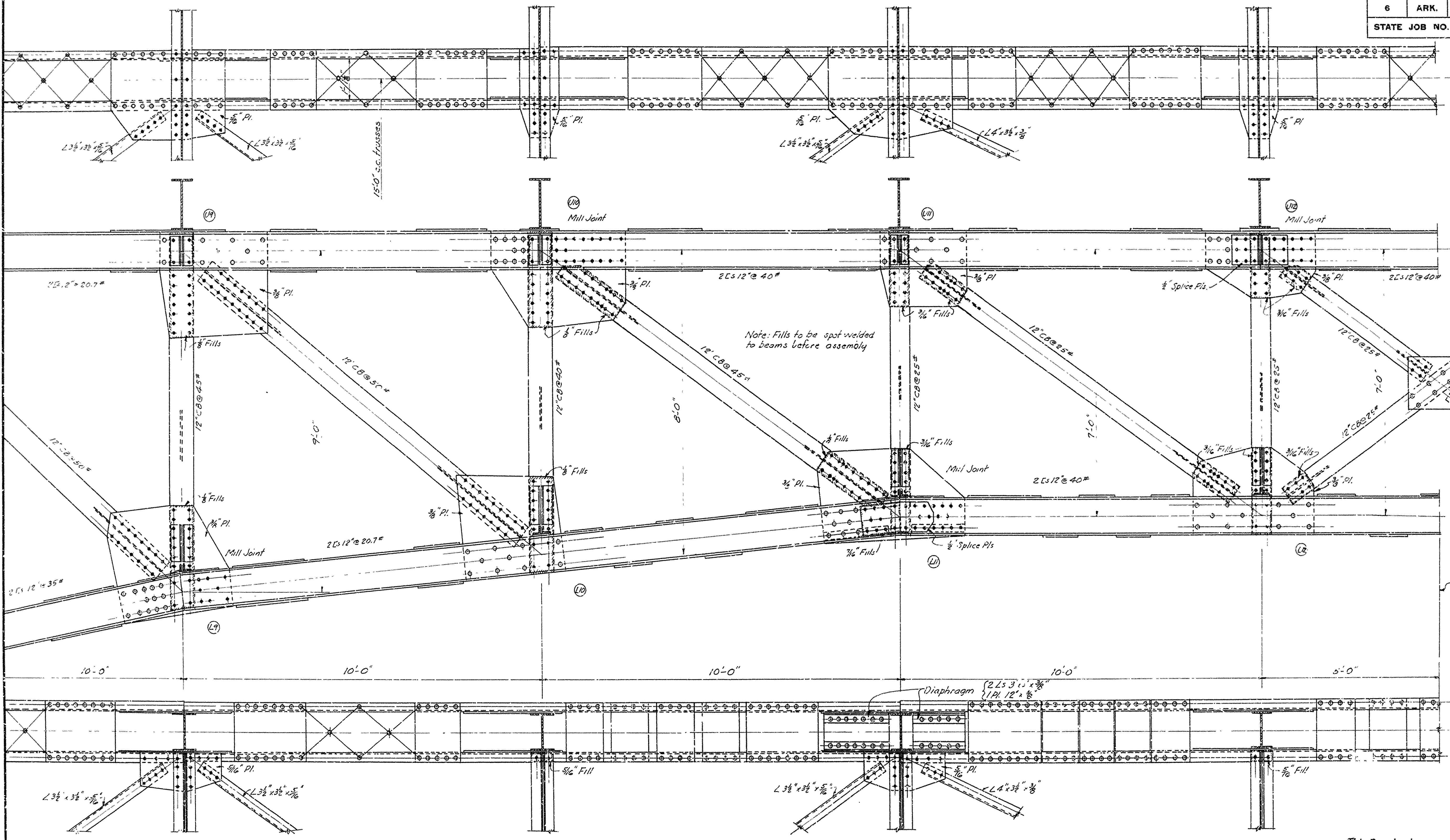

Symmetrical about  $\bar{x}$  except as shown.

This Drawing to accompany Drawings 2460, 2460-A, and 2460-C  
**DETAILS OF STANDARD  
 70'-110'-70' CONTINUOUS TRUSS SPANS  
 24' CLEAR ROADWAY**

ROUTE XXXX SEC. XXXX  
**ARKANSAS STATE HIGHWAY COMMISSION**  
 LITTLE ROCK, ARK.  
 Drawn By: L.P.C. Date: 1-6-37  
 Traced By: L.P.C. Date: 3-3-37  
 Checked By: \_\_\_\_\_ Date: \_\_\_\_\_  
 Scale:  $\frac{3}{8}$ " = 1' - 0"  
**BRIDGE NO. XXXX DRAWING NO. 2460-B**

*L.P.C.*  
 BRIDGE ENGINEER