

ARKANSAS DEPARTMENT OF TRANSPORTATION
CONSTRUCTION PLANS

DATE REVISED	DATE FILMED	DATE REVISED	DATE FILMED	FED. NO. DIST. NO.	STATE	FED. AID PROJ. NO.	SHEET NO.	TOTAL SHEETS
				6	ARK.			
				JOB NO.		GF0270	1	15
① McCALLIE BOAT RAMPS AND PKG. LOT (MISSISSIPPI RIVER) (S)								

McCALLIE BOAT RAMPS AND PKG. LOT (MISSISSIPPI RIVER) (S)

DESHA COUNTY

JOB GF0270

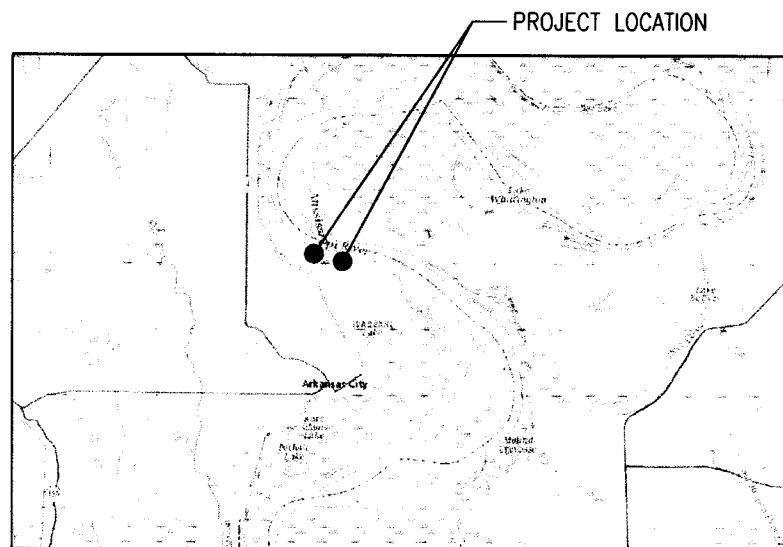

VICINITY MAP
(NOT TO SCALE)

PROJECT COORDINATES

MID-POINT OF PROJECT
(PRIMARY ACCESS)

LAT. = N33°39'17"
LONG. = W91°12'31"

MID-POINT OF PROJECT
(HIGH WATER ACCESS & SCENIC OVERLOOK)

LAT. = N33°39'18"
LONG. = W91°12'44"

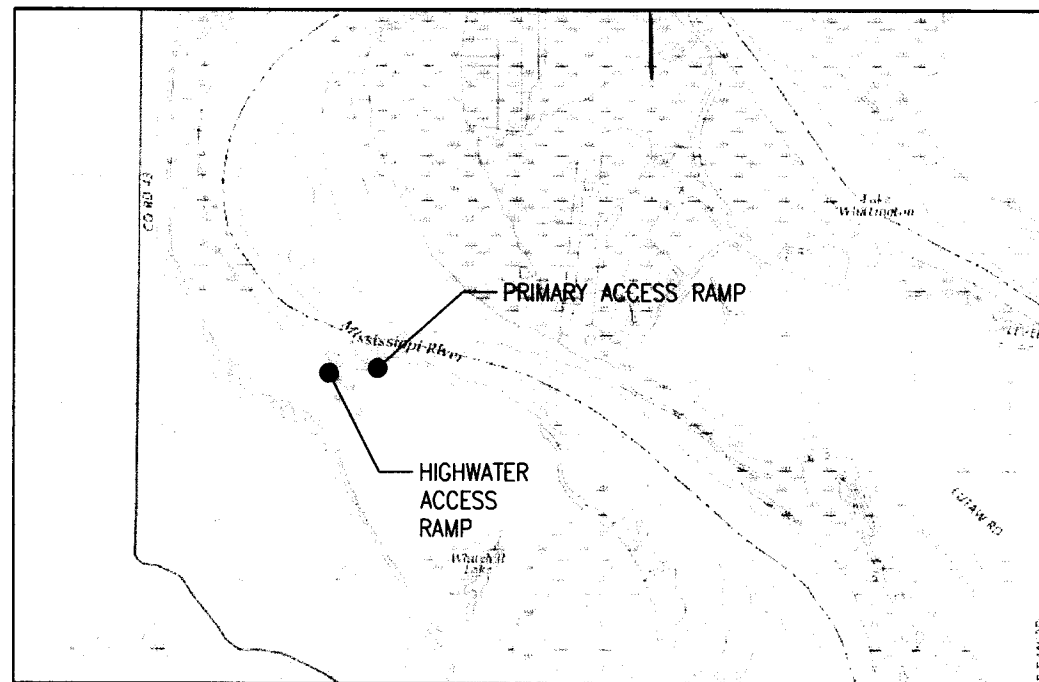

LOCATION MAP
(NOT TO SCALE)

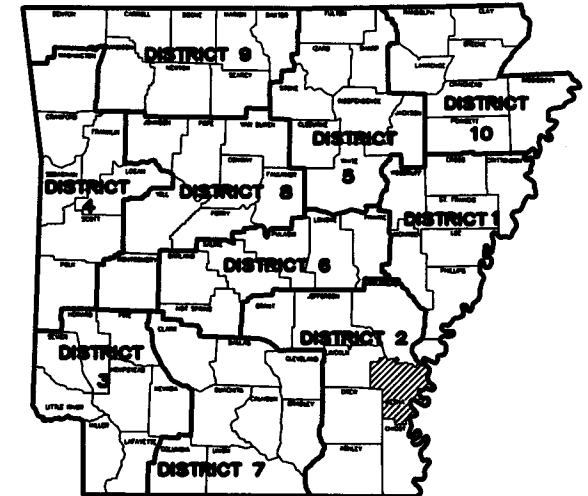

ARKANSAS HIGHWAY
DISTRICT NO. 2



SHEET	NO	NAME	REV NO	DATE	BY	APPRV'D	DESCRIPTION
G-001	1	TITLE SHEET	-	-	-	-	-
G-002	2	INDEX OF SHEETS	-	-	-	-	-
G-003	3	GOVERNING SPECIFICATIONS AND GENERAL NOTES	-	-	-	-	-
G-004	4	SUMMARY OF QUANTITIES AND REVISIONS	-	-	-	-	-
C-001	5	NOTES	-	-	-	-	-
C-010	6	OVERALL SITE PLAN	-	-	-	-	-
PRIMARY ACCESS RAMP							
C-100	7	EXISTING CONDITIONS AND DEMOLITION PLAN (PRIMARY ACCESS RAMP)	-	-	-	-	-
C-110	8	SITE PLAN (PRIMARY ACCESS RAMP)	-	-	-	-	-
C-120	9	GRADING AND EROSION CONTROL PLAN (PRIMARY ACCESS RAMP)	-	-	-	-	-
C-130	10	RAMP PLAN AND PROFILE (PRIMARY ACCESS RAMP)	-	-	-	-	-
HIGH WATER RAMP WITH SCENIC OVERLOOK							
C-101	11	EXISTING CONDITIONS AND SITE PLAN (HIGH WATER RAMP WITH SCENIC OVERLOOK)	-	-	-	-	-
C-121	12	GRADING AND EROSION CONTROL PLAN (HIGH WATER RAMP WITH SCENIC OVERLOOK)	-	-	-	-	-
C-131	13	RAMP PLAN AND PROFILE (HIGH WATER RAMP WITH SCENIC OVERLOOK)	-	-	-	-	-
C-500	14	CONSTRUCTION DETAILS	-	-	-	-	-
C-501	15	RAMP DETAILS	-	-	-	-	-

NO.	DATE	DESCRIPTION

PROJECT #: 25264.00
DATE: AUGUST 29, 2018
DRAWN BY: CBB
DESIGNER: GJC
CHECKED BY: RJP



Pickering
Pickering Firm, Inc.
Facility Design • Civil Engineering • Surveying •
Transportation • Natural / Water Resources
317 South Church Street
Joplin, MO 64501
870.336.6663

**McCALLIE BOAT RAMPS AND
PKG. LOT
(MISSISSIPPI RIVER) (S)
McCALLIE ACCESS
DESHA, ARKANSAS**



SHEET NUMBER:
G-002
SHEET 2 OF 15
DESCRIPTION:
INDEX OF SHEETS

GENERAL NOTES:

1. GRADE LINE DENOTES FINISHED GRADE WHERE SHOWN ON PLANS.
2. ANY EQUIPMENT OR APPURTENANCE THAT INTERFERES WITH THE PROPOSED CONSTRUCTION AND WHICH MAY BE THE PROPERTY OF UTILITY SERVICE ORGANIZATIONS SHALL BE MOVED BY THE OWNERS UNLESS OTHERWISE PROVIDED.
3. ALL LAND MONUMENTS LOCATED WITHIN THE CONSTRUCTION AREA SHALL BE PROTECTED IN ACCORDANCE WITH SECTION 107.12 OF THE STANDARDS SPECIFICATIONS.
4. ALL TREES THAT DO NOT DIRECTLY INTERFERE WITH THE PROPOSED CONSTRUCTION SHALL BE SPARED AS DIRECTED BY THE ENGINEER. CARE AND DISCRETION SHALL BE USED TO INSURE THAT ALL TREES NOT TO BE REMOVED SHALL BE HARMED AS LITTLE AS POSSIBLE DURING THE CONSTRUCTION OPERATIONS.
5. ALL FLEXIBLE BASE AND ASPHALTIC PAVEMENTS REMOVED SHALL BE PAID FOR UNDER THE ITEM NO.210 UNCLASSIFIED EXCAVATION.
6. ANY DAMAGE OF THE ASPHALT PAVEMENT THAT IS TO REMAIN IN PLACE SHALL BE REPAIRED AT THE CONTRACTOR'S EXPENSES.
7. THIS PROJECT IS COVERED UNDER A SECTION 404 GENERAL PERMIT 25. REFER TO SECTION 110 OF THE STANDARD SPECIFICATIONS, EDITION 2014, FOR PERMIT REQUIREMENTS.

OWNER:

ARKANSAS GAME AND FISH COMMISSION
1125 HIGHWAY 56 NORTH
CALICO ROCK, AR 72519

CONTACT: MICHAEL CANTRELL
CONSTRUCTION MANAGER, OPERATIONS
PHONE: 877-297-4331 EXT. 1141
FAX: 870-297-8994

OPERATOR:

ARKANSAS GAME AND FISH COMMISSION

DESIGN FIRM ARCHITECTURE AND ENGINEERING:
PICKERING FIRM, INC.
317 SOUTH CHURCH STREET
JONESBORO, AR 72401
PHONE: 870-336-6663

CIVIL ENGINEER: ROBERT J. PITTS, P.E.

GOVERNING SPECIFICATIONS

ARKANSAS STATE HIGHWAY COMMISSION STANDARD SPECIFICATIONS FOR HIGHWAY CONSTRUCTION, EDITION OF 2014, AND THE FOLLOWING:

- ERRATA ----- ERRATA FOR THE BOOK OF STANDARD SPECIFICATIONS
- 100-3 ----- CONTRACTOR'S LICENSE
- 100-4 ----- DEPARTMENT NAME CHANGE
- 102-2 ----- ISSUANCE OF PROPOSALS
- 108-1 ----- LIQUIDATED DAMAGES
- 108-2 ----- WORK ALLOWED PRIOR TO ISSUANCE OF WORK ORDER
- 110-1 ----- PROTECTION OF WATER QUALITY AND WETLANDS
- 303-1 ----- AGGREGATE BASE COURSE
- 400-1 ----- TACK COATS
- 400-4 ----- DESIGN AND QUALITY CONTROL OF ASPHALT MIXTURES
- 400-5 ----- PERCENT AIR VOIDS FOR ACHM MIX DESIGNS
- 400-6 ----- LIQUID ANTI-STRIP ADDITIVE
- 410-1 ----- CONSTRUCTION REQUIREMENTS AND ACCEPTANCE OF ASPHALT CONCRETE PLANT
- 620-1 ----- MULCH COVER
- 633-1 ----- CONCRETE WALKS, CONCRETE STEPS, AND HAND RAILING
- 634-1 ----- CURBING
- 800-1 ----- STRUCTURES
- JOB GF0270 ----- BIDDING REQUIREMENTS AND CONDITIONS
- JOB GF0270 ----- BOAT RAMP CONCRETE
- JOB GF0270 ----- BOAT RAMP FILTER BLANKET AND RIPRAP
- JOB GF0270 ----- BROADBAND INTERNET SERVICES FOR ASPHALT CONCRETE PLANT
- JOB GF0270 ----- CONCRETE STOPBLOCK
- JOB GF0270 ----- CONSTRUCTION IN SPECIAL FLOOD HAZARD AREAS
- JOB GF0270 ----- LANDSCAPING
- JOB GF0270 ----- MANDATORY ELECTRONIC CONTRACT
- JOB GF0270 ----- MANDATORY ELECTRONIC DOCUMENT SUBMITTAL
- JOB GF0270 ----- SETTLEMENT AGREEMENTS
- JOB GF0270 ----- STORM WATER POLLUTION PREVENTION PLAN
- JOB GF0270 ----- SUBMISSION OF ASPHALT CONCRETE HOT MIX ACCEPTANCE TEST RESULTS
- JOB GF0270 ----- TEMPORARY FENCE
- JOB GF0270 ----- TEMPORARY SILT FENCE (WITH BACKING)
- JOB GF0270 ----- WARM MIX ASPHALT

REVISIONS:

PROJECT #: 25264.00
 DATE: AUGUST 29, 2018
 DRAWN BY: CBB
 DESIGNER: GJC
 CHECKED BY: RJP



**MCCALLIE BOAT RAMPS AND
 PKG. LOT
 (MISSISSIPPI RIVER) (S)
 MCCALLIE ACCESS
 DESHA, ARKANSAS**

SEAL:



SHEET NUMBER:
G-003

SHEET 3 OF 15
 DESCRIPTION:
 GOVERNING SPECIFICATIONS
 AND GENERAL NOTES

15:2000 (08/2018) ARKANSAS STANDARD SPECIFICATIONS FOR HIGHWAY CONSTRUCTION, EDITION 2014 - Addendum 18, 2018

SUMMARY OF QUANTITIES					
ARDOT JOB NO GF0270					
HIGH WATER ACCESS RAMP AND SCENIC OVERLOOK					
ITEM NUMBER	ITEM	HIGH WATER ACCESS QUANTITY	PRIMARY ACCESS QUANTITY	TOTAL QUANTITY	UNIT
201	CLEARING	0.50	1.00	1.50	AC
201	GRUBBING	0.50	1.00	1.50	AC
210	UNCLASSIFIED EXCAVATION	3950	4750	8700	CY
210	COMPACTED EMBANKMENT	150	4200	4350	CY
SS & 303	AGGREGATE BASE COURSE (CLASS 3)	125	90	215	CY
SS & 303	AGGREGATE BASE COURSE (CLASS 7)	620	1140	1760	CY
SS & 401	TACK COAT	135	250	385	GAL
SP, SS & 406	MINERAL AGGREGATE IN ACHM BINDER COURSE (1")	430	790	1220	TON
SP, SS & 406	ASPHALT BINDER (PG64-22) IN ACHM BINDER COURSE (1")	20	40	60	TON
SP, SS & 407	MINERAL AGGREGATE IN ACHM SURFACE COURSE (1/2")	285	550	835	TON
SP, SS & 407	ASPHALT BINDER (PG64-22) IN ACHM SURFACE COURSE (1/2")	15	25	40	TON
SP & 501	BOAT RAMP CONCRETE 'CIP'	150	750	900	SY
SP & 501	BOAT RAMP CONCRETE 'CAP'	-	150	150	SY
SP & 502	BOAT RAMP REINFORCING STEEL	4200	16000	20200	LB
601	MOBILIZATION	0.50	0.50	1.00	LS
620	WATER	33.7	17.3	51.0	M. GAL
620	LIME	1	1	2	TON
620	SEEDING	0.33	0.17	0.50	AC
SS & 620	MULCH COVER	0.33	0.17	0.50	AC
SP & 621	TEMPORARY SILT FENCE (WITH BACKING)	1200	1100	2300	LF
621	TEMPORARY SEEDING	0.10	0.10	0.20	AC
621	ROCK DITCH CHECKS	30	30	60	CY
SS & 633	CONCRETE WALKS	52	-	52	SY
SS & 634	CONCRETE CURB (TYPE D)	50	-	50	LF
641	WHEELCHAIR RAMPS (TYPE 3)	4	-	4	SY
718	REFLECTORIZED PAINT PAVEMENT MARKING WHITE (4")	1150	1650	2800	LF
718	REFLECTORIZED PAINT PAVEMENT MARKING BLUE (4")	500	250	750	LF
718	REFLECTORIZED PAINT PAVEMENT MARKING SYMBOLS (WHEELCHAIR)	3	1	4	EA
718	REFLECTORIZED PAINT PAVEMENT MARKING (ARROWS)	13	7	20	EA
726	STANDARD SIGNS	16	4	20	SF
801	UNCLASSIFIED EXCAVATION FOR STRUCTURES-ROADWAY	12	-	12	CY
SS & 802	CONCRETE CLASS 5 - ROADWAY	7.50	-	7.50	CY
804	REINFORCING STEEL (GRADE 60) - ROADWAY	900	-	900	LB
SP & 816	FILTER BLANKET	345	935	1280	SY
SP & 816	DUMPED RIPRAP	675	4050	4725	TON
SP	CONCRETE STOPBLOCK	5	4	9	EA
SP	TEMPORARY FENCE	0	600	600	LF
SP	LANDSCAPING	1.00	-	1.00	LS

BASIS OF ESTIMATE:

LIME 2 TONS/ACRE OF SEEDING
 WATER .. 102 M.G./ACRE OF SEEDING

NOTE:
 THE TEMPORARY EROSION CONTROL DEVICES SHOWN ABOVE AND ON THE PLANS SHALL BE INSTALLED IN SUCH A SEQUENCE AS TO DETER EROSION AND SEDIMENTATION ON U.S. WATER WAYS AS EXPLAINED BY THE NATIONAL POLLUTANT DISCHARGE ELIMINATION.

NOTE: EARTHWORK QUANTITIES SHOWN ABOVE SHALL BE PAID AS PLAN QUANTITY.

REVISIONS		
ARDOT JOB NO. GF0270		
DATE	REVISION	SHEET NUMBER

REVISIONS:		

PROJECT #: 25264.00
 DATE: AUGUST 29, 2018
 DRAWN BY: CBB
 DESIGNER: GJC
 CHECKED BY: RJP



Pickering
 Pickering Firm, Inc.
 Facility Design - Civil Engineering - Surveying -
 Transportation - Natural / Water Resources
 317 South Church Street
 Jonesboro, AR 72401
 870.336.6963

**McCALLIE BOAT RAMPS AND
 PKG. LOT
 (MISSISSIPPI RIVER) (S)
 McCALLIE ACCESS
 DESHA, ARKANSAS**

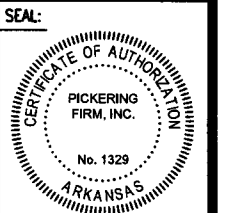

SHEET NUMBER:
G-004
 SHEET 4 OF 15
 DESCRIPTION:
 SUMMARY OF QUANTITIES
 AND REVISIONS

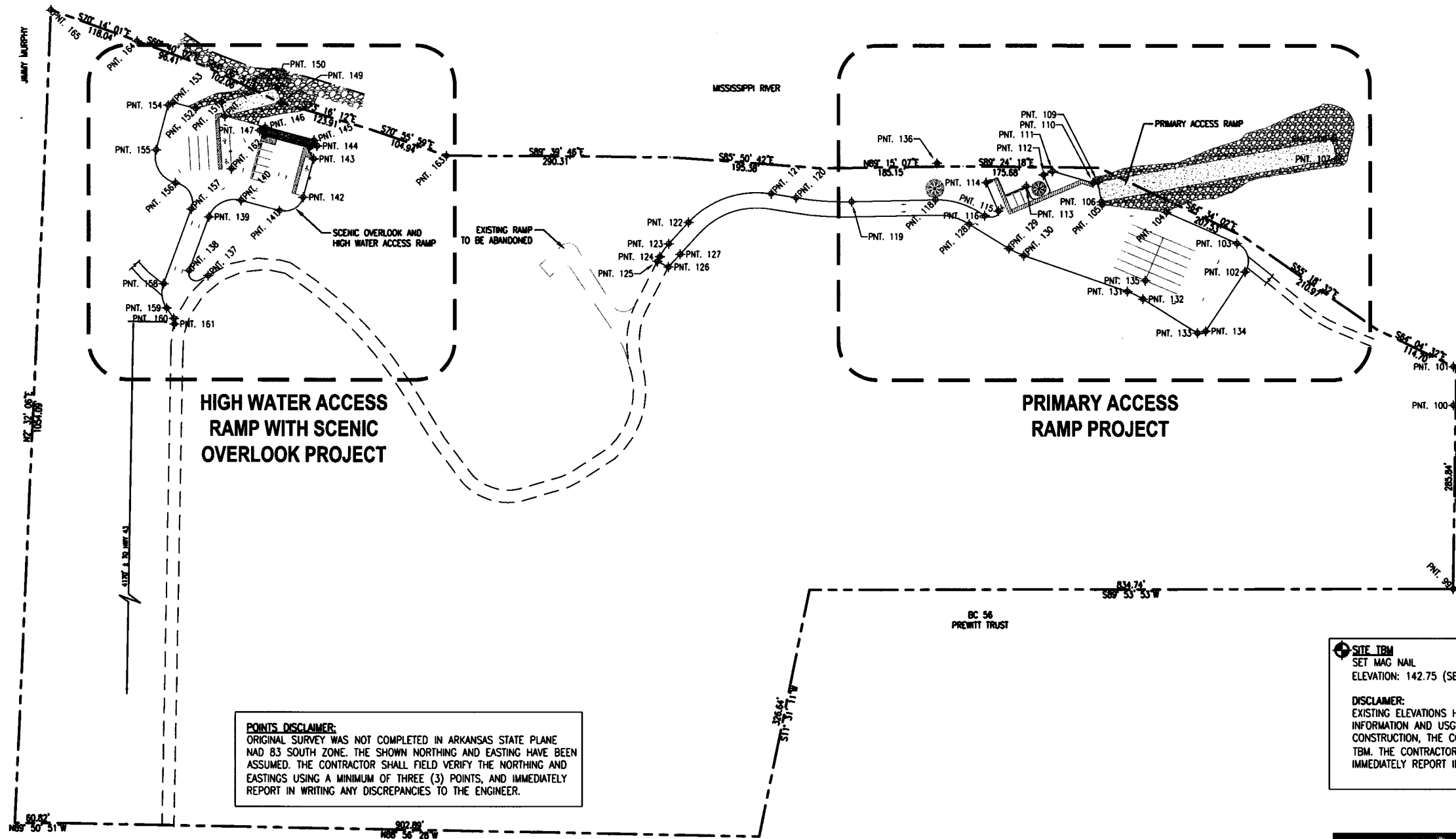

POINTS DISCLAIMER:
 ORIGINAL SURVEY WAS NOT COMPLETED IN ARKANSAS STATE PLANE
 NAD 83 SOUTH ZONE. THE SHOWN NORTHING AND EASTING HAVE BEEN
 ASSUMED. THE CONTRACTOR SHALL FIELD VERIFY THE NORTHING AND
 EASTINGS USING A MINIMUM OF THREE (3) POINTS, AND IMMEDIATELY
 REPORT IN WRITING ANY DISCREPANCIES TO THE ENGINEER.

SITE TBM
 SET MAG NAIL
 ELEVATION: 142.75 (SEE DISCLAIMER BELOW)

DISCLAIMER:
 EXISTING ELEVATIONS HAVE BEEN PROVIDED BY ENGINEER BASED ON SURVEYED
 INFORMATION AND USGS QUADRANGLE INFORMATION. BEFORE BEGINNING
 CONSTRUCTION, THE CONTRACTOR SHALL FIELD VERIFY THE SITE DATUM AND SITE
 TBM. THE CONTRACTOR SHALL USE A MINIMUM OF THREE (3) POINTS, AND
 IMMEDIATELY REPORT IN WRITING ANY DISCREPANCIES TO THE ENGINEER.

Point #	Description	Northing	Easting
99	5/8" REBAR	1672317.89	1553611.47
100	5/8" REBAR W/ AL. CAP	1672555.48	1553611.86
101	5/8" REBAR W/ AL. CAP	1672605.48	1553611.93
102	END RADIUS	1672728.24	1553341.28
103	END RADIUS	1672764.99	1553330.70
104	EDGE OF ASPH	1672805.29	1553239.17
105	EDGE OF ASPH	1672815.15	1553155.79
106	RAMP COR.	1672819.09	1553155.07
107	RAMP COR.	1672874.79	1553460.02
108	RAMP COR.	1672900.36	1553455.35
109	RAMP COR.	1672844.66	1553150.40
110	EDGE OF ASPH	1672843.54	1553144.27
111	EDGE OF ASPH	1672858.65	1553092.02
112	EDGE OF ASPH	1672853.69	1553080.41

Point #	Description	Northing	Easting
113	EDGE OF ASPH	1672838.94	1553058.12
114	EDGE OF ASPH	1672843.87	1553006.00
115	END RADIUS	1672806.99	1553021.74
116	END RADIUS	1672800.86	1553004.08
118	END RADIUS	1672821.52	1552939.96
119	END RADIUS	1672819.17	1552831.07
120	END RADIUS	1672824.12	1552759.16
121	END RADIUS	1672829.28	1552726.93
122	END RADIUS	1672792.00	1552619.60
123	END RADIUS	1672764.35	1552594.18
124	END RADIUS	1672747.64	1552582.57
125	EXIST ROAD EDGE	1672741.58	1552579.48
126	EXIST ROAD EDGE	1672734.32	1552593.74
127	END RADIUS	1672750.82	1552608.91

Point #	Description	Northing	Easting
128	END RADIUS	1672789.77	1552983.90
129	END RADIUS	1672758.29	1553035.30
130	END RADIUS	1672749.07	1553054.83
131	END RADIUS	1672702.87	1553188.36
132	END RADIUS	1672693.11	1553208.75
133	END RADIUS	1672649.03	1553279.12
134	END RADIUS	1672651.37	1553290.02
135	STRP CNTR LINE	1672717.06	1553211.73
136	TBM	1672868.91	1552942.12
137	EXIST ROAD EDGE	1672722.48	1551997.55
138	END RADIUS	1672729.11	1551972.95
139	END RADIUS	1672798.47	1551998.61
140	END RADIUS	1672820.13	1552040.50
141	END RADIUS	1672806.75	1552090.46

Point #	Description	Northing	Easting
142	END RADIUS	1672824.42	1552121.08
143	EDGE OF ASPH	1672873.87	1552134.33
144	WALL CNTR LINE	1672890.83	1552138.78
145	WALL CNTR LINE	1672897.88	1552134.71
146	WALL CNTR LINE	1672914.77	1552071.66
147	WALL CNTR LINE	1672910.70	1552064.61
148	RAMP COR.	1672928.91	1552019.40
149	RAMP COR.	1672947.09	1552092.16
150	RAMP COR.	1672965.52	1552087.56
151	RAMP COR.	1672947.34	1552014.78
152	EDGE OF ASPH	1672939.04	1551981.55
153	EDGE OF ASPH	1672946.95	1551952.03
154	EDGE OF ASPH	1672943.42	1551945.91
155	END RADIUS	1672885.46	1551930.38

Point #	Description	Northing	Easting
156	END RADIUS	1672842.60	1551955.13
157	END RADIUS	1672808.79	1551975.77
158	END RADIUS	1672712.20	1551940.04
159	END RADIUS	1672680.62	1551943.75
160	END RADIUS	1672666.90	1551952.91
161	EXIST ROAD EDGE	1672659.67	1551953.90
162	STRP END	1672861.18	1552028.01
163	AL. MONUMENT	1672878.23	1552305.73

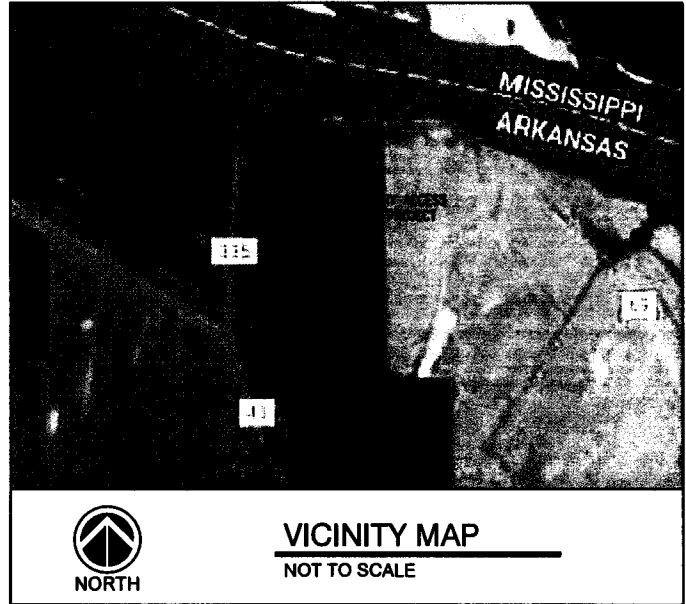

1A OVERALL SITE PLAN
 1" = 80'

REVISIONS:

PROJECT #: 25264.00
 DATE: AUGUST 29, 2018
 DRAWN BY: CBB
 DESIGNER: GJC
 CHECKED BY: RJP

Pickering
 Pickering Firm, Inc.
 Facility Design • Civil Engineering • Surveying •
 Transportation • Natural / Water Resources
 317 South Church Street
 Jonesboro, AR 72401
 870.386.8865

**McCallie Boat Ramps and
 Pkg. Lot
 (Mississippi River) (S)
 McCallie Access
 Desha, Arkansas**

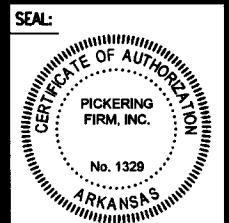

SHEET NUMBER:
C-010
 SHEET 6 OF 15
 DESCRIPTION:
 OVERALL SITE PLAN

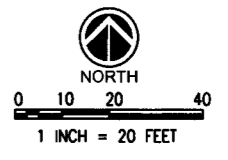

REVISIONS:

PROJECT #: 25264.00
 DATE: AUGUST 29, 2018
 DRAWN BY: CBB
 DESIGNER: GJC
 CHECKED BY: RJP

Pickering
 Pickering Firm, Inc.
 Facility Design • Civil Engineering • Surveying •
 Transportation • Natural / Water Resources
 317 South Church Street
 Jonesboro, AR 72401
 870.336.8863

**McCALLIE BOAT RAMPS AND
 PKG. LOT
 (MISSISSIPPI RIVER) (S)
 McCALLIE ACCESS
 DESHA, ARKANSAS**

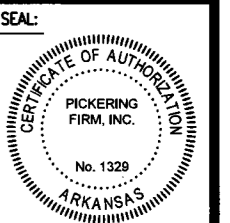

SHEET NUMBER:
C-100
 SHEET 7 OF 15
 DESCRIPTION:
 EXISTING CONDITIONS AND
 DEMOLITION PLAN
 (PRIMARY ACCESS RAMP)

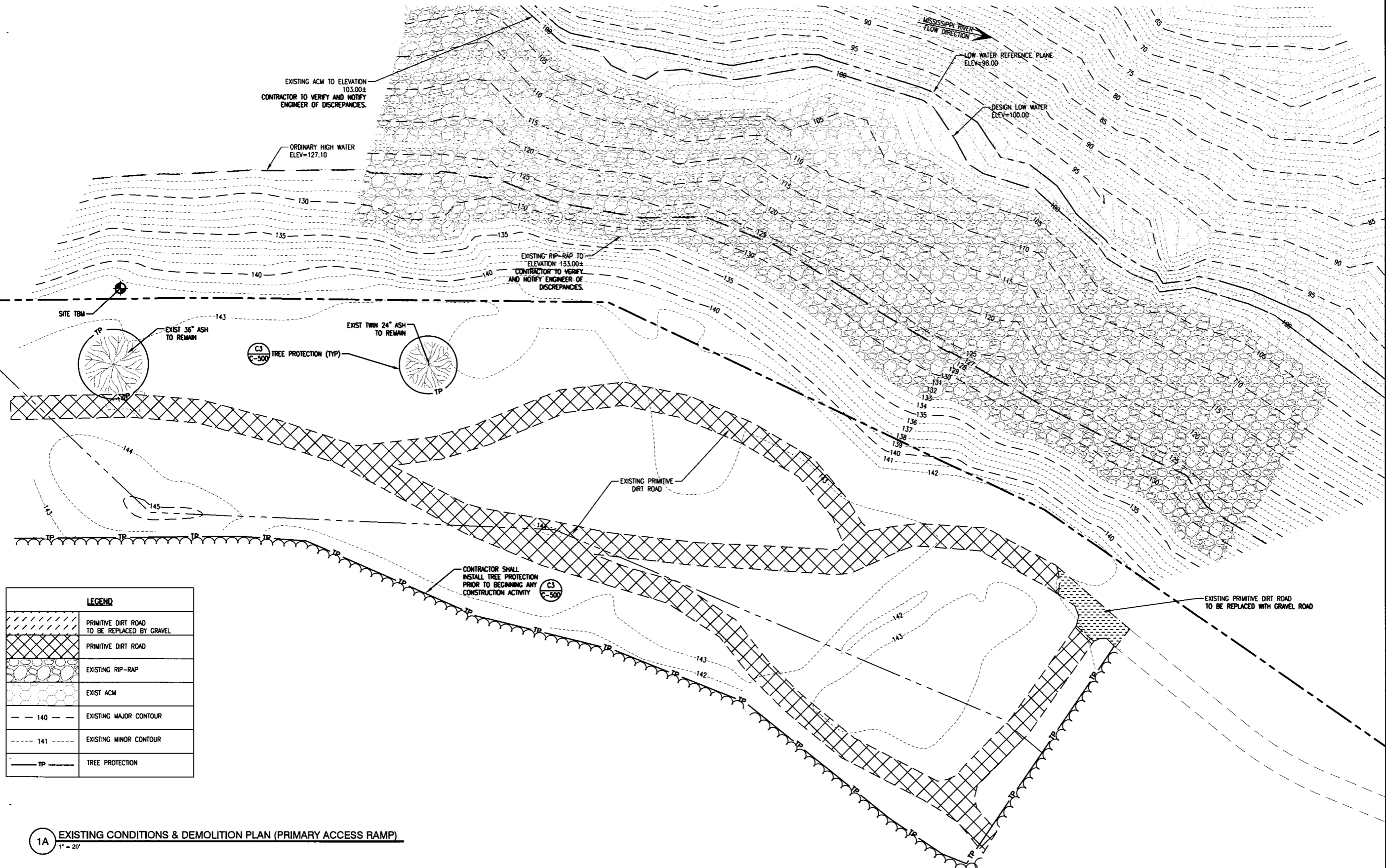

LEGEND	
	PRIMITIVE DIRT ROAD TO BE REPLACED BY GRAVEL
	PRIMITIVE DIRT ROAD
	EXISTING RIP-RAP
	EXIST ACM
	EXISTING MAJOR CONTOUR
	EXISTING MINOR CONTOUR
	TREE PROTECTION

1A EXISTING CONDITIONS & DEMOLITION PLAN (PRIMARY ACCESS RAMP)
 1" = 20'

C:\Users\jrperry\OneDrive\Documents\Projects\18-00001\18-00001.dwg - August 29, 2018

HATCH LEGEND	
	ASPHALT PAVEMENT
	CONCRETE RAMP
	SEED (PER ADOT SECTION 620)
	EXISTING RIP-RAP
	PROPOSED RIP-RAP
	EXISTING ACM
	PROPOSED GRAVEL ROAD

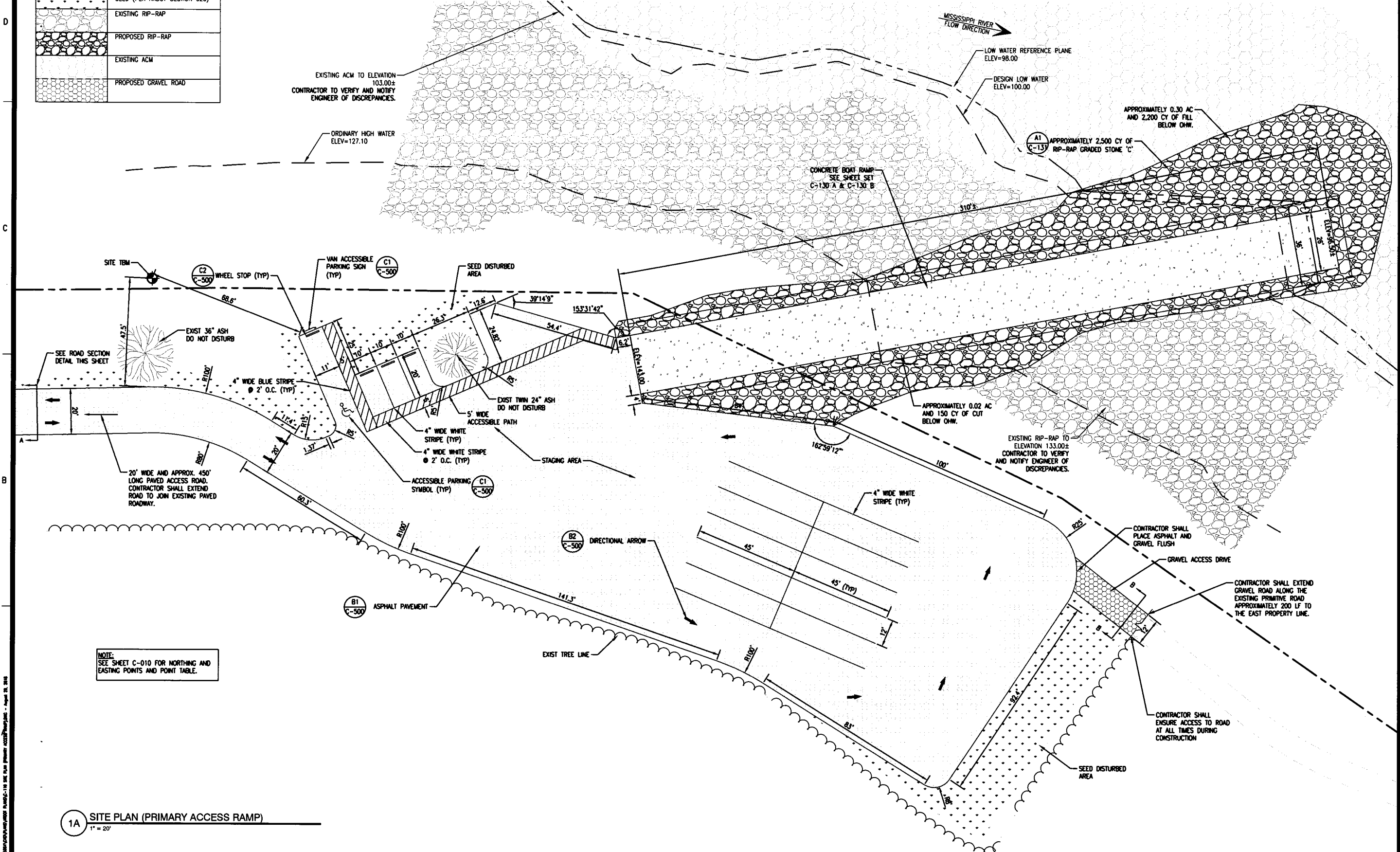
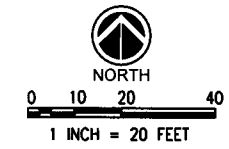
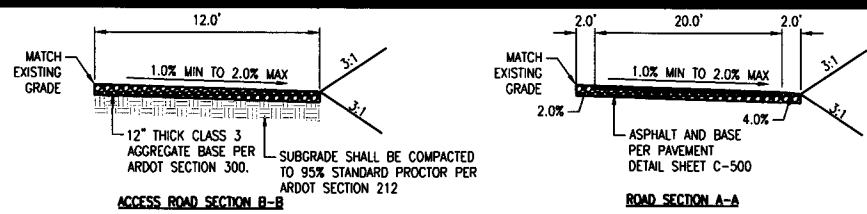

NOTE:
SEE SHEET C-010 FOR NORTHING AND EASTING POINTS AND POINT TABLE.

1A SITE PLAN (PRIMARY ACCESS RAMP)
1" = 20'

REVISIONS:	

PROJECT #: 25264.00
DATE: AUGUST 29, 2018
DRAWN BY: CBB
DESIGNER: GJC
CHECKED BY: RJP

Pickering
Pickering Firm, Inc.
Facility Design • Civil Engineering • Surveying •
Transportation • Natural / Water Resources
317 South Church Street
Jonesboro, AR 72401
870.536.6663

**MCCALLIE BOAT RAMPS AND
PKG. LOT
(MISSISSIPPI RIVER) (S)
MCCALLIE ACCESS
DESHA, ARKANSAS**

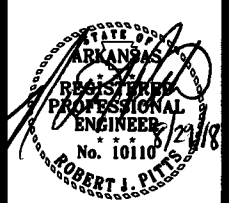

SHEET NUMBER:
C-110
SHEET 8 OF 15
DESCRIPTION:
SITE PLAN
(PRIMARY ACCESS RAMP)

LEGEND	
	CONCRETE WASHOUT
	CONSTRUCTION EGRESS W/ WASH DOWN
	RIP RAP SLOPE PROTECTION
	EXISTING RIP-RAP
	EXISTING ACM
	WIRE BACKED SILT FENCE
	DOUBLE ROW WIRE BACKED SILT FENCE
	TREE PROTECTION
	LIMITS OF DISTURBANCE

	PROPOSED MAJOR CONTOUR
	PROPOSED MINOR CONTOUR
	EXISTING MAJOR CONTOUR
	EXISTING MINOR CONTOUR

TO BE USED IF AND WHERE DIRECTED BY THE ENGINEER:
ROCK DITCH CHECKS = 30 CY

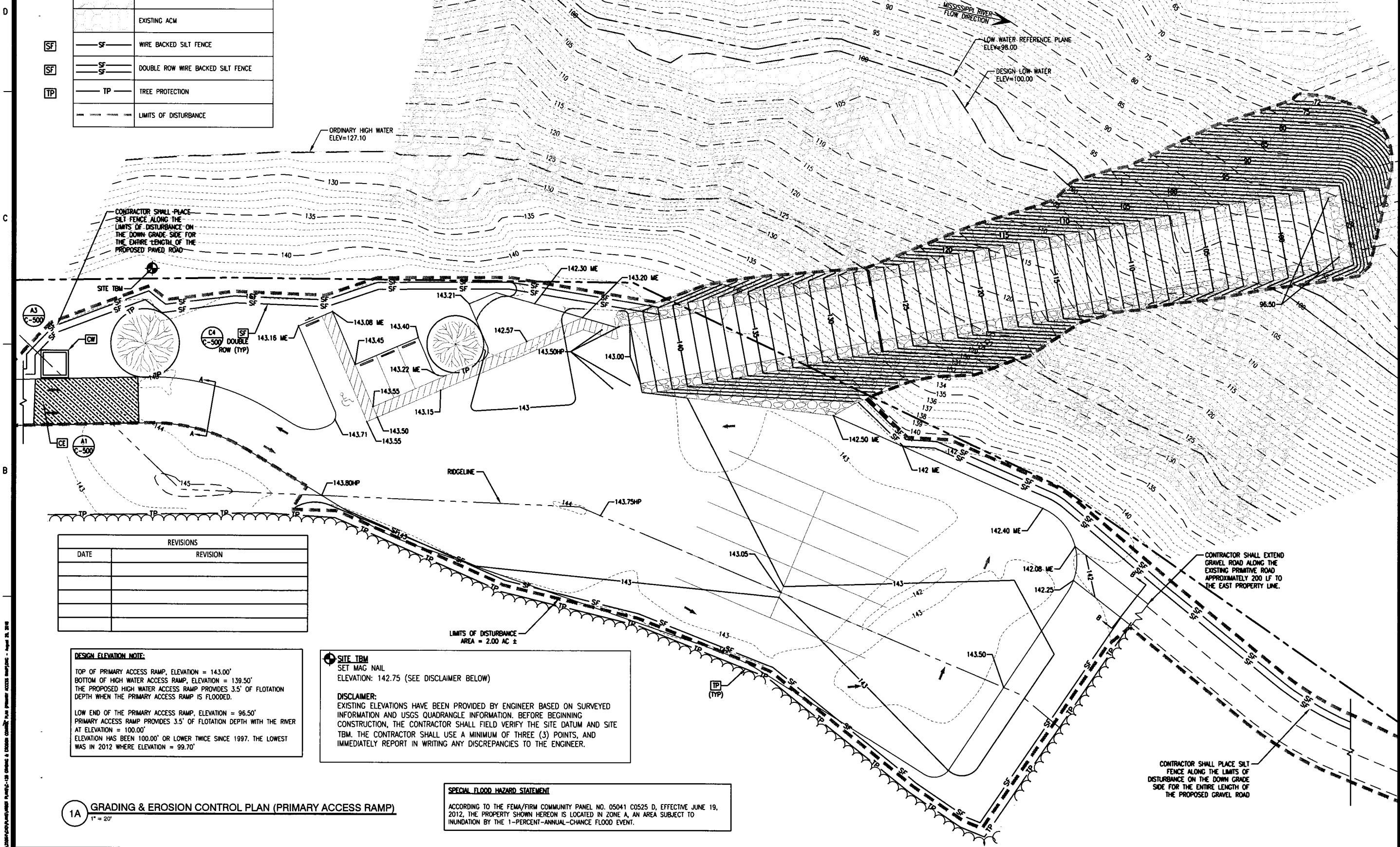
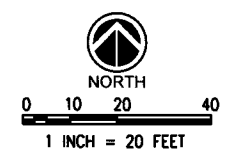
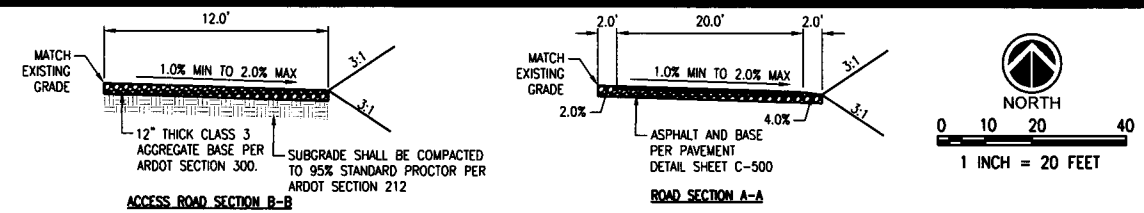

REVISIONS	
DATE	REVISION

DESIGN ELEVATION NOTE:
TOP OF PRIMARY ACCESS RAMP, ELEVATION = 143.00'
BOTTOM OF HIGH WATER ACCESS RAMP, ELEVATION = 139.50'
THE PROPOSED HIGH WATER ACCESS RAMP PROVIDES 3.5' OF FLOTATION DEPTH WHEN THE PRIMARY ACCESS RAMP IS FLOODED.

LOW END OF THE PRIMARY ACCESS RAMP, ELEVATION = 96.50'
PRIMARY ACCESS RAMP PROVIDES 3.5' OF FLOTATION DEPTH WITH THE RIVER AT ELEVATION = 100.00'
ELEVATION HAS BEEN 100.00' OR LOWER TWICE SINCE 1997. THE LOWEST WAS IN 2012 WHERE ELEVATION = 99.70'

SITE TBM
SET MAC NAIL
ELEVATION: 142.75 (SEE DISCLAIMER BELOW)

DISCLAIMER:
EXISTING ELEVATIONS HAVE BEEN PROVIDED BY ENGINEER BASED ON SURVEYED INFORMATION AND USGS QUADRANGLE INFORMATION. BEFORE BEGINNING CONSTRUCTION, THE CONTRACTOR SHALL FIELD VERIFY THE SITE DATUM AND SITE TBM. THE CONTRACTOR SHALL USE A MINIMUM OF THREE (3) POINTS, AND IMMEDIATELY REPORT IN WRITING ANY DISCREPANCIES TO THE ENGINEER.

SPECIAL FLOOD HAZARD STATEMENT
ACCORDING TO THE FEMA/FIRM COMMUNITY PANEL NO. 05041 C0525 D, EFFECTIVE JUNE 19, 2012, THE PROPERTY SHOWN HEREON IS LOCATED IN ZONE A, AN AREA SUBJECT TO INUNDATION BY THE 1-PERCENT-ANNUAL-CHANCE FLOOD EVENT.

1A GRADING & EROSION CONTROL PLAN (PRIMARY ACCESS RAMP)
1" = 20'

REVISIONS:	

PROJECT #: 25264.00
DATE: AUGUST 29, 2018
DRAWN BY: CBB
DESIGNER: GJC
CHECKED BY: RJP

Pickering
Pickering Firm, Inc.
Facility Design • Civil Engineering • Surveying •
Transportation • Natural / Water Resources
317 South Church Street
Jonesboro, AR 72401
870.336.6663

**MCCALLIE BOAT RAMPS AND
PKG. LOT
(MISSISSIPPI RIVER) (S)
MCCALLIE ACCESS
DESHA, ARKANSAS**

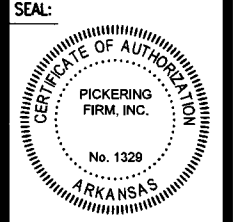

SHEET NUMBER:
C-120
SHEET 9 OF 15
DESCRIPTION:
GRADING AND EROSION
CONTROL PLAN
(PRIMARY ACCESS RAMP)

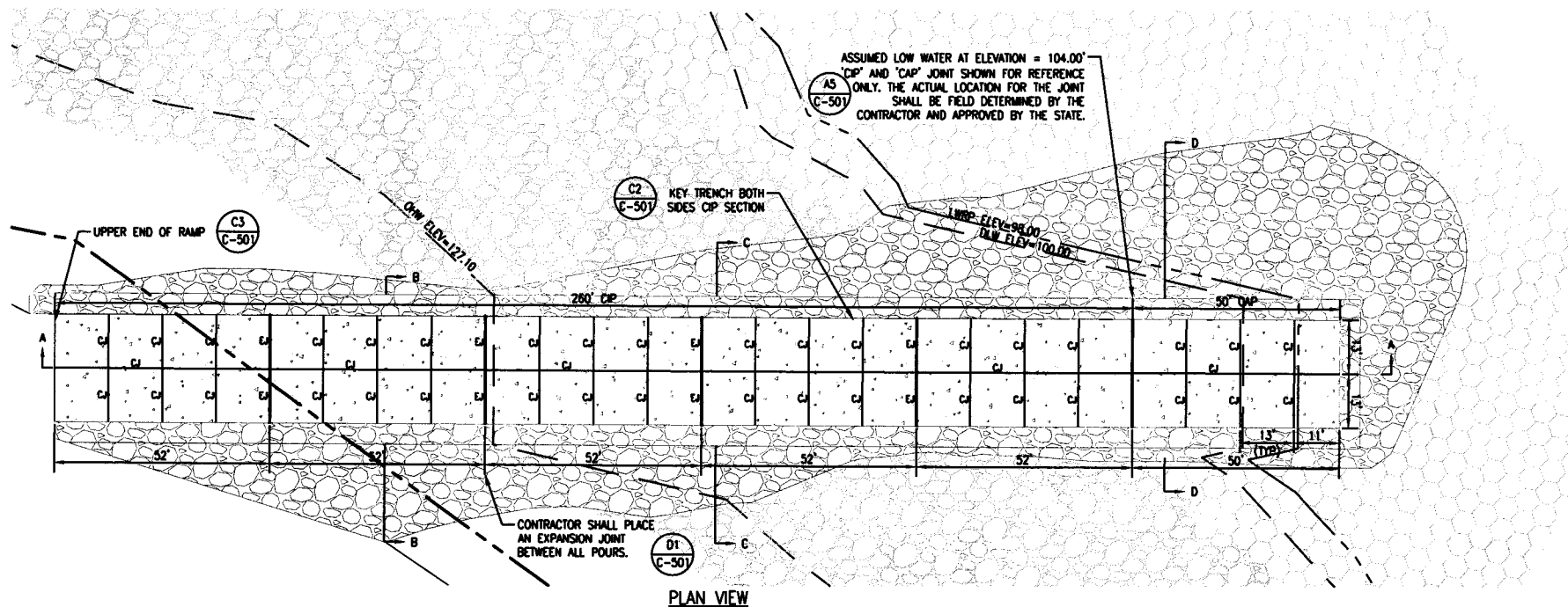

- ABBREVIATION LEGEND**
- C1 C-501 CAP CAST AND PUSH 'CAP' CONCRETE SLAB
 - B2 C-501 CIP CAST IN PLACE 'CIP' CONCRETE SLAB
 - D1 C-501 EJ EXPANSION JOINT
 - D2 C-501 CJ CONTROL JOINT
 - LWRP LOW WATER REFERENCE PLANE
 - OHW ORDINARY HIGH WATER
 - DLW DESIGN LOW WATER

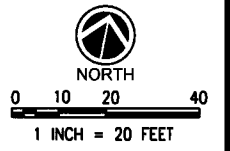

REVISIONS:

PROJECT #: 25264.00
 DATE: AUGUST 29, 2018
 DRAWN BY: CBB
 DESIGNER: GJC
 CHECKED BY: RJP

Pickering
 Pickering Firm, Inc.
 Facility Design - Civil Engineering - Surveying -
 Transportation - Natural / Water Resources
 317 South Church Street
 Jonesboro, AR 72401
 870.336.6663

**MCCALLIE BOAT RAMPS AND
 PKG. LOT
 (MISSISSIPPI RIVER) (S)
 MCCALLIE ACCESS
 DESHA, ARKANSAS**

SEAL:

 REGISTERED PROFESSIONAL ENGINEER
 No. 10110
 ROBERT J. PITS

SHEET NUMBER:
C-130
 SHEET 10 OF 15
 DESCRIPTION:
 RAMP PLAN AND PROFILE
 (PRIMARY ACCESS RAMP)

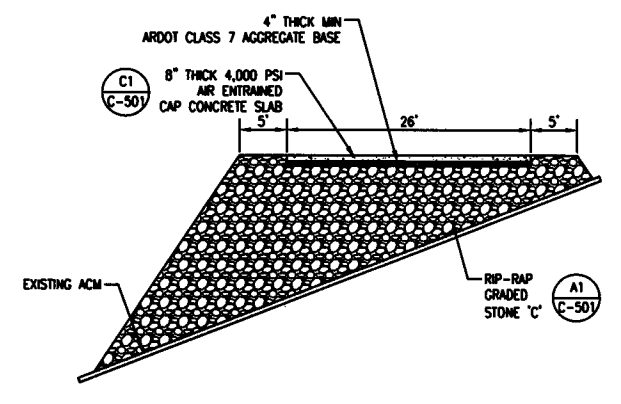
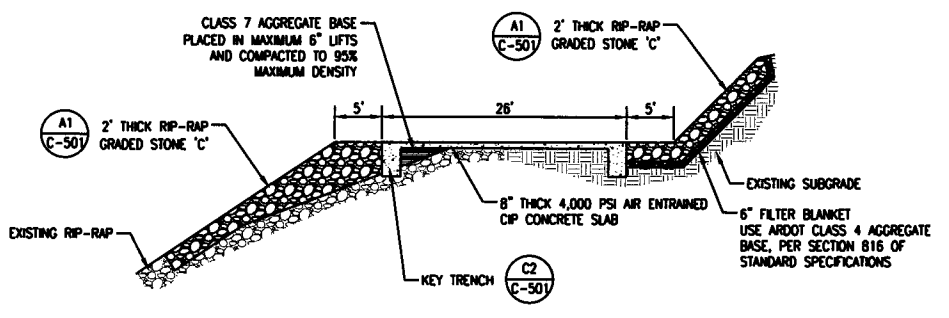
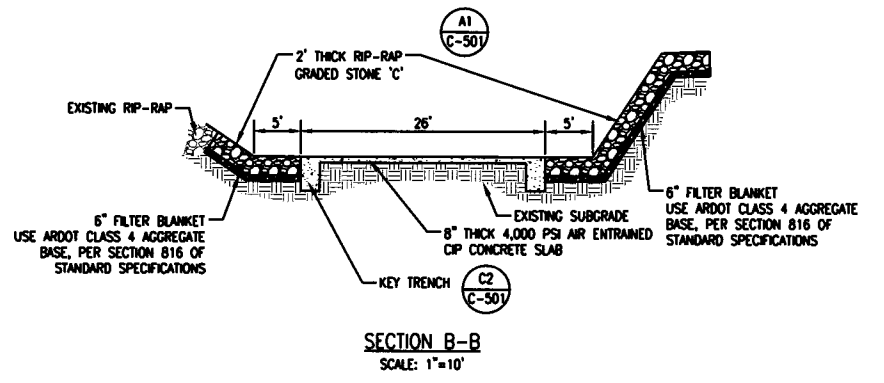
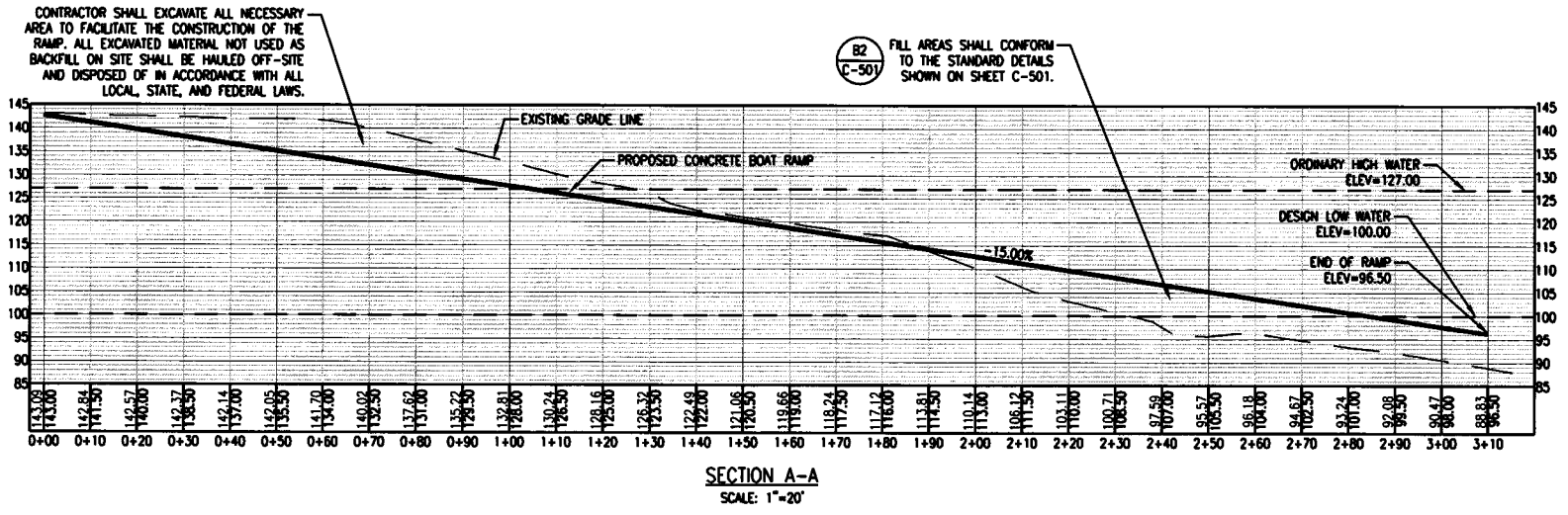

14252000/000/0000 PLAN/C-130 RAMP PLAN AND PROFILE (PRIMARY ACCESS RAMP) DESHA, ARKANSAS - August 29, 2018



1A EXISTING CONDITIONS (HIGH WATER RAMP WITH SCENIC OVERLOOK)
1" = 20'

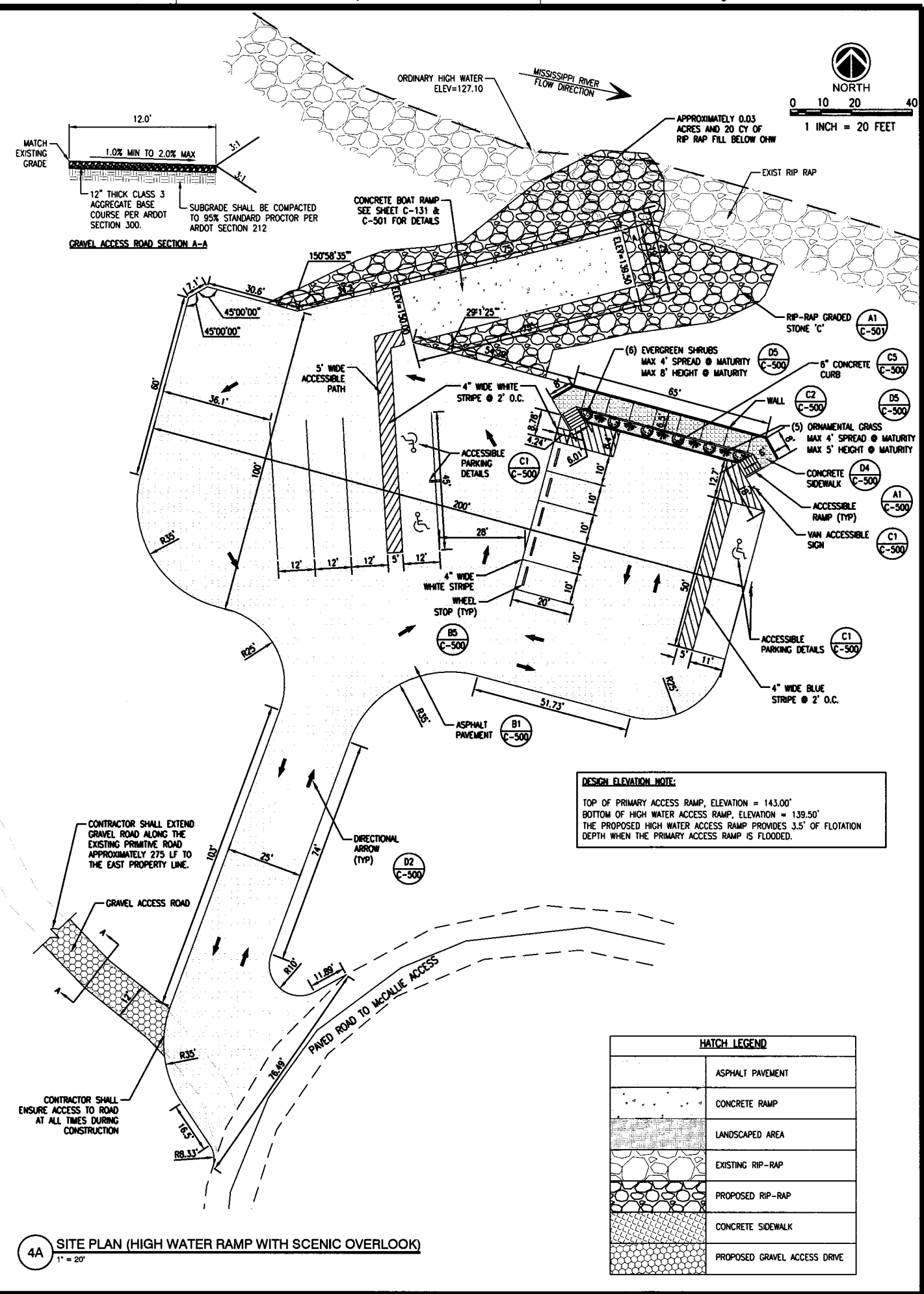

4A SITE PLAN (HIGH WATER RAMP WITH SCENIC OVERLOOK)
1" = 20'

REVISIONS:

PROJECT #: 25264.00
 DATE: AUGUST 29, 2018
 DRAWN BY: CBB
 DESIGNER: GJC
 CHECKED BY: RJP

Pickering
 Pickering Firm, Inc.
 Facility Design • Civil Engineering • Surveying •
 Transportation • Natural / Water Resources
 317 South Church Street
 Jonesboro, AR 72401
 870.336.6663

**MCCALLIE BOAT RAMPS AND
 PKG. LOT
 (MISSISSIPPI RIVER) (S)
 MCCALLIE ACCESS
 DESHA, ARKANSAS**



SHEET NUMBER:
C-101
 SHEET 11 OF 15
 DESCRIPTION:
 EXISTING CONDITIONS AND
 SITE PLAN (HIGH WATER RAMP
 WITH SCENIC OVERLOOK)

REVISIONS	
DATE	REVISION

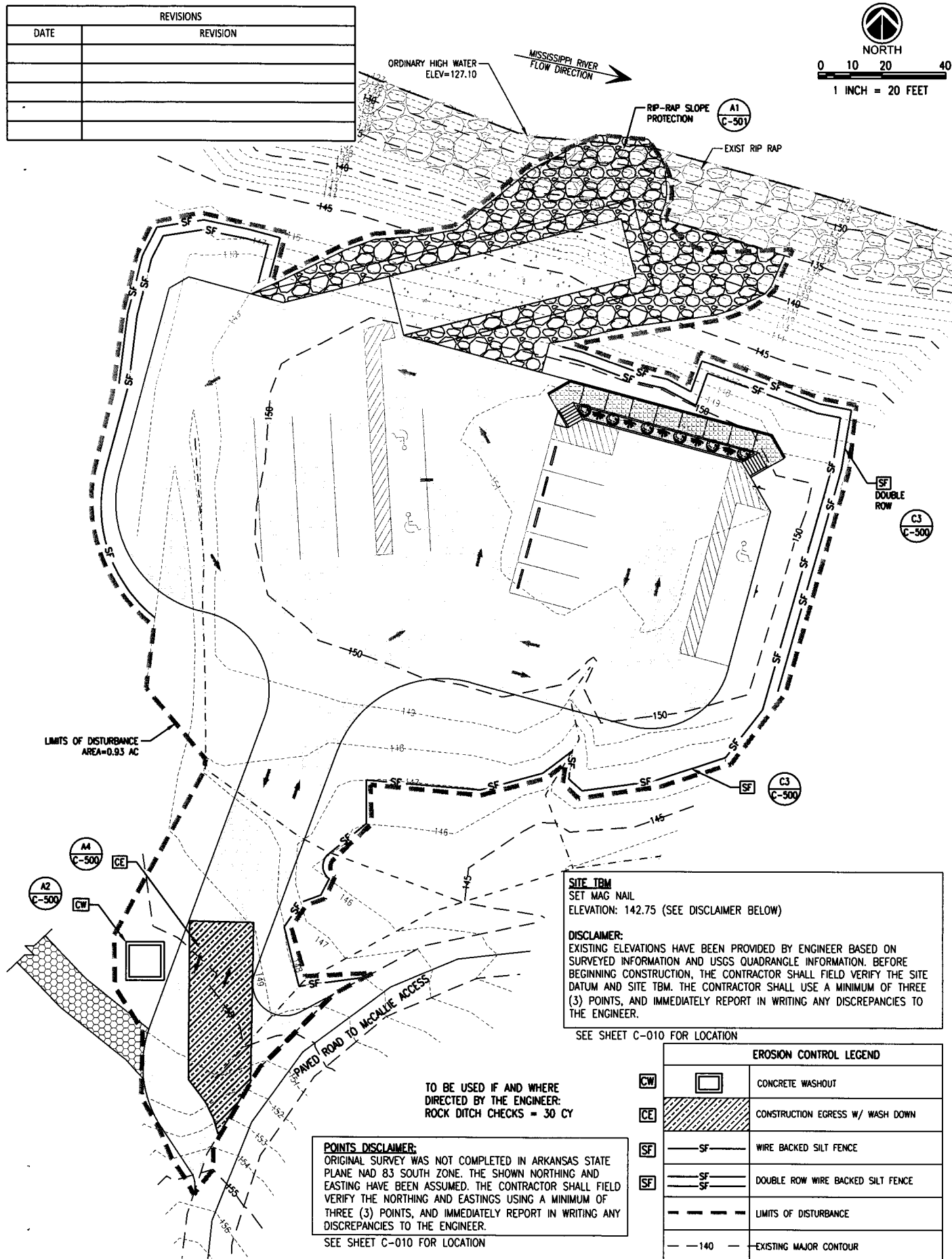

SITE TBM
SET MAG NAIL
ELEVATION: 142.75 (SEE DISCLAIMER BELOW)

DISCLAIMER:
EXISTING ELEVATIONS HAVE BEEN PROVIDED BY ENGINEER BASED ON SURVEYED INFORMATION AND USGS QUADRANGLE INFORMATION. BEFORE BEGINNING CONSTRUCTION, THE CONTRACTOR SHALL FIELD VERIFY THE SITE DATUM AND SITE TBM. THE CONTRACTOR SHALL USE A MINIMUM OF THREE (3) POINTS, AND IMMEDIATELY REPORT IN WRITING ANY DISCREPANCIES TO THE ENGINEER.

SEE SHEET C-010 FOR LOCATION

EROSION CONTROL LEGEND	
CW	CONCRETE WASHOUT
CE	CONSTRUCTION EGRESS W/ WASH DOWN
SF	WIRE BACKED SILT FENCE
SF	DOUBLE ROW WIRE BACKED SILT FENCE
- - -	LIMITS OF DISTURBANCE
- - 140 - -	EXISTING MAJOR CONTOUR
- - 141 - -	EXISTING MINOR CONTOUR

POINTS DISCLAIMER:
ORIGINAL SURVEY WAS NOT COMPLETED IN ARKANSAS STATE PLANE NAD 83 SOUTH ZONE. THE SHOWN NORTHING AND EASTING HAVE BEEN ASSUMED. THE CONTRACTOR SHALL FIELD VERIFY THE NORTHING AND EASTINGS USING A MINIMUM OF THREE (3) POINTS, AND IMMEDIATELY REPORT IN WRITING ANY DISCREPANCIES TO THE ENGINEER.

SEE SHEET C-010 FOR LOCATION

TO BE USED IF AND WHERE DIRECTED BY THE ENGINEER:
ROCK DITCH CHECKS = 30 CY

1A EROSION CONTROL PLAN (HIGH WATER ACCESS RAMP WITH SCENIC OVERLOOK)
1" = 20'

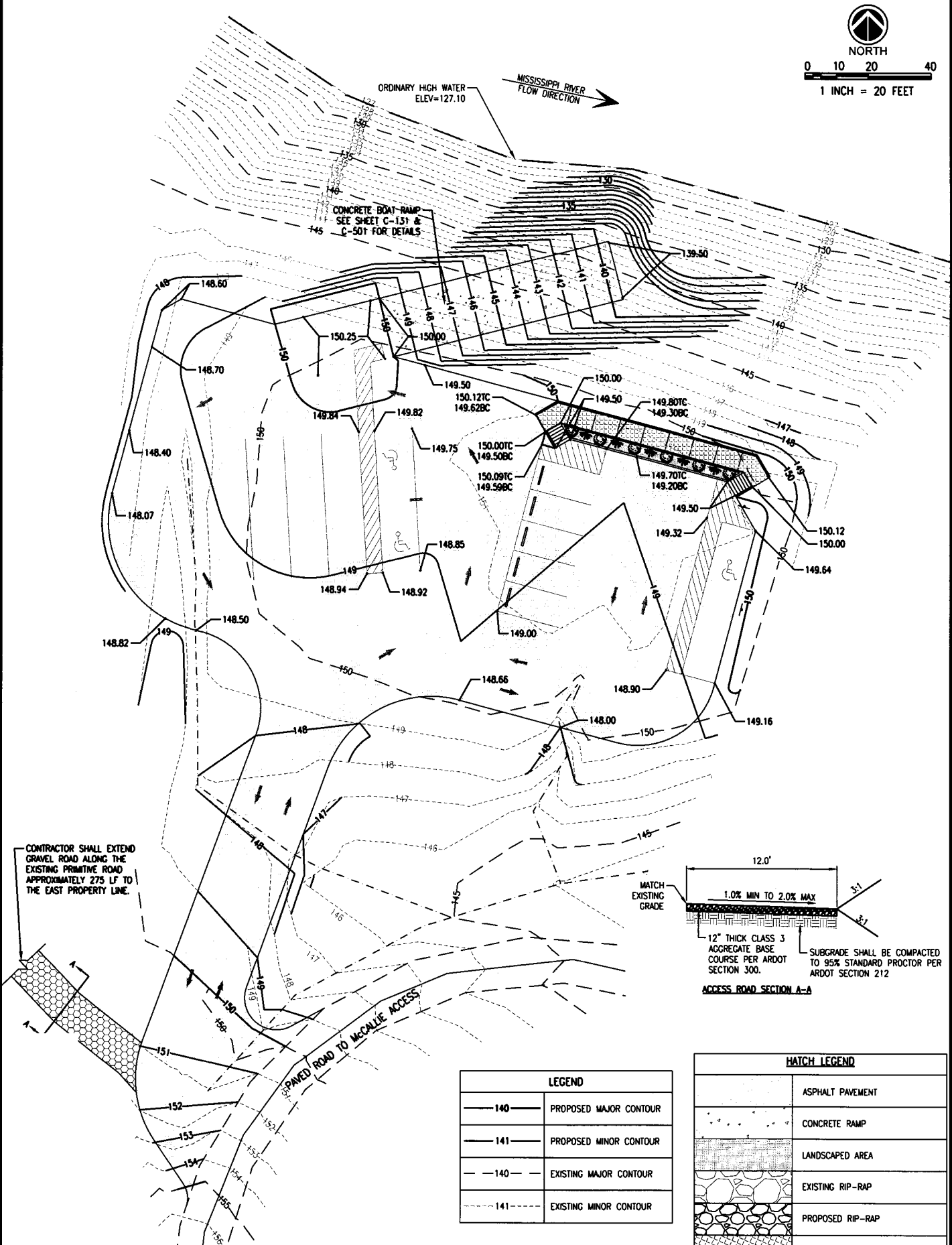

CONTRACTOR SHALL EXTEND GRAVEL ROAD ALONG THE EXISTING PRIMITIVE ROAD APPROXIMATELY 275 LF TO THE EAST PROPERTY LINE.

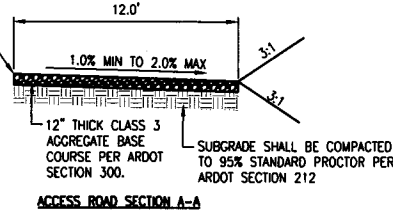

LEGEND	
- - 140 - -	PROPOSED MAJOR CONTOUR
- - 141 - -	PROPOSED MINOR CONTOUR
- - 140 - -	EXISTING MAJOR CONTOUR
- - 141 - -	EXISTING MINOR CONTOUR

HATCH LEGEND	
[Hatch Pattern]	ASPHALT PAVEMENT
[Hatch Pattern]	CONCRETE RAMP
[Hatch Pattern]	LANDSCAPED AREA
[Hatch Pattern]	EXISTING RIP-RAP
[Hatch Pattern]	PROPOSED RIP-RAP
[Hatch Pattern]	CONCRETE SIDEWALK
[Hatch Pattern]	PROPOSED GRAVEL ACCESS DRIVE

4A GRADING & DRAINAGE PLAN (HIGH WATER ACCESS RAMP WITH SCENIC OVERLOOK)
1" = 20'

REVISIONS:	

PROJECT #: 25264.00
DATE: AUGUST 29, 2018
DRAWN BY: CBB
DESIGNER: GJC
CHECKED BY: RJP

Pickering
Pickering Firm, Inc.
Facility Design • Civil Engineering • Surveying •
Transportation • Natural / Water Resources
317 South Church Street
Jonesboro, AR 72401
870.336.6663

**MCCALLIE BOAT RAMPS AND
PKG. LOT
(MISSISSIPPI RIVER) (S)
MCCALLIE ACCESS
DESHA, ARKANSAS**



SHEET NUMBER:
C-121
SHEET 12 OF 15
DESCRIPTION:
GRADING AND EROSION CONTROL
PLAN (HIGH WATER RAMP WITH
SCENIC OVERLOOK)

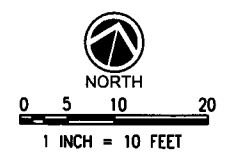

- ABBREVIATION LEGEND**
- B2
C-501 CIP CAST IN PLACE 'CIP' CONCRETE SLAB
 - D1
C-501 EJ EXPANSION JOINT
 - D2
C-501 CJ CONTROL JOINT
 - OHW ORDINARY HIGH WATER

REVISIONS:

PROJECT #: 25264.00
 DATE: AUGUST 29, 2018
 DRAWN BY: CBB
 DESIGNER: GJC
 CHECKED BY: RJP

Pickering
 Pickering Firm, Inc.
 Facility Design • Civil Engineering • Surveying •
 Transportation • Natural / Water Resources
 317 South Church Street
 Jonesboro, AR 72401
 870.336.6663

**McCALLIE BOAT RAMPS AND
 PKG. LOT
 (MISSISSIPPI RIVER) (S)
 McCALLIE ACCESS
 DESHA, ARKANSAS**

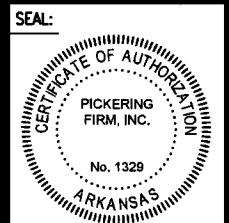

SHEET NUMBER:
C-131
 SHEET 13 OF 15
 DESCRIPTION:
 RAMP PLAN AND PROFILE
 (HIGH WATER RAMP WITH
 SCENIC OVERLOOK)

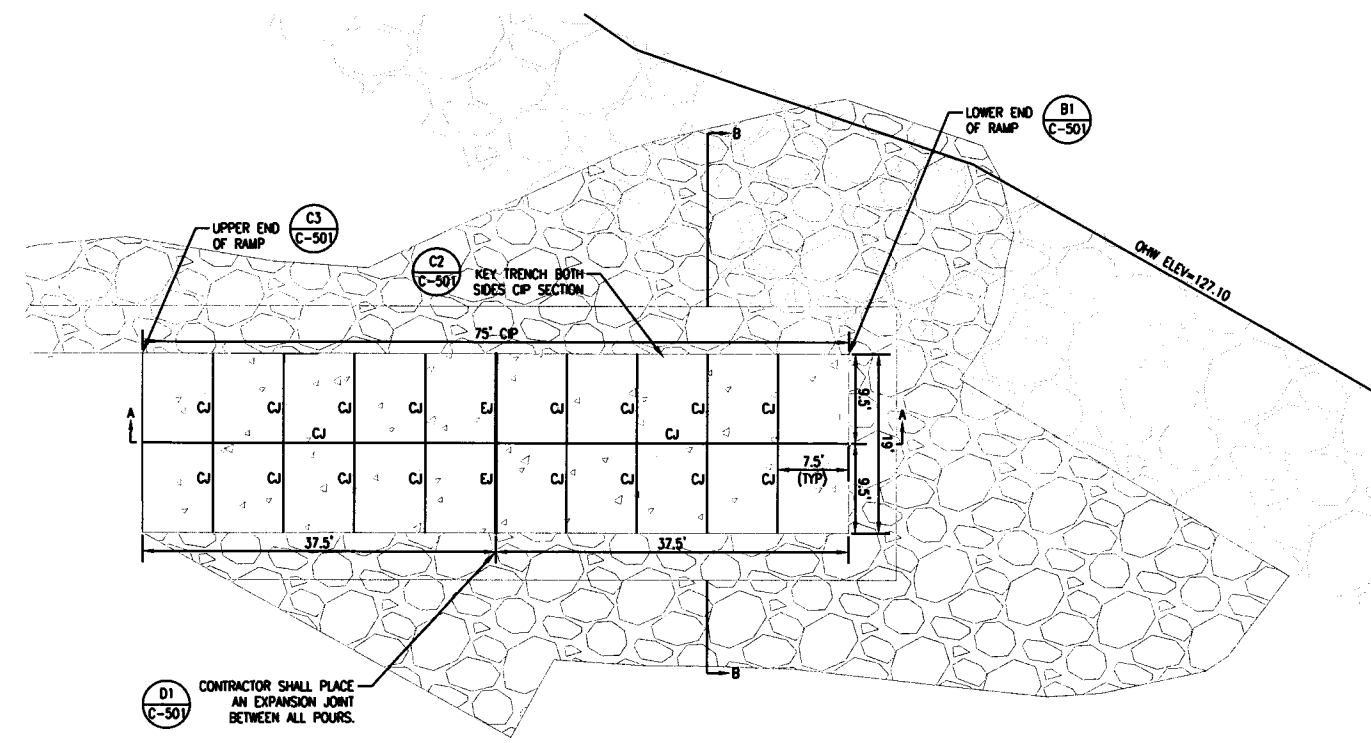

PLAN VIEW

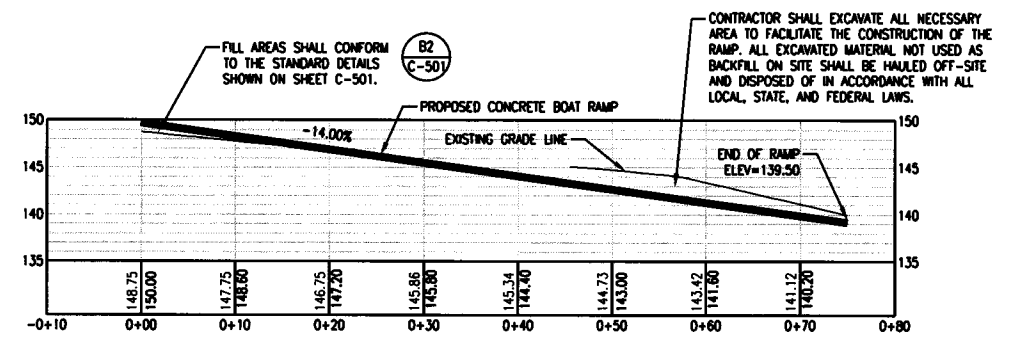

SECTION A-A
 SCALE: 1"=10'

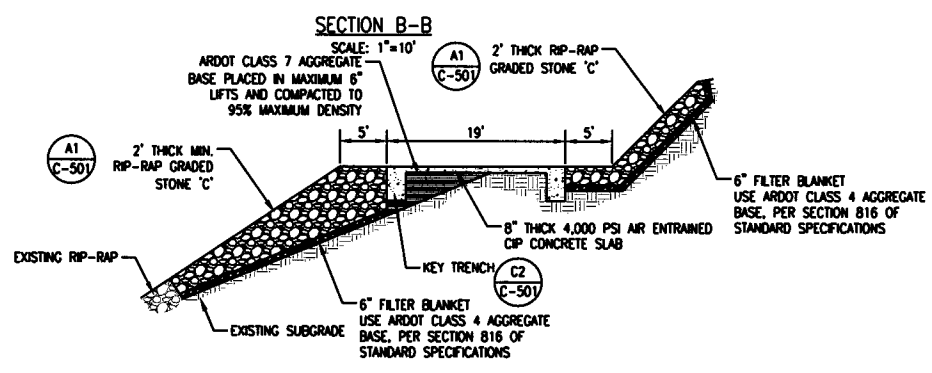

SECTION B-B
 SCALE: 1"=10'

ALL DIMENSIONS UNLESS OTHERWISE NOTED. RAMP PLAN AND PROFILE. DRAWING NO. C-131. DATE: AUGUST 29, 2018.

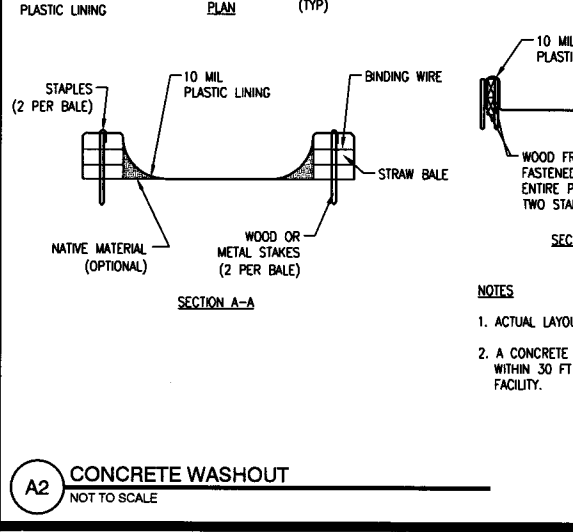
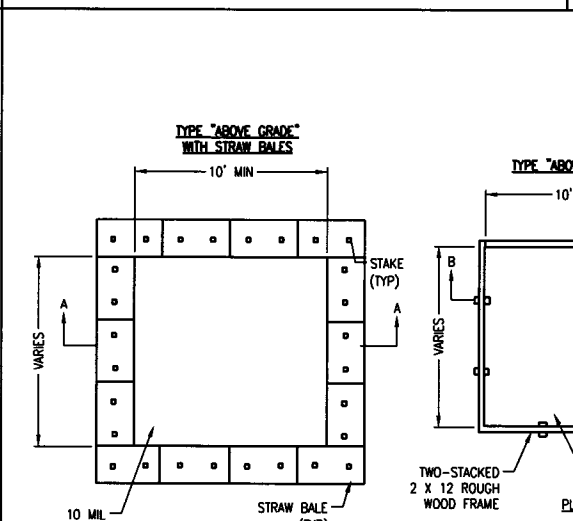
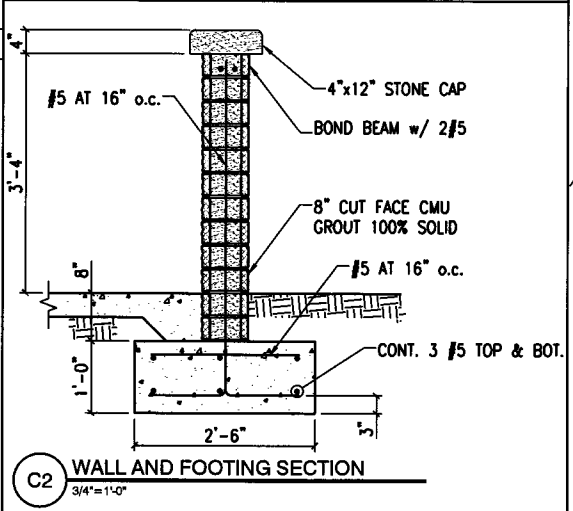
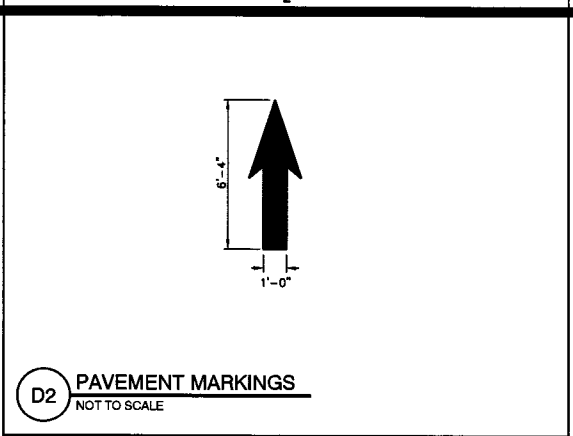
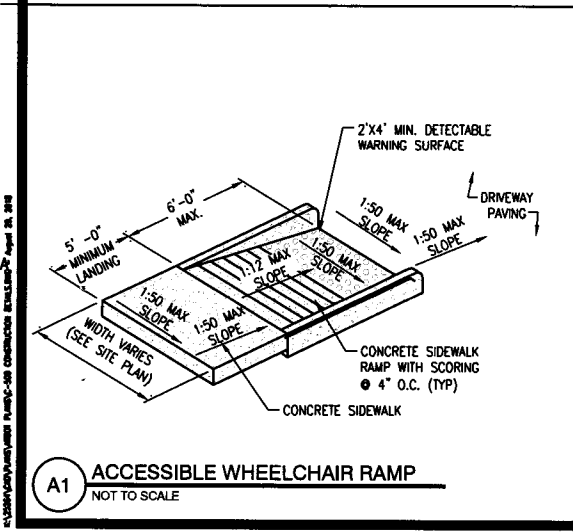
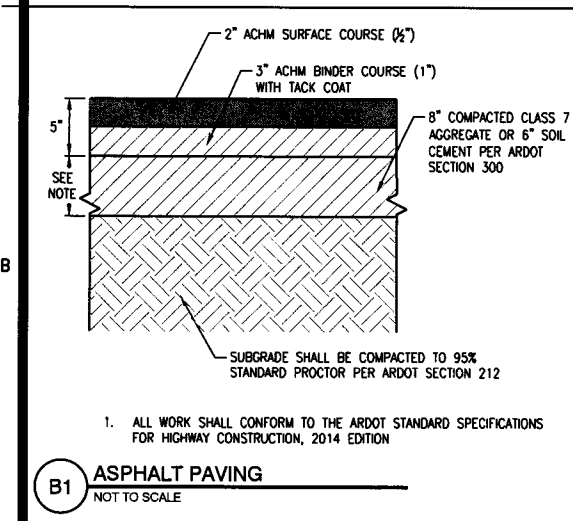
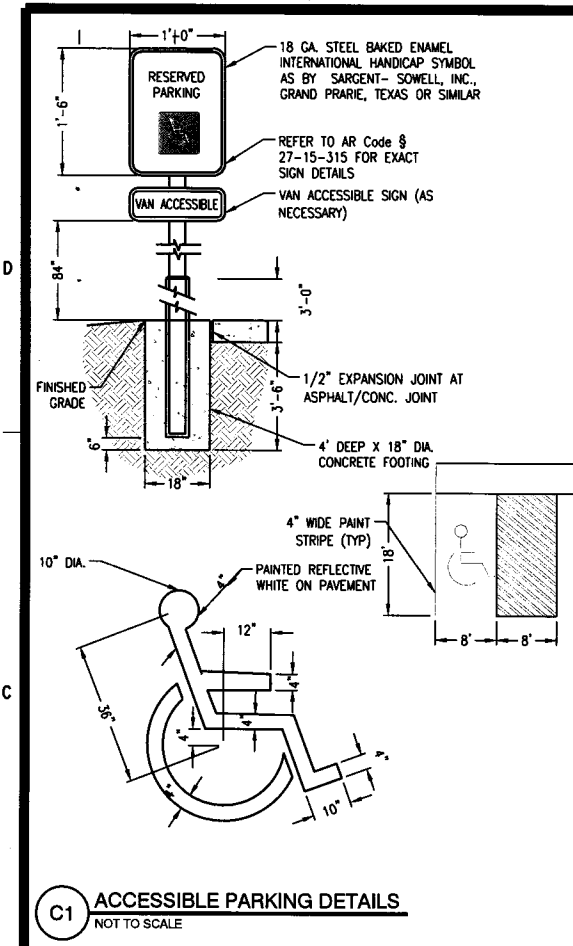

CONSTRUCTION NOTES FOR FABRICATED SILT FENCE

1. WOVEN WIRE FENCE TO BE FASTENED SECURELY TO FENCE POSTS WITH WIRE TIES OR STAPLES.
2. FILTER CLOTH TO BE FASTENED SECURELY TO SILT FENCE WITH TIES SPACED EVERY 24" AT TOP AND MID-SECTION.
3. WHEN TWO SECTIONS OR FILTER CLOTH ADJOIN EACH OTHER THEY SHALL BE OVERLAPPED BY (6) INCHES AND FOLDED.
4. LOCATE POSTS DOWNSLOPE OF FABRIC FOR FENCE SUPPORT.
5. MAINTENANCE SHALL BE PERFORMED AS NEEDED AND MATERIAL REMOVED WHEN "BULGES" DEVELOP IN THE SILT FENCE.

POSTS: STEEL EITHER "T" OR "U" TYPE
 POSTS: LOCATED MAXIMUM 8' OC
 FENCE: PER LOCAL REQUIREMENTS OR WOVEN WIRE, 14 GA 6" MAX MESH OPENING
 FILTER CLOTH: FILTER X, MIRAFI 100X, STABI-LINKA T140N OR APPROVED EQUAL
 PREFABRICATED UNIT: GEOTAB, ENVIROFENCE, OR APPROVED EQUAL.

6. INDICATED ON EROSION CONTROL PLANS AS _____ SF _____

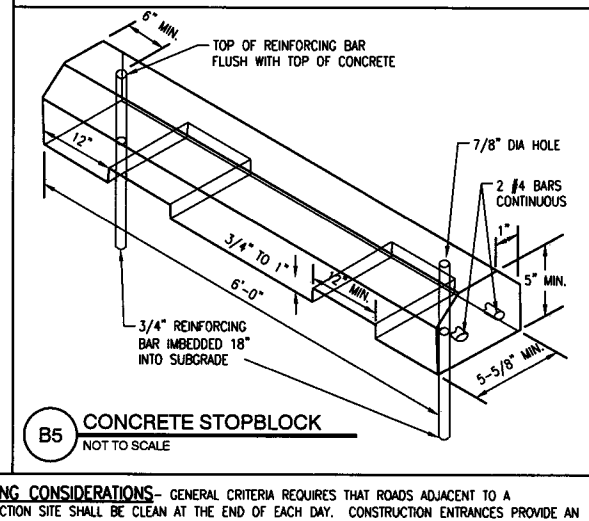
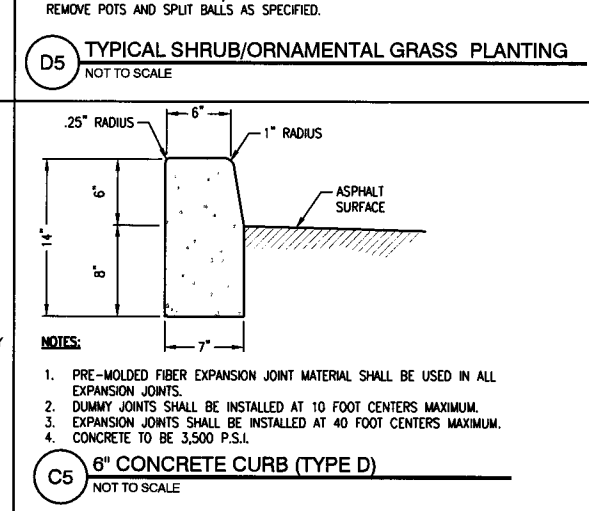
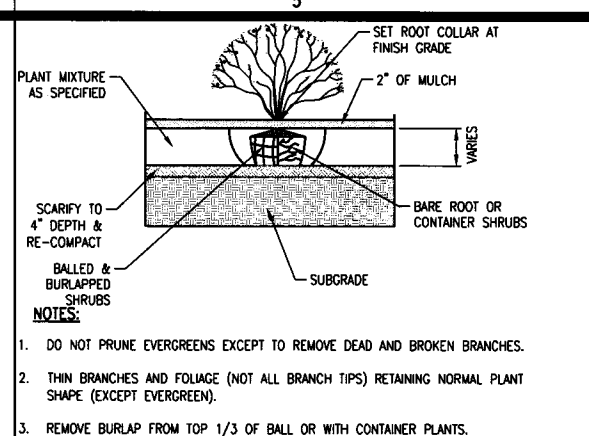
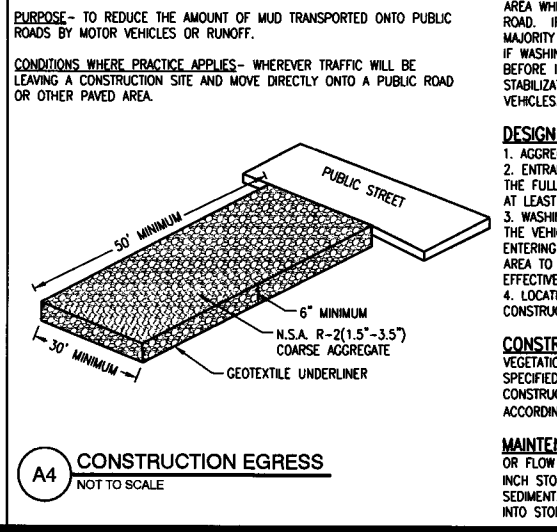
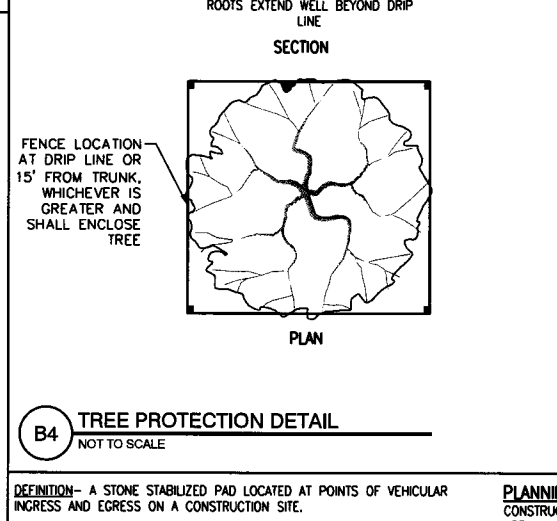
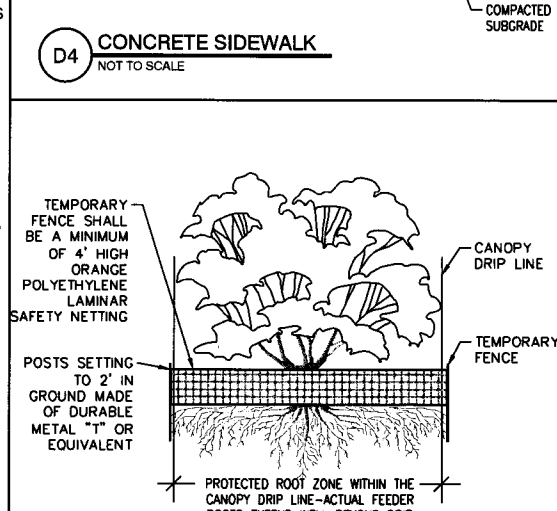
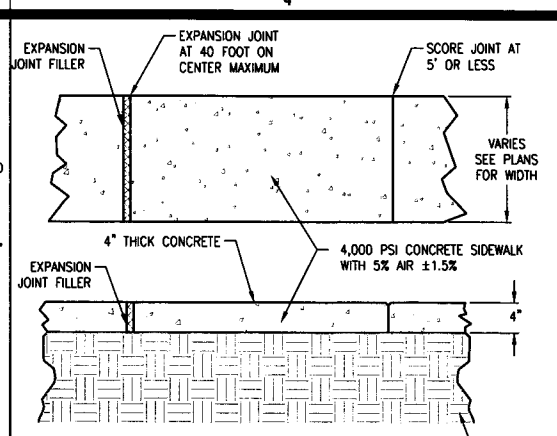
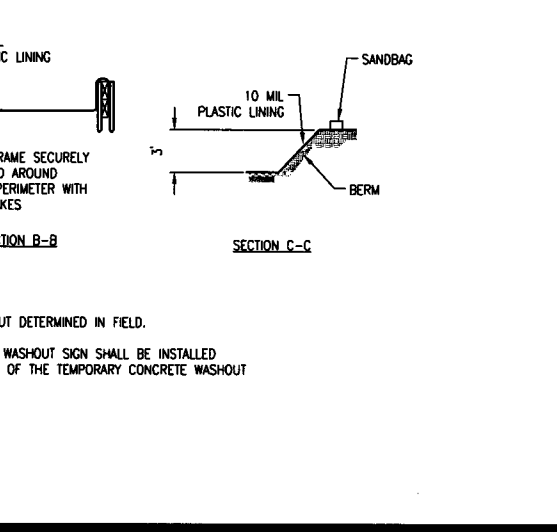
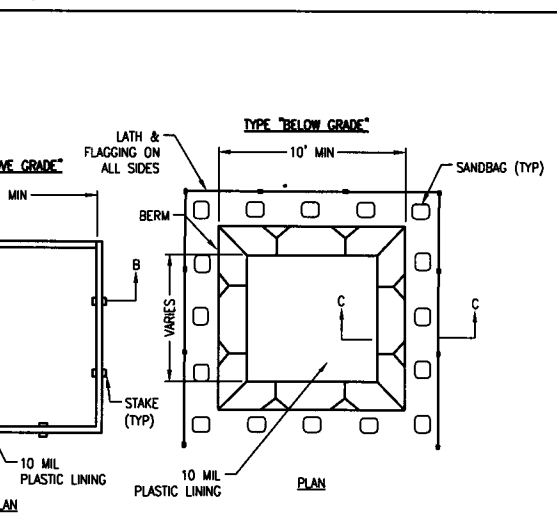
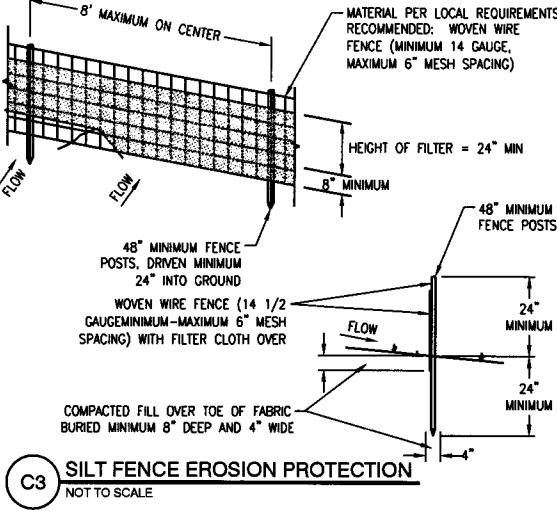

DEFINITION - A STONE STABILIZED PAD LOCATED AT POINTS OF VEHICULAR INGRESS AND EGRESS ON A CONSTRUCTION SITE.

PURPOSE - TO REDUCE THE AMOUNT OF MUD TRANSPORTED ONTO PUBLIC ROADS BY MOTOR VEHICLES OR RUNOFF.

CONDITIONS WHERE PRACTICE APPLIES - WHEREVER TRAFFIC WILL BE LEAVING A CONSTRUCTION SITE AND MOVE DIRECTLY ONTO A PUBLIC ROAD OR OTHER PAVED AREA.

PLANNING CONSIDERATIONS - GENERAL CRITERIA REQUIRES THAT ROADS ADJACENT TO A CONSTRUCTION SITE SHALL BE CLEAN AT THE END OF EACH DAY. CONSTRUCTION ENTRANCES PROVIDE AN AREA WHERE MUD CAN BE REMOVED FROM CONSTRUCTION VEHICLE TIRES BEFORE THEY ENTER A PUBLIC ROAD. IF THE ACTION OF VEHICLE TRAVELING OVER THE GRAVEL PAD IS NOT SUFFICIENT TO REMOVE THE MAJORITY OF THE MUD, THEN THE TIRES MUST BE WASHED BEFORE THE VEHICLE ENTERS A PUBLIC ROAD. IF WASHING IS USED, PROVISIONS MUST BE MADE TO INTERCEPT THE WASH WATER AND TRAP THE SEDIMENT BEFORE IT IS CARRIED OFF-SITE. CONSTRUCTION ENTRANCES SHOULD BE USED IN CONJUNCTION WITH THE STABILIZATION OF CONSTRUCTION ROADS TO REDUCE THE AMOUNT OF MUD PICKED UP BY CONSTRUCTION VEHICLES.

DESIGN CRITERIA

1. AGGREGATE SIZE - N.S.A. R-2(1.5"-3.5") SHOULD BE USED.
2. ENTRANCE DIMENSIONS - THE AGGREGATE LAYER MUST BE AT LEAST 6 INCHES THICK. IT MUST EXTEND THE FULL WIDTH OF THE VEHICULAR INGRESS AND EGRESS AREA. THE LENGTH OF THE ENTRANCE MUST BE AT LEAST 50 FEET.
3. WASHING - IF CONDITIONS ON THE SITE ARE SUCH THAT THE MAJORITY OF THE MUD IS NOT REMOVED BY THE VEHICLES TRAVELING OVER THE GRAVEL, THEN THE TIRES OF THE VEHICLES MUST BE WASHED BEFORE ENTERING A PUBLIC ROAD. WASH WATER MUST BE CARRIED AWAY FROM THE ENTRANCE TO A SETTLING AREA TO REMOVE SEDIMENT. A WASH RACK MAY ALSO BE USED TO MAKE WASHING MORE CONVENIENT AND EFFECTIVE.
4. LOCATION - THE ENTRANCE SHOULD BE LOCATED TO PROVIDE FOR MAXIMUM UTILITY BY ALL CONSTRUCTION VEHICLES.

CONSTRUCTION SPECIFICATIONS - THE AREA OF THE ENTRANCE SHOULD BE CLEARED OF ALL VEGETATION, ROOTS, AND OTHER OBJECTIONABLE MATERIAL. THE GRAVEL SHALL BE PLACED TO THE SPECIFIED DIMENSIONS. ANY DRAINAGE FACILITIES REQUIRED BECAUSE OF WASHING SHOULD BE CONSTRUCTED ACCORDING TO SPECIFICATIONS. IF WASH RACKS ARE USED, THEY SHOULD BE INSTALLED ACCORDING TO MANUFACTURER'S SPECIFICATIONS.

MAINTENANCE - THE ENTRANCE SHALL BE MAINTAINED IN A CONDITION WHICH WILL PREVENT TRACKING OR FLOW OF MUD ONTO PUBLIC RIGHTS-OF-WAY. THIS MAY REQUIRE PERIODIC TOP DRESSING WITH 2 INCH STONE, AS CONDITIONS DEMAND, AND REPAIR AND/OR CLEANST OF ANY STRUCTURES USED TO TRAP SEDIMENT. ALL MATERIALS SPILLED, DROPPED, WASHED, OR TRACKED FROM VEHICLES ONTO ROADWAYS OR INTO STORM DRAINS MUST BE REMOVED IMMEDIATELY.

REVISIONS:

PROJECT #: 25264.00
 DATE: AUGUST 29, 2018
 DRAWN BY: CBB
 DESIGNER: GJC
 CHECKED BY: RJP

Pickering
 Pickering Firm, Inc.
 Facility Design - Civil Engineering - Surveying -
 Transportation - Natural / Water Resources
 317 South Church Street
 Jonesboro, AR 72401
 870.336.6663

MCCALLIE BOAT RAMPS AND PKG. LOT (MISSISSIPPI RIVER) (S) MCCALLIE ACCESS DESHA, ARKANSAS



SHEET NUMBER: **C-500**
 SHEET 14 OF 15

DESCRIPTION:
 CONSTRUCTION DETAILS

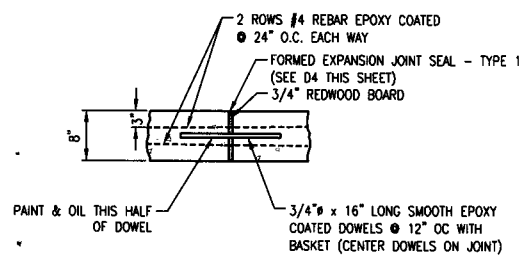

D1 EXPANSION JOINT
NOT TO SCALE

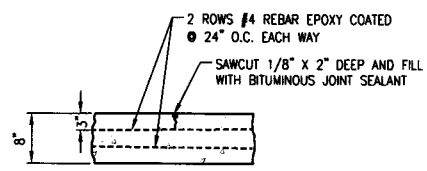

D2 CONTROL JOINT
NOT TO SCALE

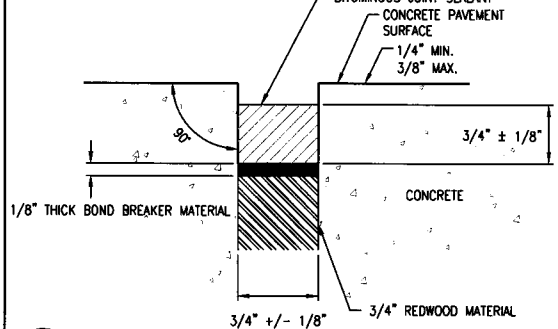

D4 FORMED EXPANSION JOINT SEAL - TYPE 1
NTS

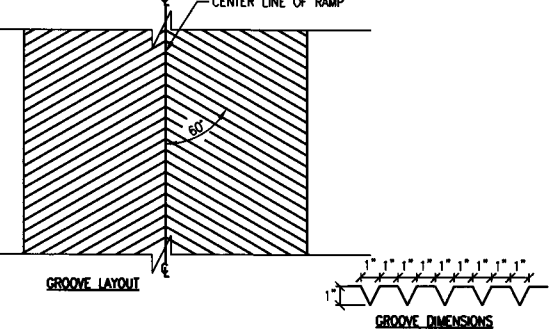

D5 CONCRETE FINISH DETAIL (ENTIRE RAMP)
NOT TO SCALE

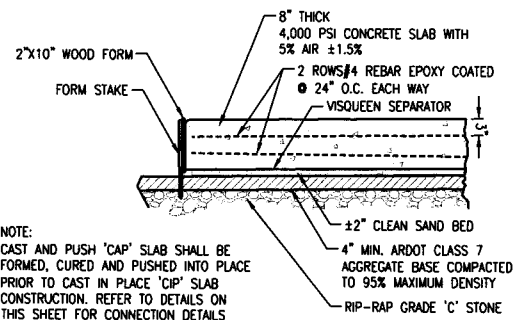

C1 CAST AND PUSH 'CAP' SLAB CONSTRUCTION
NOT TO SCALE

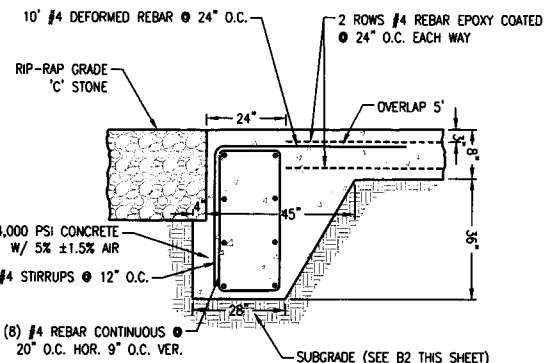

C2 KEY TRENCH ON SIDES OF RAMP
NOT TO SCALE

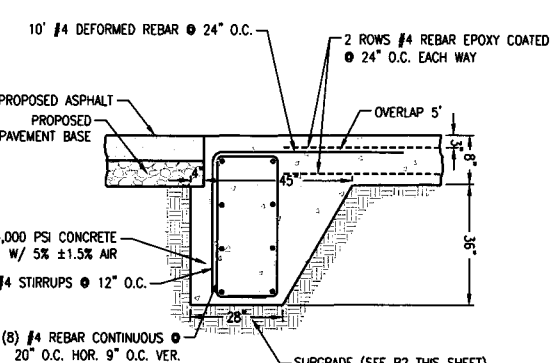

C3 KEY TRENCH AT UPPER END OF RAMP
NOT TO SCALE

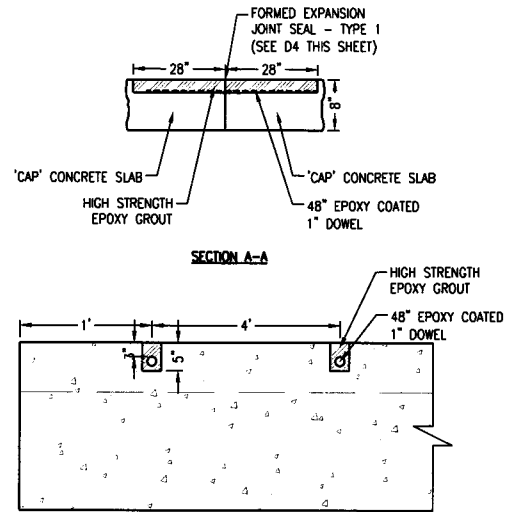

A4 'CAP' TO 'CAP' TIE IN
NOT TO SCALE

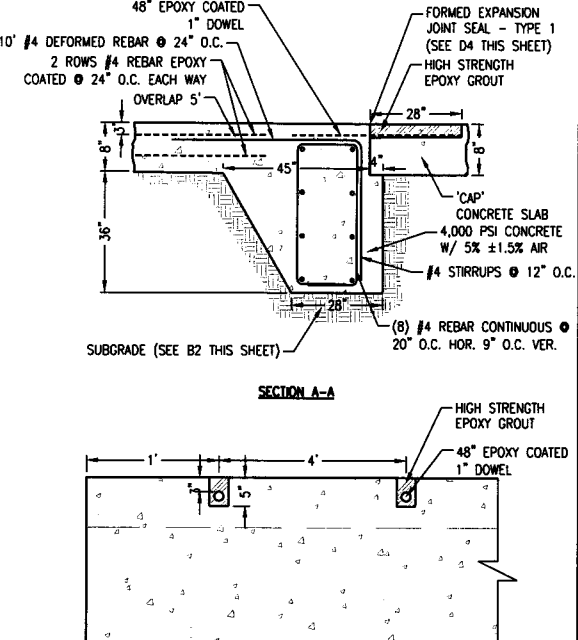

A5 'CAP' TO 'CIP' TIE IN
NOT TO SCALE

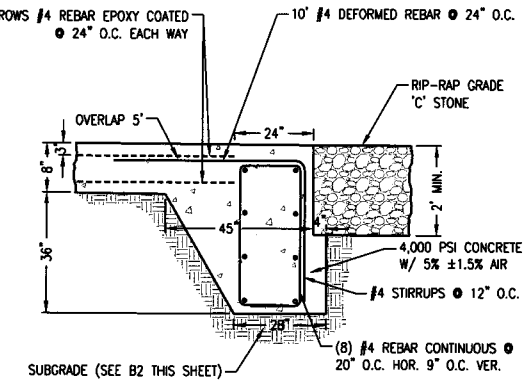

B1 KEY TRENCH AT LOWER END OF RAMP
NOT TO SCALE

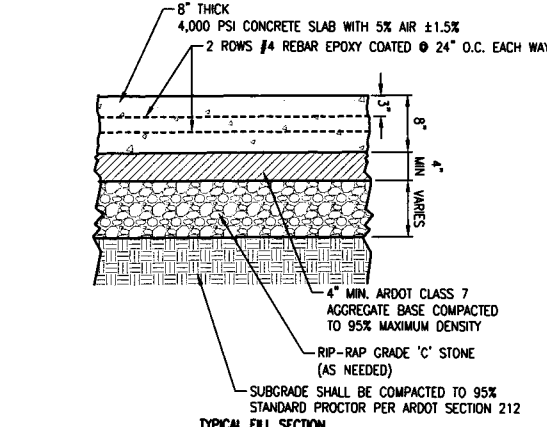

B2 CAST IN PLACE 'CIP' SLAB CONSTRUCTION
NOT TO SCALE

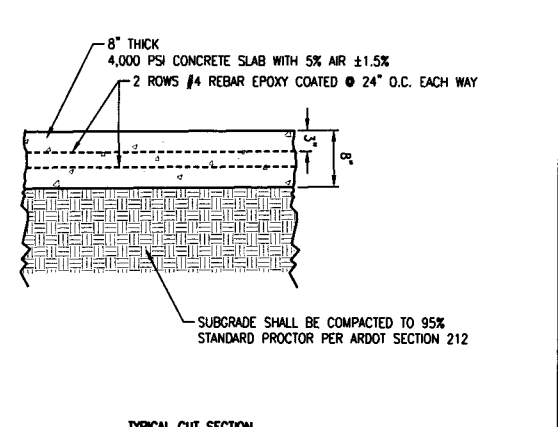

A1 RIP-RAP STONE 'C' GRADING
NOT TO SCALE

STONE SIZE LBS.	INDIVIDUAL WEIGHT RETAINED	INDIVIDUAL % RETAINED	CUMULATIVE % RETAINED	CUMULATIVE % PASSING
400	0	0	0	100
250	5,994	17	17	83
100	6,699	19	36	64
30	5,994	17	53	47
5	7,405	21	74	26
1	5,642	16	90	10
<1/2"	3,526	10	100	0
TOTAL	32,260 lbs.			

- NOTES:
1. GRADATION SHALL BE RUN AT THE QUARRY AND SUBMITTED TO ARDOT FOR REVIEW AND APPROVAL.
2. REFER TO ARDOT HIGHWAY AND CONSTRUCTION MANUAL SECTION 816 FOR ALL CONSTRUCTION REQUIREMENTS.

Cumulative % Finer By Weight	Stone Weight (lbs.)
100	400
70 - 100	250
50 - 80	100
32 - 58	30
15 - 34	5
2 - 20	1
0 - 5	<1/2" max. dia.

NO.	DESCRIPTION

PROJECT #: 25264.00
DATE: AUGUST 29, 2018
DRAWN BY: CBB
DESIGNER: GJC
CHECKED BY: RJP

Pickering
Pickering Firm, Inc.
Facility Design - Civil Engineering - Surveying -
Transportation - Natural / Water Resources
317 South Church Street
Jonesboro, AR 72401
870.336.6663

MCCALLIE BOAT RAMPS AND PKG. LOT (MISSISSIPPI RIVER) (S) MCCALLIE ACCESS DESHA, ARKANSAS

SEAL:
CERTIFICATE OF AUTHORIZATION
PICKERING FIRM, INC.
No. 1329
ARKANSAS

STATE OF ARKANSAS
REGISTERED PROFESSIONAL ENGINEER
No. 10110
ROBERT J. PITTS

SHEET NUMBER:
C-501
SHEET 15 OF 15
DESCRIPTION:
RAMP DETAILS