

DATE REVISED	DATE FILMED	DATE REVISED	DATE FILMED	FED. RD. DIST. NO.	STATE	FED. AID PROJ. NO.	SHEET NO.	TOTAL SHEETS
				6	ARK.			
						JOB NO.	100950	1 57

② HWY. 158/HWY. 163 INTERS. SAFETY IMPVTS. (S)

ARKANSAS DEPARTMENT OF TRANSPORTATION
CONSTRUCTION PLANS FOR STATE HIGHWAY

HWY. 158/HWY. 163 INTERS.
SAFETY IMPVTS. (S)

CRAIGHEAD COUNTY
ROUTE 163 SECTION 5
ROUTE 158 SECTION 5
FED. AID PROJ. NO. HSIP-0016(67)
JOB 100950

NOT TO SCALE

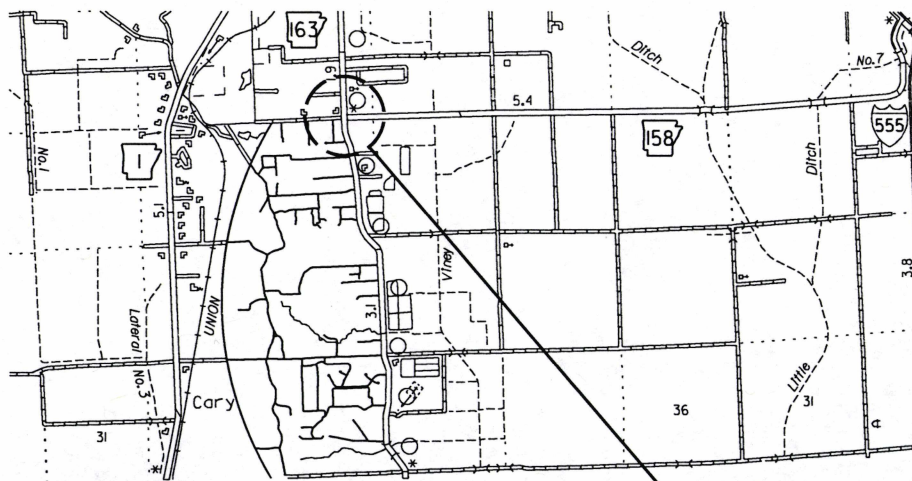

VICINITY MAP

PROJECT LOCATION

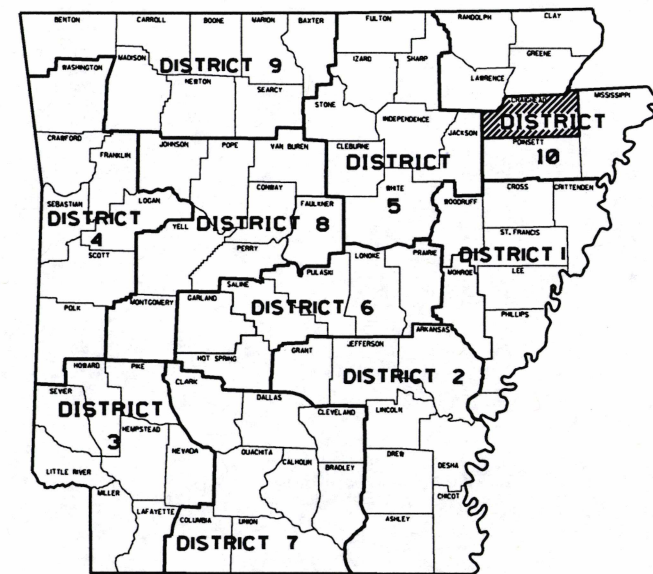

ARKANSAS HIGHWAY DISTRICT 10

• DESIGN TRAFFIC DATA •

DESIGN YEAR	2039
2019 ADT	1700
2039 ADT	2100
2039 DHV	231
DIRECTIONAL DISTRIBUTION	0.60
TRUCKS	9%
DESIGN SPEED	20 MPH

STA. 57+44.00
END JOB 100950
(HWY. 163)

C.L. HWY. 163 STA. 52+20.85 =
C.L. HWY. 158 STA. 111+99.24
 $\angle = 88^\circ 47' 43''$

STA. 106+76.00
BEGIN E. LAWSON RD./HWY. 158

C.L. ROUNDABOUT STA. 10+00.00 =
C.L. ROUNDABOUT STA. 14+64.96 =
C.L. HWY. 163 STA. 51+46.85
 $\angle = 89^\circ 31' 28''$

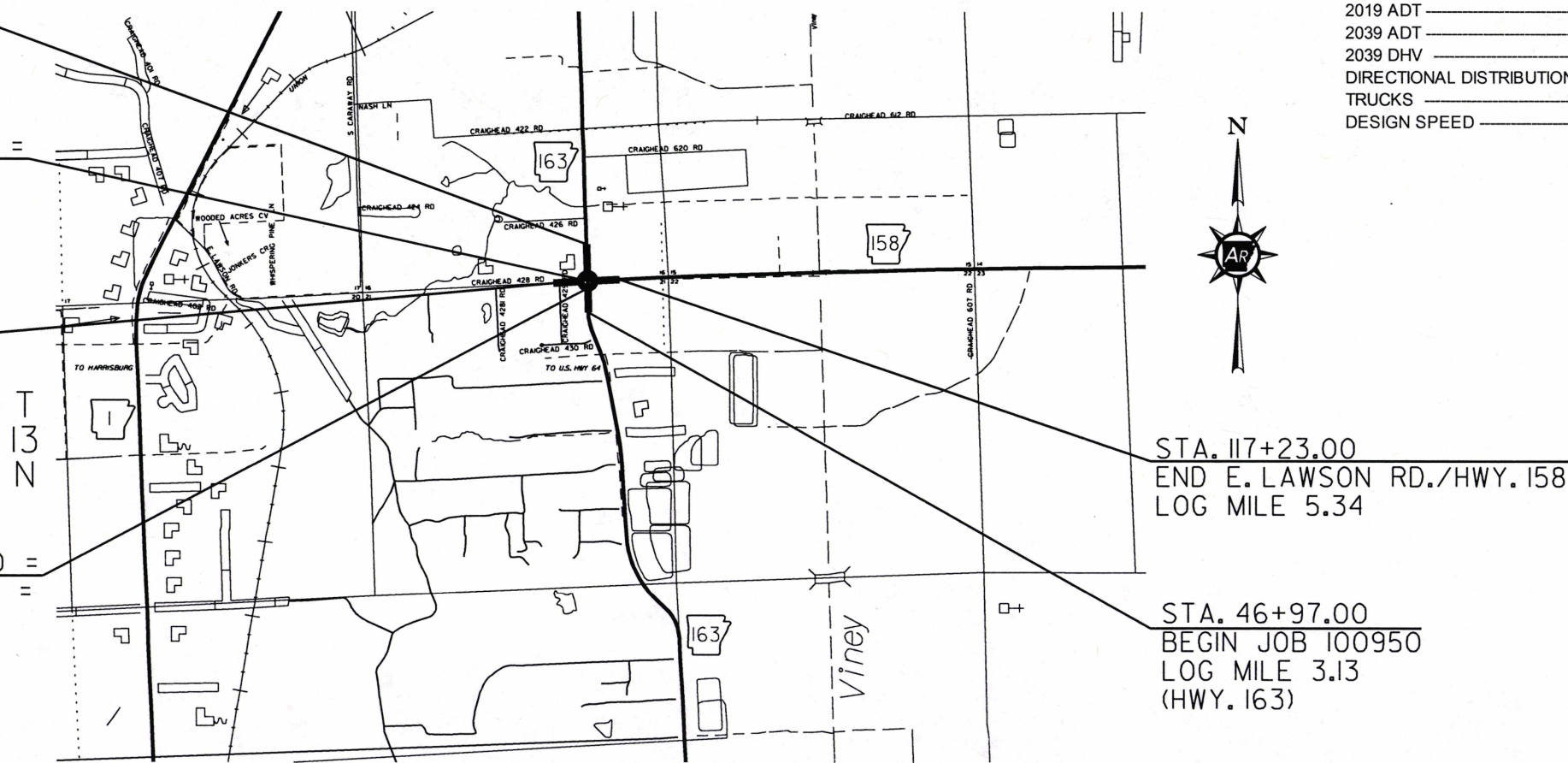

STA. 117+23.00
END E. LAWSON RD./HWY. 158
LOG MILE 5.34

STA. 46+97.00
BEGIN JOB 100950
LOG MILE 3.13
(HWY. 163)

PROJECT COORDINATES:

	BEGIN	MID-POINT	END
LAT.	N35° 44' 50"	N35° 44' 55"	N35° 45' 01"
LON.	W90° 39' 58"	W90° 39' 58"	W90° 39' 57"

GROSS LENGTH OF PROJECT	2094.00 FEET OR	0.397 MILES
NET " " ROADWAY	2094.00 " "	0.397 MILES
NET " " BRIDGE	0.00 " "	0.000 MILES
NET " " PROJECT	2094.00 " "	0.397 MILES

APPROVED



1-8-19
DEPUTY DIRECTOR
AND CHIEF ENGINEER

DATE REVISED	DATE FILMED	DATE REVISED	DATE FILMED	FED. RD. DIST. NO.	STATE	FED. AID PROJ. NO.	SHEET NO.	TOTAL SHEETS
				6	ARK.			
				JOB NO.	100950		2	57

② INDEX OF SHEETS AND STANDARD DRAWINGS



INDEX OF SHEETS

SHEET NO.	TITLE
1	TITLE SHEET
2	INDEX OF SHEETS AND STANDARD DRAWINGS
3	GOVERNING SPECIFICATIONS AND GENERAL NOTES
4	TYPICAL SECTIONS OF IMPROVEMENT
5 - 10	SPECIAL DETAILS
11 - 13	TEMPORARY EROSION CONTROL DETAILS
14 - 17	MAINTENANCE OF TRAFFIC DETAILS
18 - 19	PERMANENT PAVEMENT MARKING DETAILS
20 - 24	QUANTITIES
25	SUMMARY OF QUANTITIES AND REVISIONS
26 - 29	SURVEY CONTROL DETAILS
30 - 34	PLAN AND PROFILE SHEETS
35	ILLUMINATION GENERAL NOTES
36	ILLUMINATION QUANTITIES AND SCHEDULE
37	ILLUMINATION LAYOUT
38	LUMINAIRE POLE DETAILS
39	PULL BOX DETAILS
40	WIRING DIAGRAM
41 - 57	CROSS SECTIONS

NOTE: CROSS SECTIONS NOT NORMALLY INCLUDED IN PLANS SOLD TO PROSPECTIVE BIDDERS, BUT MAY BE HAD UPON REQUEST.

ROADWAY STANDARD DRAWINGS

DRWG.NO.	TITLE	DATE
CDP-1	CONCRETE DITCH PAVING	12-08-16
CG-1	CURBING DETAILS	11-29-07
CPTJ-6A	TRANSVERSE & LONGITUDINAL JOINTS FOR CONCRETE PAVEMENT (NON-REINFORCED)	11-07-19
DR-1	DETAILS OF DRIVEWAYS & ISLANDS	11-07-19
FES-1	FLARED END SECTION	10-18-96
FES-2	FLARED END SECTION	10-18-96
FPC-9	DETAILS OF DROP INLETS & JUNCTION BOXES	11-16-01
FPC-9E	DETAILS OF DROP INLETS (TYPE C)	08-22-02
FPC-9M	DETAILS OF DROP INLET (TYPE MO)	08-22-02
MB-1	MAILBOX DETAILS	11-18-04
PCC-1	CONCRETE PIPE CULVERT FILL HEIGHTS & BEDDING	02-27-14
PCM-1	METAL PIPE CULVERT FILL HEIGHTS & BEDDING	02-27-14
PCP-1	PLASTIC PIPE CULVERT (HIGH DENSITY POLYETHYLENE)	02-27-14
PCP-2	PLASTIC PIPE CULVERT (PVC F949)	02-27-14
PCP-3	PLASTIC PIPE CULVERT (POLYPROPYLENE)	11-07-19
PM-1	PAVEMENT MARKING DETAILS	06-01-17
PU-1	DETAILS OF PIPE UNDERDRAIN	12-08-16
SI-1	DETAILS OF SPECIAL ITEMS	10-25-18
TC-1	STANDARD TRAFFIC CONTROLS FOR HIGHWAY CONSTRUCTION	11-07-19
TC-2	STANDARD TRAFFIC CONTROLS FOR HIGHWAY CONSTRUCTION	11-07-19
TC-3	STANDARD TRAFFIC CONTROLS FOR HIGHWAY CONSTRUCTION	11-07-19
TEC-1	TEMPORARY EROSION CONTROL DEVICES	11-16-17
TEC-2	TEMPORARY EROSION CONTROL DEVICES	06-02-94
TEC-3	TEMPORARY EROSION CONTROL DEVICES	11-03-94
WF-4	WIRE FENCE TYPE C AND D	08-22-02

1/6/2020

R100950.DGN