

ARKANSAS DEPARTMENT OF TRANSPORTATION  
CONSTRUCTION PLANS FOR STATE HIGHWAY

DATE REVISED	DATE FILED	DATE REVISED	DATE FILED	FED. RD. DIST. NO.	STATE	FED. AID PROJ. NO.	SHEET NO.	TOTAL SHEETS
				6	ARK.			
						JOB NO. 110646	1	48
② CYPRESS CREEK & CANAL STRS. & APPRS. (S)								

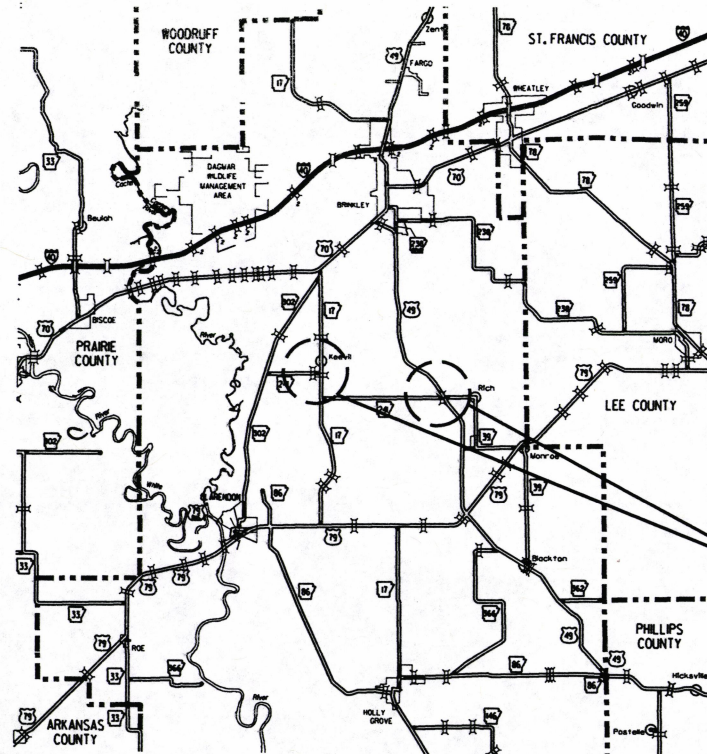

VICINITY MAP

# CYPRESS CREEK & CANAL STRS. & APPRS. (S)

MONROE COUNTY  
ROUTE 241 SECTIONS 1 & 2

FEDERAL AID PROJ. NHPP-0048(27)

## JOB 110646

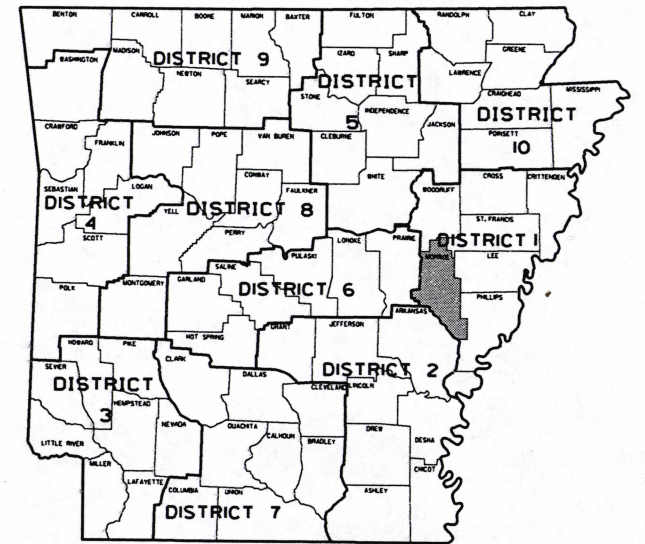

ARK. HWY. DIST. NO. 1

STA. III+00.00  
END SITE 1

NOT TO SCALE

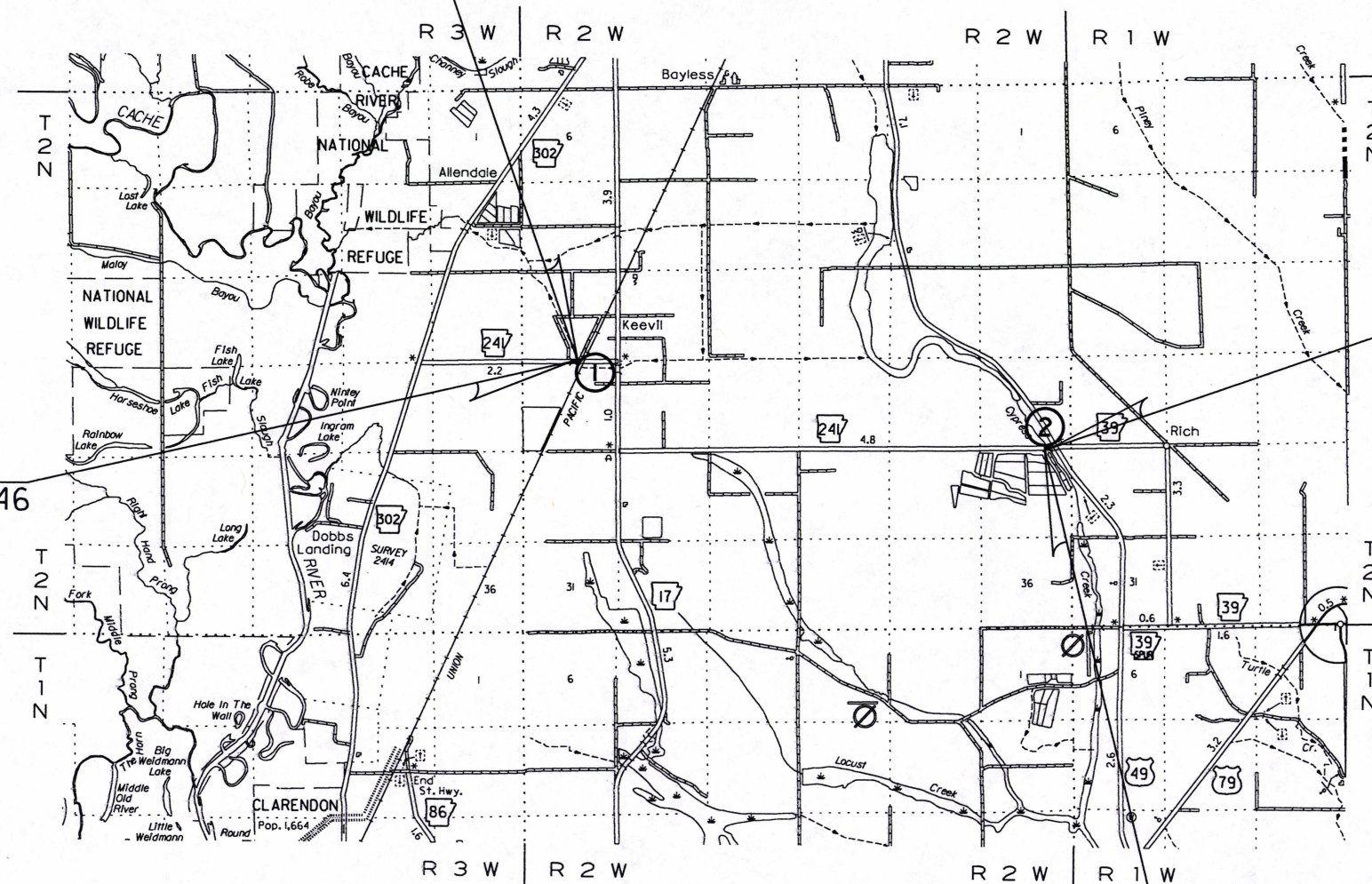

DESIGN TRAFFIC DATA

	SITE 1	SITE 2
DESIGN YEAR.....	2038	2038
2018 ADT.....	50	300
2038 ADT.....	60	340
2038 DHV.....	7	37
DIRECTIONAL DISTRIBUTION.....	0.60	0.60
TRUCKS.....	15%	15%
AVERAGE RUNNING SPEED.....	54 MPH	56 MPH

STA. 214+10.77  
END SITE 2  
END JOB 110646

STA. 110+00.00  
BEGIN JOB 110646  
BEGIN SITE 1  
LOG MILE 1.76

STA. 206+83.56  
BEGIN SITE 2  
LOG MILE 4.73

STRUCTURES OVER 20'-0" SPAN

- ① STA. 110+53 CONSTRUCT QUINT. 8' X 4' X 48" R.C. BOX CULVERT WITH 3:1 WINGS LT. & RT. Q25 = 500 CFS D.A. = 1.2 SQ. MI. SPAN = 43'-8"
- ② STA. 210+48 CONSTRUCT QUINT. 10' X 5' X 48" R.C. BOX CULVERT WITH 3:1 WINGS LT. & RT. Q25 = 1260 CFS D.A. = 20.5 SQ. MI. SPAN = 53'-8"

	BEGIN SITE 1	MID-POINT OF SITE 1	END SITE 1
LATITUDE	N 34°46' 51"	N 34°46' 51"	N 34°46' 51"
LONGITUDE	W 91°15' 08"	W 91°15' 08"	W 91°15' 07"
	BEGIN SITE 2	MID-POINT OF SITE 2	END SITE 2
LATITUDE	N 34°45' 53"	N 34°45' 53"	N 34°45' 53"
LONGITUDE	W 91°09' 43"	W 91°09' 37"	W 91°09' 33"

LENGTH OF PROJECT CALCULATED ALONG C.L.

GROSS LENGTH OF PROJECT	827.21	FEET	OR	0.157	MILES
NET ROADWAY	729.87			0.138	MILES
NET BRIDGES	97.34			0.019	MILES
NET PROJECT	827.21			0.157	MILES



APPROVED

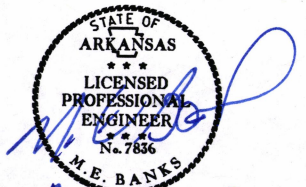

8-31-18  
DEPUTY DIRECTOR  
AND CHIEF ENGINEER