

- LEGEND**
- COUNTY BOUNDARY
 - U.S. LAND TOWNSHIP LINE
 - SECTION LINE
 - NATIONAL FOREST BOUNDARY
 - PAVED STATE OR U.S. HIGHWAY
 - STATE HIGHWAY
 - PAVED LOCAL ROAD
 - GRAVEL LOCAL ROAD
 - GRADED & DRAINED LOCAL ROAD
 - UNIMPROVED LOCAL ROAD
 - RAILROAD
 - RAILROAD STATION
 - GRADE CROSSING
 - OVERPASS
 - UNDERPASS
 - HIGHWAY BRIDGE
 - PAVED FORD OR LOW WATER BRIDGE
 - MILEAGE BETWEEN POINTS
 - LAKE, RESERVOIR OR POND
 - LAKE, RESERVOIR OR POND WITH DAM
 - WIDE RIVER OR STREAM
 - DOCK, PIER OR LANDING
 - NAVIGABLE STREAM
 - SMALL STREAM
 - DRAINAGE DITCH
 - CORPORATE LIMITS AND ROADS THROUGH TOWN
 - COUNTY SEAT
 - OTHER CITIES AND TOWNS
 - MINE, SHAFT OR DRIFT
 - ORE MILL OR REPRODUCTION PLANT
 - MUNICIPAL AIRPORT
 - PRIVATE AIRFIELD
 - FARM UNIT OR DWELLING
 - GROUP OF CLOSELY SPACED DWELLINGS
 - CHURCH OR OTHER RELIGIOUS INSTITUTION
 - SCHOOL
 - POST OFFICE
 - POST OFFICE AND BUSINESS
 - CEMETERY
 - CHURCH WITH CEMETERY ADJACENT
 - BUSINESS ESTABLISHMENT
 - FACTORY OR INDUSTRIAL PLANT
 - SAWMILL
 - GRAVEL PIT
 - QUARRY
 - COUNTY OR STATE PRISON
 - RADIO OR TELEVISION STATION AND CALL LETTERS
 - POWER SUBSTATION
 - TRAILER PARK
 - PUMPING STATION, OIL OR GAS
 - HISTORICAL MONUMENT
 - CAMP OR LODGE
 - SMALL PARK
 - WATER SUPPLY STANDPIPE OR TANK
 - SEWAGE DISPOSAL PLANT
 - AUTO SALVAGE YARD
 - RODEO ARENA
 - CHICKEN HOUSE
 - SCENIC HIGHWAY

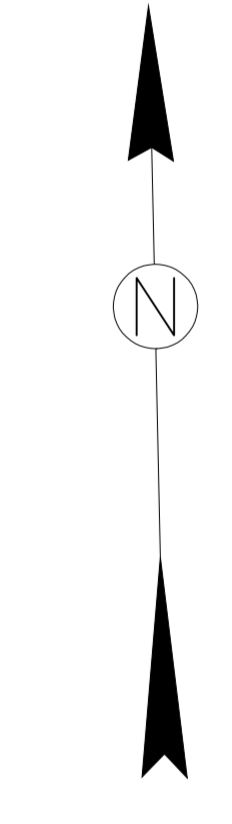

GENERAL HIGHWAY MAP
IZARD COUNTY
 ARKANSAS

PREPARED BY
 ARKANSAS STATE HIGHWAY AND TRANSPORTATION DEPARTMENT
 PLANNING AND RESEARCH DIVISION
 IN COOPERATION WITH
 U.S. DEPARTMENT OF TRANSPORTATION
 FEDERAL HIGHWAY ADMINISTRATION

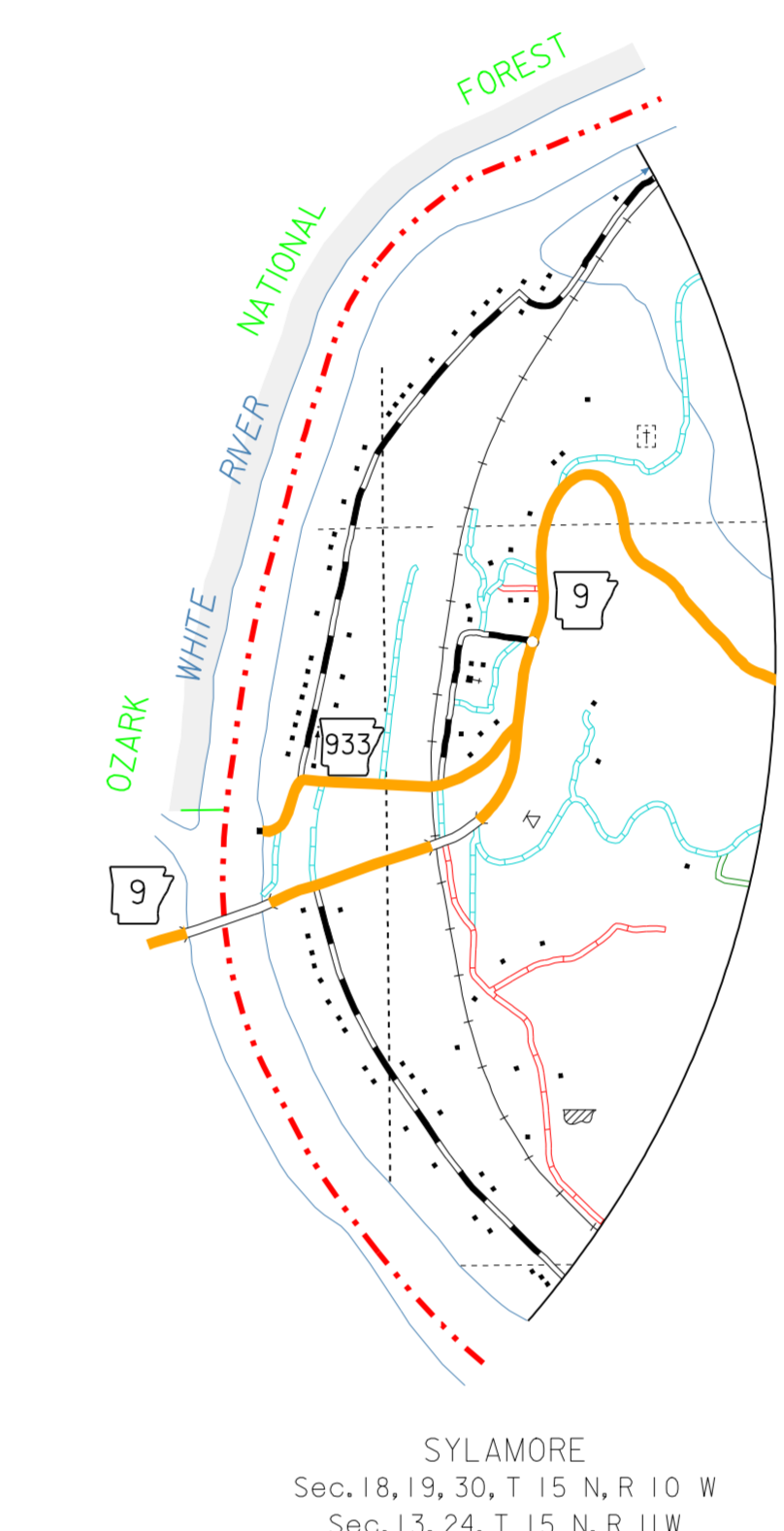
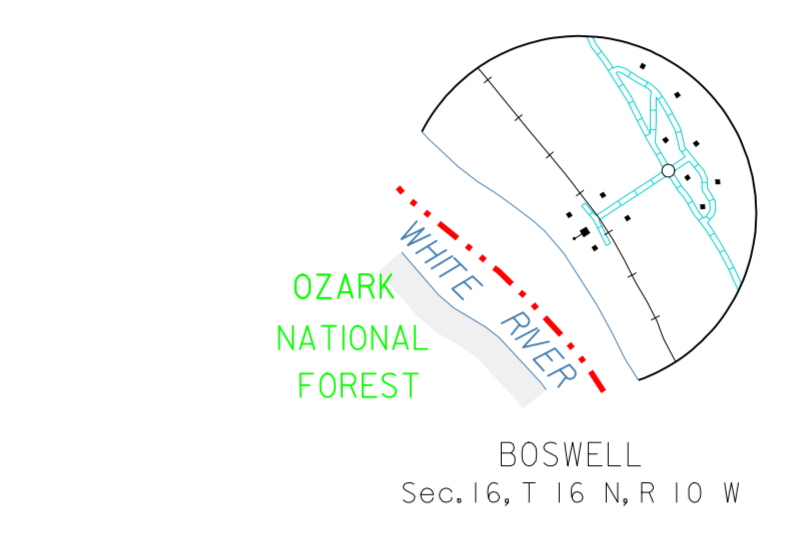
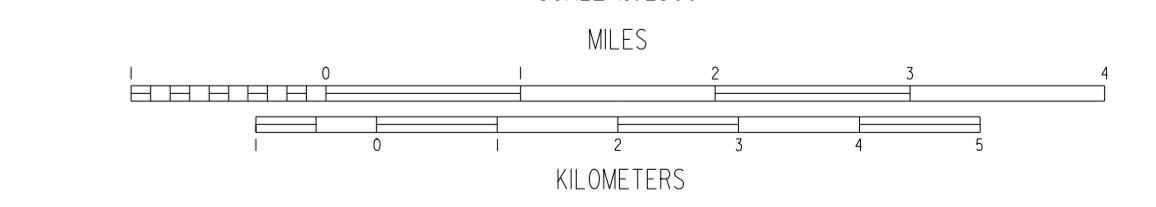

NOTE: Enlargements of all congested areas are five times map scale unless otherwise noted.
 Individual maps are available for all active incorporated cities.
 Area: 584 square miles
 Population: 26,848 (2000 Census)
 Map Issued 7-18-03, redlines map issued 5-17-96
 Field Inventory 1976
 Map revisions made from aerial photographs taken 1-08-02
 Map completion completed 1976
 County map produced using Computer Assisted Cartography
 Map revised 11-29-02 Redlighting of Hwy. 9 north of Melbourne, Ark.

Copies of this map are available at a nominal fee from the Arkansas State Highway and Transportation Department, P.O. Box 220-111 He Rock, Ark. 72203

